



## Woodmill Road, E5

### £400,000

A one double bedroom top floor apartment measuring just shy of 600sq ft with a full length private balcony. Set within a modern development the property benefits from an open plan kitchen/living room with dual aspect, lift access and a communal roof terrace with far reaching views.

Bellevalia Court is located on a quiet road on the edge of North Millfields and the River Lea. The apartment is just over half a mile to Clapton Overground Station offering direct trains into transport hub Liverpool Street. It is also within walking distance to Chatsworth Road with its Sunday market and many shops and cafes.

### Features

- One Double Bedroom
- Top Floor
- Lift Access
- Private Balcony
- Open Plan
- Communal Roof Terrace

# Woodmill Road, Clapton, E5

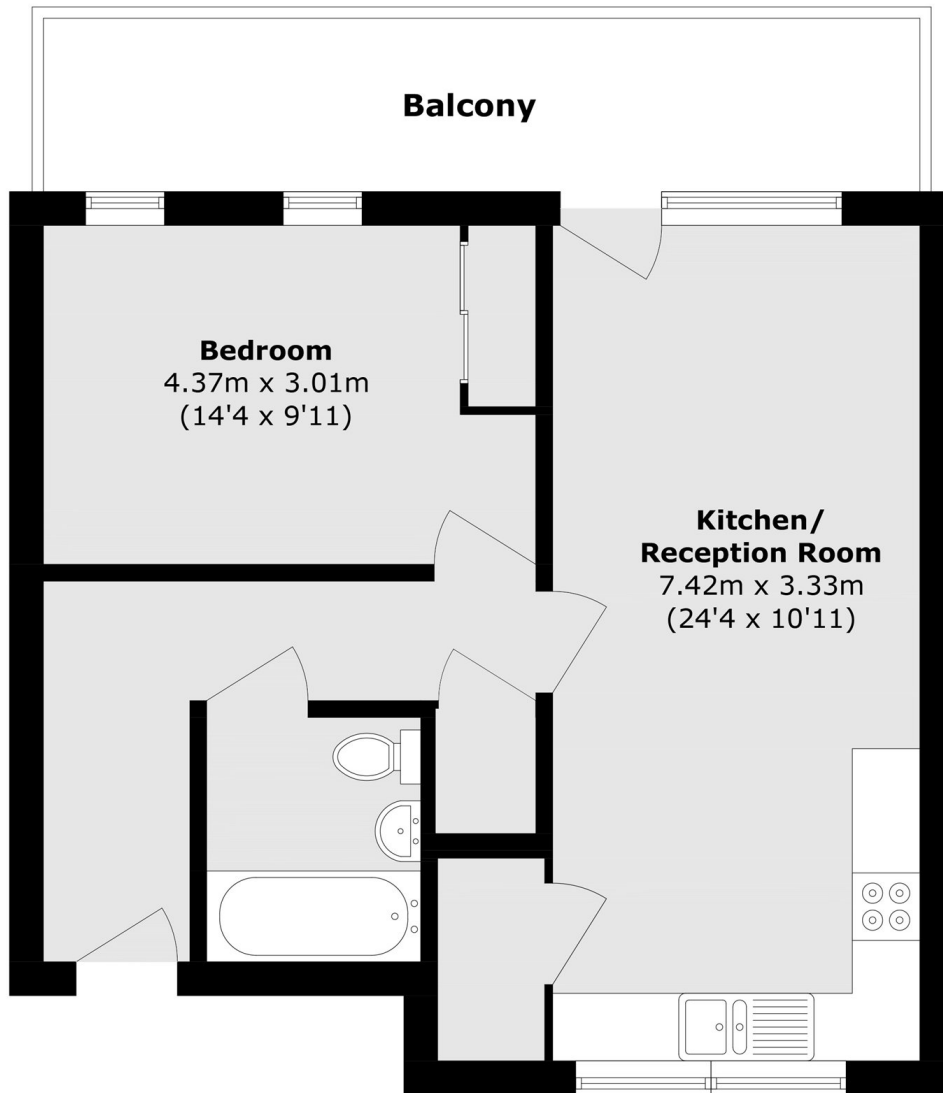

Total area (approx.): 54.6 sq. m (587.7 sq. ft)  
Balcony (approx.): 11.9 sq. m (128.0 sq. ft)