



**5 Priory House, Priory Road, Shrewsbury, SY1 1RU**

2 bedroom apartment — £220,000 Leasehold

# 5 Priory House, Priory Road, Shrewsbury, SY1 1RU

Coopergreenpooks.co.uk

£220,000 Leasehold — 2 bedroom apartment

sales@cgpooks.co.uk

Occupying a superb position with a lovely outlook over the Quarry Park, this individually designed first floor apartment forms part of an imposing Grade II Listed building of character within the centre of town, approached by attractive communal gardens.

## KEY FEATURES

- Well-maintained communal entrance and turning staircase to the first floor
- Private inner hallway with useful storage
- Open plan living/dining area with windows to two elevations and views over the Quarry Park and towards the River Severn
- Well-fitted kitchen, complete with integrated appliances
- Two bedrooms, both having built-in wardrobes, and a separate family bathroom with shower
- Feature sash windows and modern electric heating
- Landscaped communal gardens to front
- A superb location within the centre of the town, a stone's throw from excellent amenities, bars and restaurants, and main shopping areas
- A private parking space may be available on a rental basis via separate negotiation

Cooper Green Pooks

3 Barker Street

Shrewsbury

SY1 1QF

www.cgpooks.co.uk

sales@cgpooks.co.uk

01743 276666



## First Floor

Approx. 50.8 sq. metres (546.9 sq. feet)

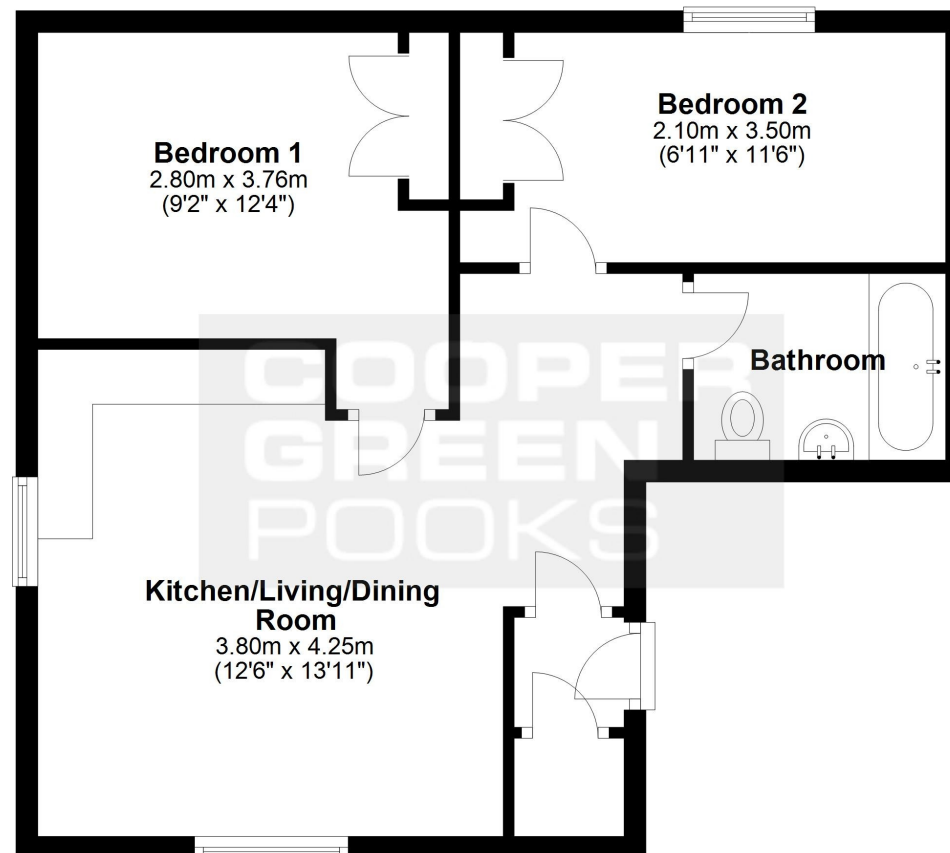

Total area: approx. 50.8 sq. metres (546.9 sq. feet)

We accept no responsibility for any mistake or inaccuracy contained within the floorplan. The floorplan is provided as a guide only and should be taken as an illustration only. The measurements, contents and positioning are approximations only and provided as a guidance tool and not an exact replication of the property.  
Plan produced using PlanUp.





# 5 Priory House, Priory Road, Shrewsbury, SY1 1RU

Coopergreenpooks.co.uk

£220,000 Leasehold — 2 bedroom apartment

sales@cgpooks.co.uk



Cooper Green Pooks  
3 Barker Street  
Shrewsbury  
SY1 1QF

www.cgpooks.co.uk  
sales@cgpooks.co.uk  
01743 276666

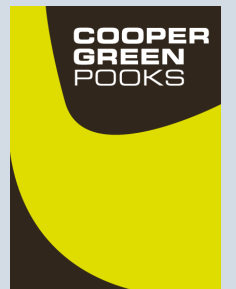

# 5 Priory House, Priory Road, Shrewsbury, SY1 1RU

£220,000 Leasehold — 2 bedroom apartment

sales@cgpooks.co.uk

rightmove

onTheMarket.com

RICS  
Regulated by RICS



**BOUNDARIES NOT CONFIRMED**

Local Authority	<b>Shropshire Council</b>
Council Tax	<b>Band C</b>
EPC Band	<b>Band E</b>
Services	<b>Mains water, electricity and drainage are connected. Electric heating.</b>

Tenure	<b>Leasehold</b>
Lease Length	<b>199 years from 2018</b>
Service Charge	<b>£1,800 per annum (includes Ground Rent)</b>

# 5 Priory House, Priory Road, Shrewsbury, SY1 1RU

Coopergreenpooks.co.uk

£220,000 Leasehold — 2 bedroom apartment

sales@cgpooks.co.uk



**IMPORTANT NOTICE:** Cooper Green Pooks for themselves and for the lessors or vendors of this property whose agents they are give notice that: 1 No appliances, services or service installations have been tested and no warranty as to suitability or serviceability is implied. Any prospective purchaser or lessee is advised to obtain verification from their surveyor or solicitor. 2. The particulars are set out as a general outline only for the guidance of the intended purchasers or lessees and do not constitute, nor constitute part of, an offer or contract. 3. All descriptions, reference to condition and necessary permissions for use and occupation and other details are given in good faith and are believed to be correct but any intending purchasers or lessees should not rely on them as statements or representation of fact but satisfy themselves by inspection or otherwise as to the correctness of each of them. 4. No person in the employment of Cooper Green Pooks has any authority to make or give any representation or warranty whatsoever in relation to this property. 5. All rentals and prices are quoted exclusive of Stamp Duty, legal and surveyors fees and any other associated purchasers or lessees costs. 6. Floor plans are indicative only and should not be relied on. 7. The plan showing the boundary of the property is indicative only and has not been checked against the legal title so should not be relied on. 8. All dimensions, floor areas and site areas are only approximate and should not be relied on. Dimensions are generally maximum room dimension.