



Red Rose Gardens, Sale
£65,000



HIBBERT
HOMES

SALES & LETTINGS

Red Rose Gardens

Sale

This charming self-contained maisonette comes well-presented throughout and ready for occupation. With its own private entrance, the property forms part of a lovely retirement development for the over-60's, offering independent living on a 50% shared ownership basis (ownership can be staircased up to 75%).

Situated in a great location within a short walk of Sale Town Centre, residents enjoy easy access to all local amenities, including Sale's shops, cafés and restaurants. There are also fantastic transport links with bus routes and Sale Metrolink station, as well as the M60 motorway just a few minutes' drive.

The property itself offers great space, with a generous living dining room, separate kitchen and large double bedroom, allowing for ample furniture and with plenty of built-in storage. The development is set in attractive grounds, with a communal car park providing allocated off-road parking plus visitors' spaces.





- NO ONWARDS CHAIN
- 50% shared ownership (can be staircased to 75%)
- Charming maisonette in development for the over 60's
- Self-contained with own private entrance
- Generous living dining room with separate kitchen
- Short walk to Sale Town Centre and all local amenities
- Beautiful communal gardens
- Off-road parking in communal car park

Council Tax band: A

Tenure: Leasehold

EPC Energy Efficiency Rating: C

EPC Environmental Impact Rating:



Approx Gross Internal Area
42 sq m / 454 sq ft

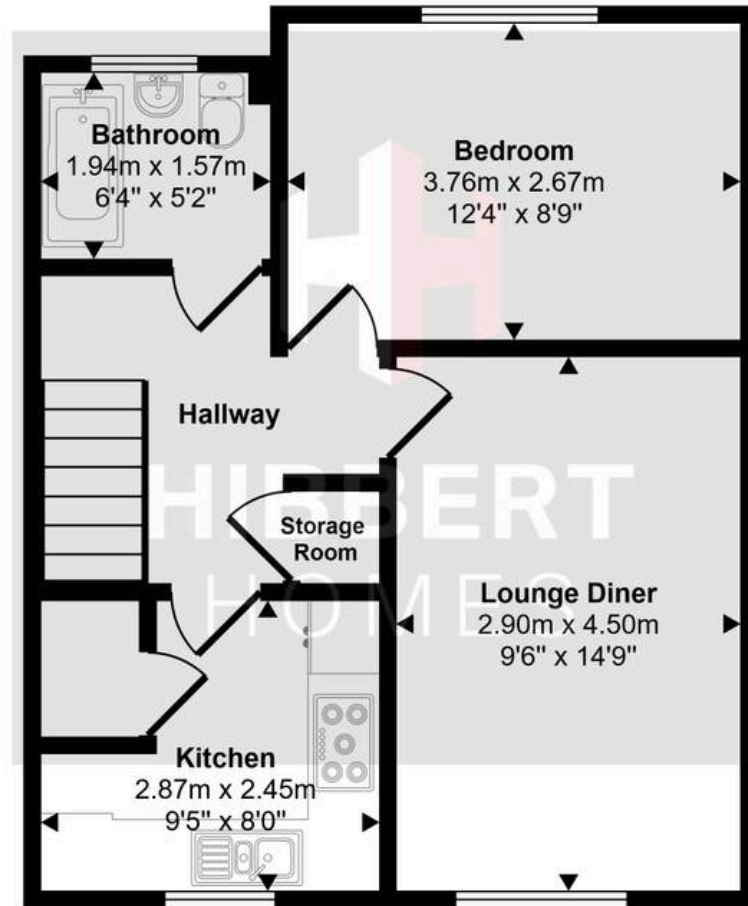

Floorplan

This floorplan is only for illustrative purposes and is not to scale. Measurements of rooms, doors, windows, and any items are approximate and no responsibility is taken for any error, omission or mis-statement. Icons of items such as bathroom suites are representations only and may not look like the real items. Made with Made Snappy 360.

