



Parkways | Oulton | LS26 8TX

£550,000

Four bedroom detached bungalow | Council Tax Band E | EPC Rating C

Emsleys | estate agents

*****EXCEPTIONAL HOME. LARGE PLOT. TUCKED AWAY CUL DE SAC POSITION. UPDATED KITCHEN & BATHROOMS. *****

Found hidden away in the serene area of Parkways, Oulton, Leeds, this charming detached bungalow offers a perfect blend of comfort and modern living. With four spacious bedrooms, this property is ideal for families seeking a peaceful retreat while still being close to local amenities.

Upon entering, you will find three inviting reception rooms, providing ample space for relaxation and entertaining guests. The updated kitchen is a highlight, featuring contemporary fittings that make cooking a delight. The two modern bathrooms ensure convenience for all residents and visitors alike.

Set on a large plot, this bungalow enjoys a tucked-away position, offering a sense of privacy and tranquillity. The generous outdoor space is perfect for gardening enthusiasts or for children to play safely. Additionally, the property boasts parking for up to five vehicles, with four on the drive and a single integral garage, making it an excellent choice for families with multiple cars or for those who enjoy hosting gatherings.

This delightful home in Oulton is not just a property; it is a lifestyle choice, combining spacious living with the charm of a quiet neighbourhood. Whether you are looking to settle down or seeking a peaceful retreat, this bungalow is a must-see. Call now to arrange your viewing.





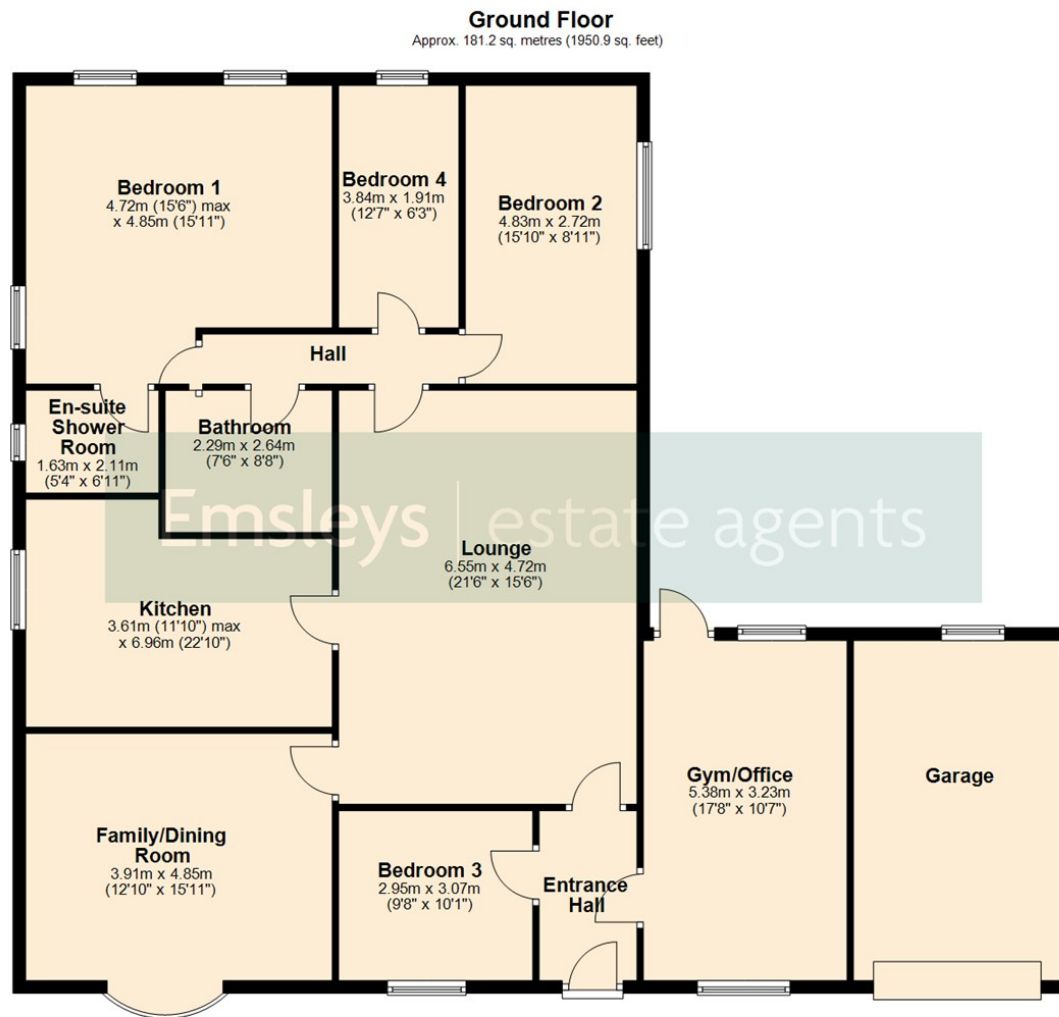

Total area: approx. 181.2 sq. metres (1950.9 sq. feet)

These details are for guidance only and complete accuracy cannot be guaranteed. If there is any point, which is of particular importance, verification should be obtained. They do not constitute a contract or part of a contract. All measurements are approximate. No guarantee can be given with regard to planning permissions or fitness for purpose. No apparatus, equipment, fixture or fitting has been tested. Items shown in photographs are NOT necessarily included. Interested Parties are advised to check availability and make an appointment to view before travelling to see a property.



65 Commercial Street | Rothwell | Leeds | LS26 0QD
t: 0113 201 4040 www.emsleysestateagents.co.uk

Emsleys | estate agents