



TO LET



96 Whitehall Waterfront Riverside Way, Leeds, West Yorkshire, LS1 4EF

£1,100 PCM

**SW**  
RESIDENTIAL

- Popular Riverside Location
- Two Bedrooms
- Two Bathrooms
- Open Plan Living / Dining Area
- Balcony
- Furnished
- Fifth Floor Apartments
- Available Mid February
- Council Tax Band D

## THE PROPERTY

A spacious two bedroom apartment situated on the fifth floor of this popular riverside development. Located within easy walking distance of Leeds train station along with all the amenities the City Centre has to offer. Recently redecorated throughout.

The accommodation comprises spacious open plan living/dining area and contemporary kitchen with access to good size balcony with an Easterly aspect. Two double bedrooms with en-suite shower room to master bedroom and also main house bathroom. The property is available to rent furnished and is available mid February.

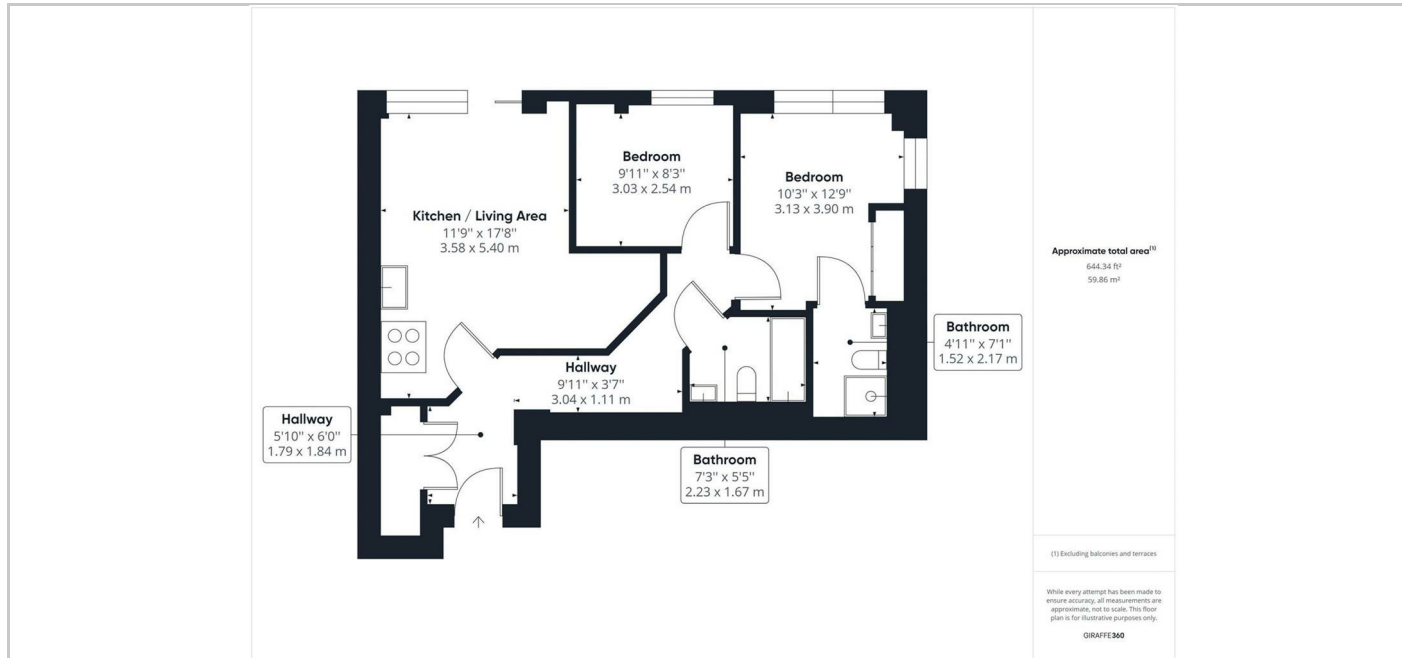

## SITUATION

## Directions

6th Floor Central Square, 29 Wellington Street, West Yorkshire, LS1 4DL  
Tel: 0113 221 6000 Email: residential@sw.co.uk