

shepherds  
A better home  
moving experience



124 The Avenue

Bengeo, SG14 3DX

**Guide Price £600,000**

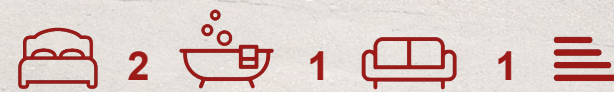

## 124 The Avenue

Bengeo, SG14 3DX

**SOLD BY SHEPHERDS - Chain Free -** Situated on one of Bengeo's most sought-after roads, this well-presented two-bedroom semi-detached bungalow offers a fantastic opportunity for buyers looking for a home with both immediate comfort and future potential. The property benefits from a modern kitchen, a generous south-facing garden, and a thoughtfully converted garage now serving as a useful home office.

The accommodation is well laid out, with an entrance hallway leading through to a spacious living/dining room with French doors opening directly onto the garden. The kitchen has been updated in recent years and is finished in a clean, modern style.

There are two well-proportioned bedrooms, including a good-sized main bedroom with built-in wardrobes, along with a second bedroom that works well as a guest room or study. The property is served by a family bathroom with a walk-in shower.

Externally, the south-facing garden is a real highlight, offering a good amount of space and sun throughout the day.

Offered to the market chain free, the bungalow also provides clear potential to extend, subject to the usual planning permissions.





- Two-bedroom semi-detached bungalow
- Located on one of Bengeo's most sought-after roads
- Chain free sale
- Good-sized south-facing rear garden
- Spacious living/dining room with French doors to garden
- Modern, recently updated kitchen
- Converted garage providing a useful home office
- Main bedroom with built-in wardrobes
- Well-proportioned second bedroom
- Potential to extend, subject to planning permission



## Floor Plan

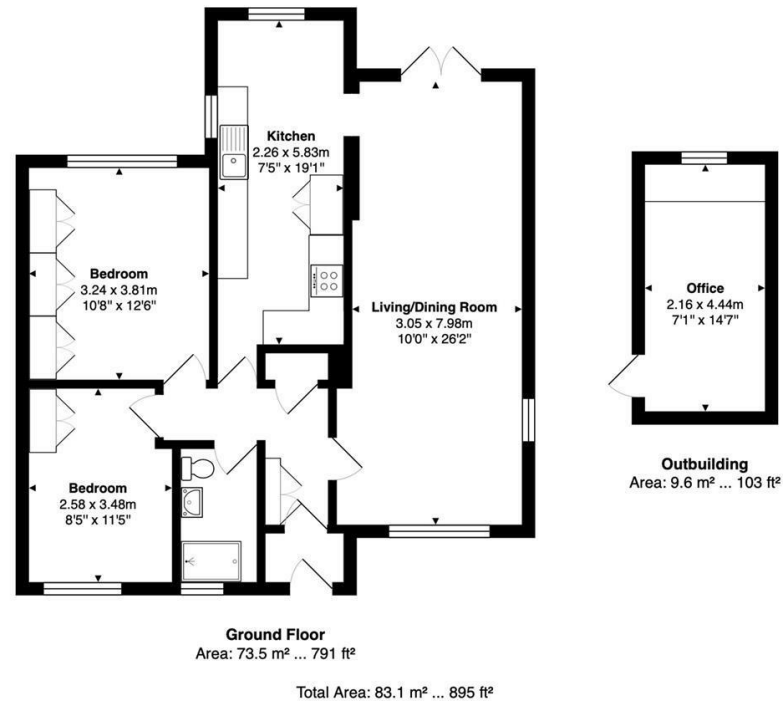

FOR ILLUSTRATIVE PURPOSES ONLY; NOT TO SCALE  
 Whilst every attempt has been made to ensure the accuracy of the floor plan shown, all measurements, positioning, fixtures, features, fittings and any other data shown are an approximate interpretation for illustrative purposes only and are not to scale. No responsibility is taken for any error, omission, miss-statement or use of data shown.  
 Property marketing provided by [www.matthewkyle.co.uk](http://www.matthewkyle.co.uk)

## Viewing

Please contact Shepherds of Hertford on 01992 551955 if you wish to arrange a viewing appointment for this property or require further information.

## Energy Performance Graph

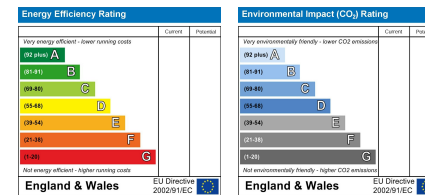

These particulars, whilst believed to be accurate are set out as a general outline only for guidance and do not constitute any part of an offer or contract. Intending purchasers should not rely on them as statements of representation of fact, but must satisfy themselves by inspection or otherwise as to their accuracy. No person in this firm's employment has the authority to make or give any representation or warranty in respect of the property.

Riverside House, 6 Millbridge, Hertford, SG14 1PY  
 Tel: 01992 551955 Email: [enquiries@shepherdsfhertford.co.uk](mailto:enquiries@shepherdsfhertford.co.uk)