

19 Barnfield Drive, Chichester, PO19 6UU

£1,800 Per month

EPC Rating: D Council Tax Band: C



19 Barnfield Drive, Chichester, PO19 6UU

£1,800 Per month

Council Tax Band: C

Well-located four-bedroom house ideal for students or sharers, close to St Richard's Hospital and the city centre. Part furnished with beds and white goods included, plus new carpets upstairs. Spacious kitchen/diner, lounge and private garden. Available From May 2026.

This is a fantastic opportunity to secure a well-located four-bedroom house, ideally suited to students or professional sharers. Positioned just moments from St Richard's Hospital and within easy reach of Chichester city centre, the property offers practical, well-balanced accommodation in a highly convenient setting.

The house is presented in modern neutral décor throughout. On the ground floor, there is an entrance hall leading to a comfortable lounge and a spacious kitchen/diner with access out to a private enclosed rear garden — perfect for shared living. Upstairs, there are four bedrooms, each provided with a single bed, wardrobe and bedside table, making it an ideal base for a group looking to move straight in while still allowing space to add personal touches.

With gas central heating, mains services throughout, and key white goods and furniture included, this is a practical and well-equipped home designed for easy group living. Available from May 2026, this is one not to miss for the next academic year.





### Ground Floor

Approx. 32.8 sq. metres (353.3 sq. feet)



### First Floor

Approx. 32.7 sq. metres (351.7 sq. feet)

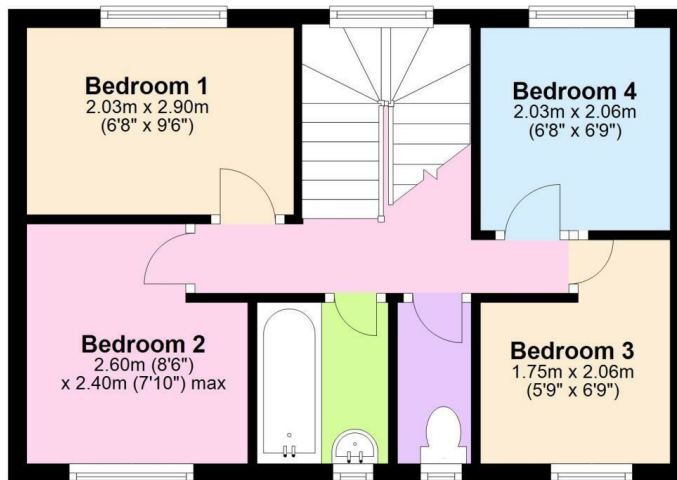

Total area: approx. 65.5 sq. metres (705.0 sq. feet)

The Old Boathouse Bosham Lane

Bosham

West Sussex

PO18 8HS

01243 624637

info@soloestates.co.uk

www.soloestates.co.uk

Energy Efficiency Rating		Current	Potential
Very energy efficient - lower running costs			
(92 plus) <b>A</b>			
(81-91) <b>B</b>			
(69-80) <b>C</b>			
(55-68) <b>D</b>		<b>65</b>	
(39-54) <b>E</b>			
(21-38) <b>F</b>			
(1-20) <b>G</b>			
Not energy efficient - higher running costs			
<b>England &amp; Wales</b>		EU Directive 2002/91/EC	