

# WILKINSON

SALES • LETTINGS • MANAGEMENT

£255,000

Graylag Crescent, Walton Cardiff, GL20



2

Bedrooms



2

Bathrooms

101 High Street, Tewkesbury, Gloucestershire, GL20 5JZ |  
Info@wilkinsonslm.co.uk

01684 367736





- Terrace Home
- Lounge
- Kitchen/Dining Room
- Two Bedrooms
- Bathroom
- Ensuite
- Garage
- UPVC Double Glazing
- Gas Central Heating
- Rear Garden
- NO ONWARD CHAIN

Wilkinson SLM are delighted to offer this two-bedroom terraced home to the market, available with **NO ONWARD CHAIN**, and located on the ever-popular Wheatpieces development in Walton Cardiff.

This home is entered via an entrance hall with stairs rising to the first floor and access to the lounge, which features a fireplace and a door leading through to the kitchen/dining room. The kitchen is fitted with a range of base and wall units and includes a built-in oven and hob, fridge freezer, and space for a dishwasher and washing machine. There is also a useful under-stairs storage cupboard and sliding patio doors opening onto the rear garden.

To the first floor are two bedrooms and a family bathroom. Both bedrooms benefit from built-in wardrobes, with the main bedroom further offering an en-suite shower room. An airing cupboard completes the first-floor accommodation.

To the rear of the property is a low maintenance garden with mature shrubs and a gate that leads to the garage.

This lovely home is further complemented by gas central heating and UPVC double glazing.

**Lounge** 14' 9" x 10' 4" (4.50m x 3.15m)  
Maximum Measurements

**Kitchen/Dining Room** 8' 9" x 13' 5" (2.67m x 4.09m)

**Bedroom One** 11' 5" x 10' 5" (3.48m x 3.17m)  
Maximum Measurements

**Ensuite** 5' 2" x 4' 11" (1.57m x 1.50m)

**Bedroom Two** 9' 10" x 7' 1" (3.00m x 2.16m)

**Bathroom** 6' 2" x 6' 1" (1.88m x 1.85m)

## Ground Floor

Approx. 29.8 sq. metres (320.9 sq. feet)

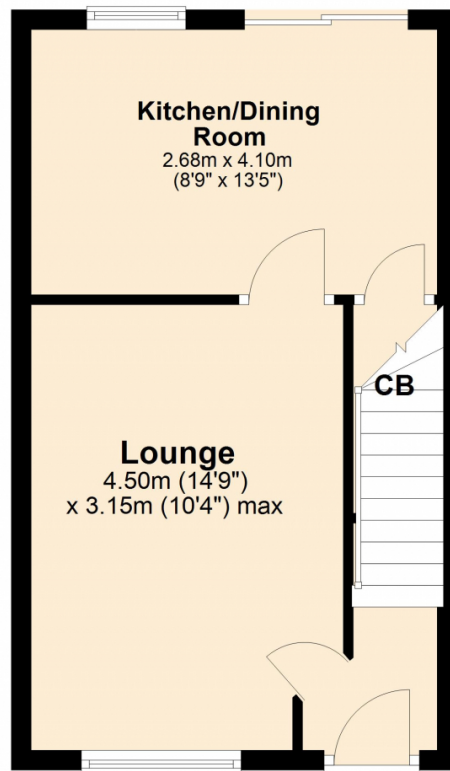

## First Floor

Approx. 29.8 sq. metres (320.9 sq. feet)

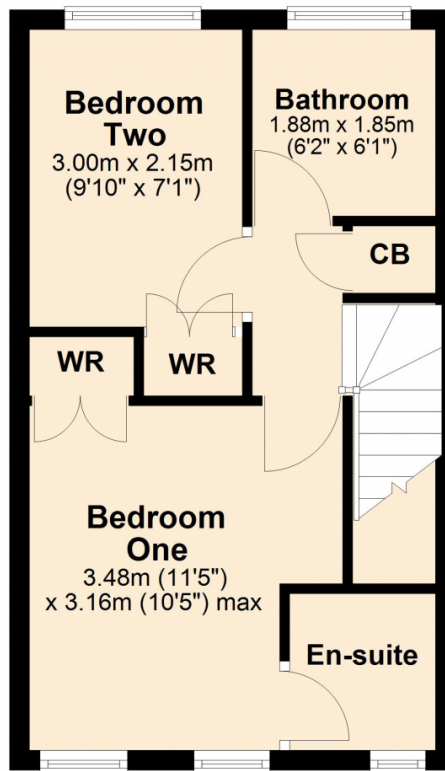

Total area: approx. 59.6 sq. metres (641.9 sq. feet)

