



Apartment (EPC Rating: C)

ESSEX ROAD, WATFORD, WD17 4EP

Per Month

£1,350 Per



1 Bedroom Apartment located in Watford

ONE BEDROOM APARTMENT WITH A BALCONY LOCATED IN NASCOT WOOD MINUTES FROM WATFORD JUNCTION STATION.

A beautifully presented one-bedroom apartment situated in the highly sought-after Nascot Wood area, just minutes from Watford Junction Station making it an ideal choice for commuters.

This well-appointed home offers a bright and comfortable living space, featuring a semi-separate kitchen, a spacious double bedroom, and a modern bathroom. The property further benefits from double glazing and central heating, ensuring year-round comfort.

A private balcony provides a pleasant outdoor retreat, while additional conveniences include optional permit parking and a garage available for £50 per month.

Perfectly positioned within the WD17 postcode, the apartment is surrounded by a vibrant selection of shops, cafés, and restaurants, as well as excellent local amenities. This prime location combines suburban tranquillity with superb connectivity, making it an outstanding opportunity for professionals seeking both convenience and lifestyle.

Offered unfurnished and available now.



WATFORD LETTINGS | 12 MARKET STREET, WATFORD, HERTFORDSHIRE, WD18 0PD

GROUND FLOOR
503 sq.ft. (46.7 sq.m.) approx.

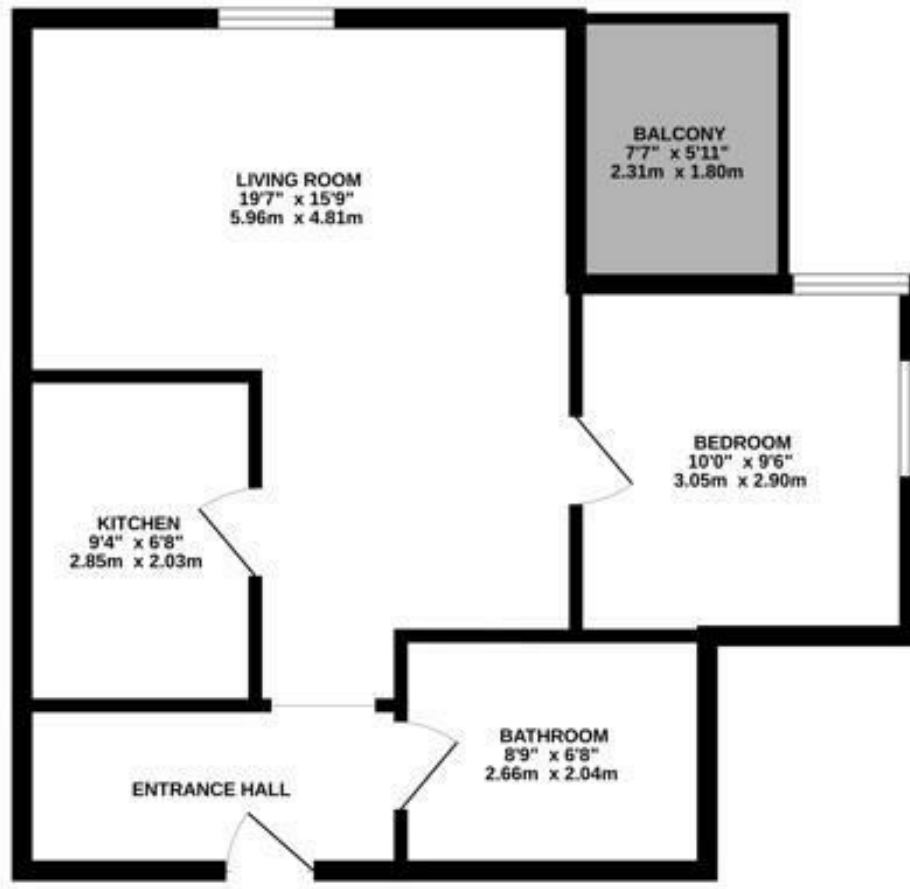

TOTAL FLOOR AREA: 503 sq.ft. (46.7 sq.m.) approx.

Whilst every attempt has been made to ensure the accuracy of the floorplan contained here, measurements of doors, windows, rooms and any other items are approximate and no responsibility is taken for any error, omission or misstatement. This plan is for illustrative purposes only and should be used as such by any prospective purchaser. The services, systems and appliances shown here are not being sold or guaranteed as to their operability or efficiency can be given.
Made with Floorplan 12.0.0

Council Tax Band

C

Energy Performance Graph

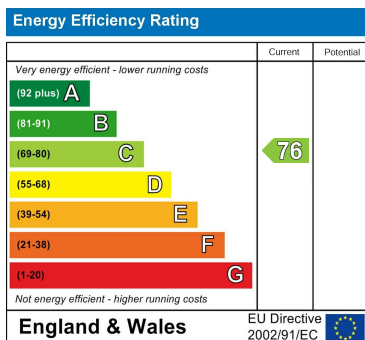

Call us on

01923 220 012

enquiries@warrenanthony.co.uk

www.warrenanthony.co.uk

Agents Note: Whilst every care has been taken to prepare these particulars, they are for guidance purposes only. All measurements are approximate and are for general guidance purposes only and whilst every care has been taken to ensure their accuracy, they should not be relied upon and potential buyers are advised to recheck the