



Ashford Road, NW2

£1,695 Per Month

This newly refurbished one-bedroom apartment at Ashford Court is finished to a high standard throughout, offering a bright open-plan kitchen and reception room with modern appliances, brand-new wooden flooring, a spacious double bedroom, and a stylish contemporary bathroom. Set within a well-maintained purpose-built block with lift access, the property also benefits from a separate utility cupboard for additional storage. Ideally located on Ashford Road, it is within easy reach of local amenities and excellent transport links, making it an ideal home for professionals or couples.

- Newly refurbished one-bedroom apartment
- Bright open-plan kitchen and living area.
- Spacious double bedroom.
- Lift access in a well-maintained purpose-built development.
- Excellent location close to local amenities and transport links.
- Deposit Amount: £1,955. Council Tax: Band B.



020 8450 9377 - 020 8459 1133
rentals@cameronsstiff.co.uk

Ashford Court, NW2

Approximate Area = 38.9 sq m / 419 sq ft

For Identification only - Not to Scale



EPC: D

Ref: 19816973

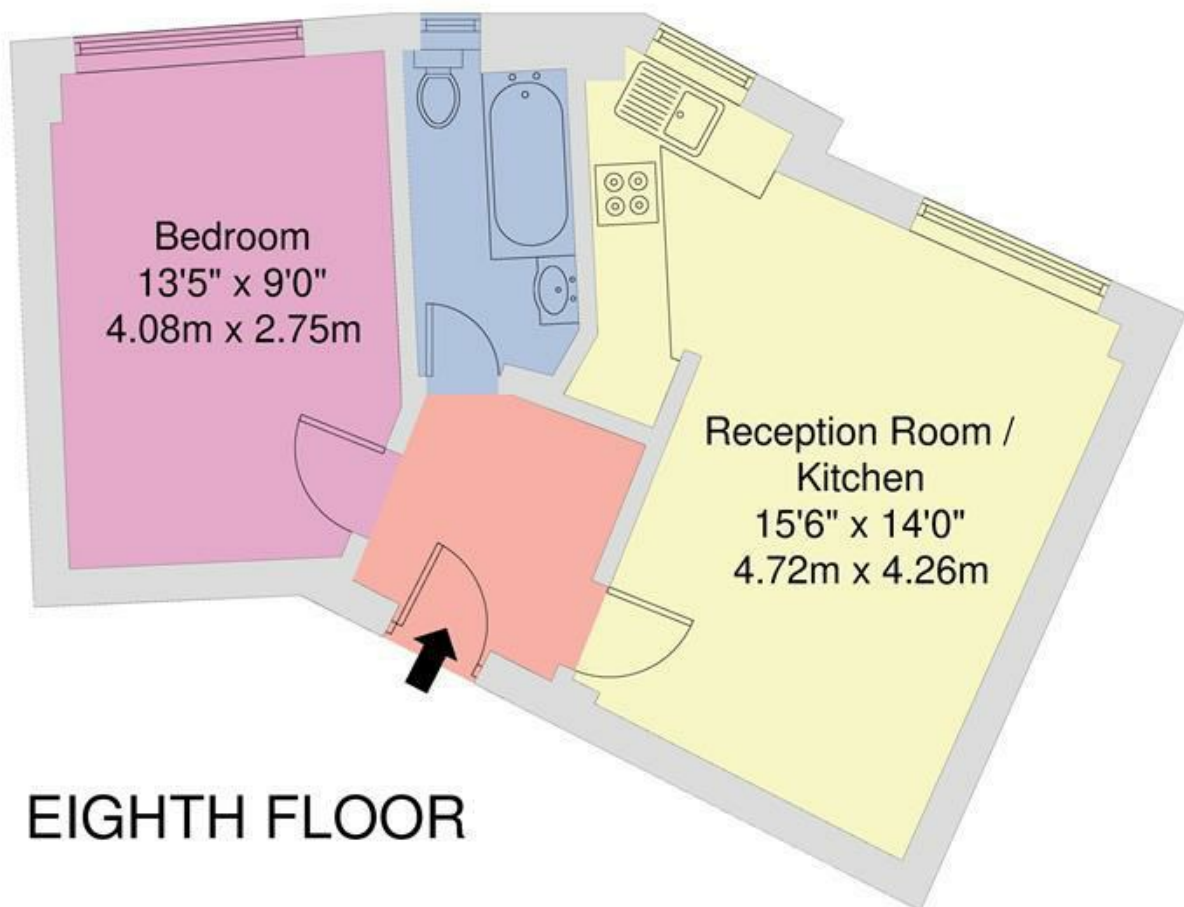

EIGHTH FLOOR

Disclaimer : Floorplan measurements are approximate and are for illustrative purposes only. While we do not doubt the floorplan accuracy and completeness, you or your advisors should conduct a careful, independent investigation of the property in respect of monetary valuation.

