



3 TYNINGS CLOSE, EASTON-IN-GORDANO, BS20 0FH





3 TYNINGS CLOSE

EASTON-IN-GORDANO BS20 0FH

- The Tynings, Easton in Gordano
- Set within a gated community
- Immaculate finish throughout
- EPC rating A & remainder of builders guarantee
- 2 ensuite and downstairs shower/wc
- Modern 2 bedroom detached house
- Wonderful countryside views
- Kitchen/diner & living room
- 2 double bedrooms
- No onward chain

LOCATION

Situated on the northern edge of the picturesque Gordano Valley, Tynings Close is surrounded by stunning countryside and areas of natural beauty. The Avon Wildlife Trust reserves at Hails Wood and Priors Wood are just a short distance away — with the latter renowned for its enchanting bluebell walk each spring. The area is highly regarded for its excellent schooling, offering both state and independent options including St Mary's Primary School, St Katherine's School and The Downs Preparatory School; all within easy reach.

Located within the North Somerset boundary, this sought-after semi-rural setting offers a wonderful balance of countryside tranquillity and city accessibility. So much so that it has previously been featured on Kirstie Allsopp's "Best of Both Worlds" on Channel 4, highlighting its appeal to those seeking space and serenity without compromising on convenience.

The area enjoys superb connectivity, being just four and half miles west of Bristol and easily accessible to Clifton Village, Portishead, and the M5 motorway. Residents benefit from a welcoming community atmosphere, a historic parish church, local shops, traditional pubs, and a network of scenic footpaths and bridleways perfect for walking and cycling. Major transport links including the M4/M5 interchange (junctions 19 and 20) are close by, while Clifton Village — with its vibrant mix of boutiques, cafés, and restaurants — is just a short drive away via the iconic Clifton Suspension Bridge. Nearby Portishead also offers a wide range of amenities, including supermarkets, marina-side eateries, and leisure facilities.

For leisure and days out, local highlights include the National Trust's Tyntesfield Estate, an impressive Victorian Gothic-Revival mansion set within beautiful parkland, and the ever-popular Noah's Ark Zoo Farm, both easily accessible along the B3128.

Goodman & Lilley are delighted to present this wonderful property to the market — To arrange your private viewing, please contact our team today on 01275 403660

GROUND FLOOR ACCOMMODATION

The spacious entrance hall with utility area and airing cupboard leads to an impressive wet room style shower room and w.c. The inner hall has further storage and offers a snug living room with countryside views. The generously proportioned dual aspect kitchen/diner has an attractive kitchen area, breakfast bar and sliding doors leading out to the wrap around, lawned garden.

FIRST FLOOR ACCOMMODATION

An open staircase with under stair storage leads to a galleried landing leading to two spacious double bedrooms. Both bedrooms have deep built-in wardrobes and an en-suite each. One has a large bath and the other has a spacious walk-in shower.





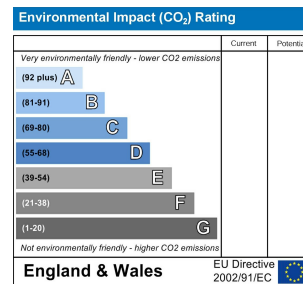
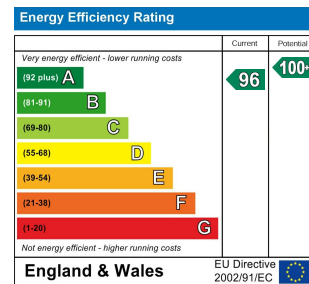



Ground Floor

Approx. 55.0 sq. metres (591.7 sq. feet)



First Floor

Approx. 49.9 sq. metres (537.0 sq. feet)

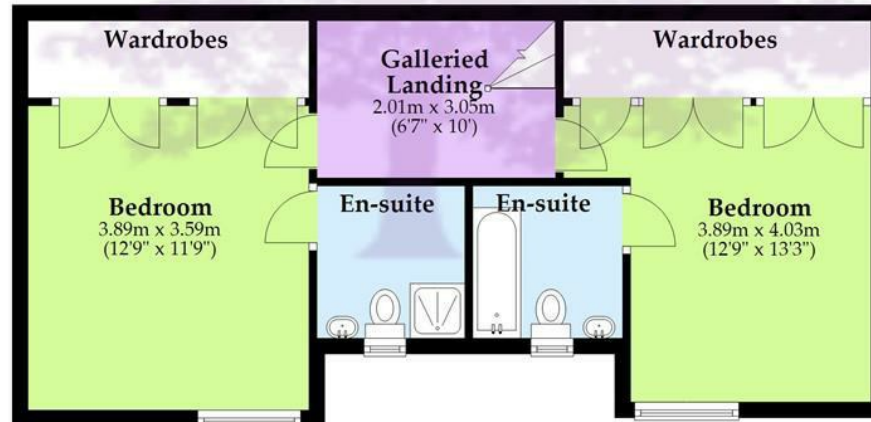

Total area: approx. 104.9 sq. metres (1128.6 sq. feet)

Whilst every attempt has been made to ensure accuracy of the floor plan all measurements are approximate and no responsibility is taken for any error, omission or measurement.

Plan produced using PlanUp.



GOODMAN & LILLEY

HENLEAZE

156 Henleaze Road
Henleaze BS9 4NB
henleaze@goodmanlilley.co.uk

0117 213 0777

PORTISHEAD

36 High Street
Portishead BS20 6EN
sales@goodmanlilley.co.uk

01275 430 440

SHIREHAMPTON

9 High Street
Shirehampton BS11 0DT
shire@goodmanlilley.co.uk

0117 213 0333

LETTINGS

lettings@goodmanlilley.co.uk

01275 299 010

0117 213 0101

LAND & NEW HOMES

156 Henleaze Road
Henleaze BS9 4NB
LNH@goodmanlilley.co.uk

0117 213 0151

CLEVEDON

28 Hill Road
Clevedon, BS21 7PH
clevedon@goodmanlilley.co.uk

01275 403 660

These particulars are for general guidance only. They do not form or constitute any part of an offer or contract. Goodman & Lilley has not carried out structural surveys of the property. The services, appliances or specific fittings mentioned in these details have not been tested. Every attempt is made to ensure accuracy, however all photographs, measurements, floor plans and distances are for illustrative purposes only. They must not be relied upon when purchasing carpets and or other fixtures & fittings. Lease details, service charges and ground rents are given as a guide only. They should be checked and confirmed by a licensed solicitor prior to exchange of contracts. The copyright of all details, photographs and floor plans remain exclusive to Goodman & Lilley.



rightmove

Zoopla