



Connells

Southbrook Rise Millbrook Road East
Southampton

Southbrook Rise Millbrook Road East Southampton SO15 1BX

for sale offers in excess of
£100,000



Property Description

Connells are delighted to bring to the market this one bedroom ground floor apartment situated in the highly convenient Freemantle, close to Southampton, Millbrook and Redbridge Train Station. It also has fantastic routes to the M27/M3 and great transport links to get you all throughout the city.

This apartment would make an ideal investment purchase, because it comprises of a well-sized double bedroom, a spacious open plan living room/kitchen area. The kitchen is well-appointed with an integrated oven, sleek and clean cupboards and counter tops, and ample cupboard space! The modern three-piece bathroom has a toilet, wash hand basin with storage, bath with attached overhead shower, a mirror, and a heated towel rack. Further benefits to this property are electric heating, double glazing, a communal garden. It has an allocated parking space, a bike store which is covered by CCTV and a security entry phone system. A viewing is highly recommended to truly appreciate the accommodation we have to offer here on Millbrook Road East.

The property is conveniently situated with easy access to the City Centre and its wide range of shopping facilities, including the West Quay Shopping Centre. Southampton boasts a mainline railway station and there is easy access to the M3 and M27 motorways, as well as Southampton International Airport, and both Southampton Solent University and University of Southampton, as well as education and recreational grounds for all ages!

Hallway

Kitchen/Lounge

19' x 8' 1" (5.79m x 2.46m)

Bathroom

6' x 5' (1.83m x 1.52m)

Modern Three-Piece Bathroom has a Toilet, Wash Hand Basin with Storage, Bath with Attached Overhead Shower, a Mirror, and a Heated Towel Rack.

Bedroom

13' x 8' (3.96m x 2.44m)







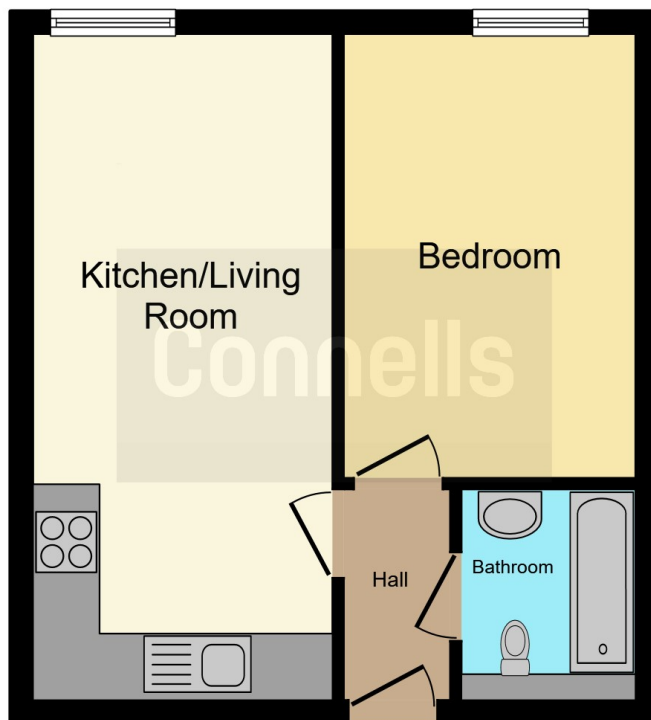

This floor plan is for illustrative purposes only. It is not drawn to scale. Any measurements, floor areas (including any total floor area), openings and orientation are approximate. No details are guaranteed, they cannot be relied upon for any purpose and they do not form part of any agreement. No liability is taken for any error, omission or misstatement. A party must rely upon its own inspection(s). Powered by www.focalagent.com

To view this property please contact Connells on

T 02380 789 351
E shirley@connells.co.uk

409 Shirley Road Shirley
 SOUTHAMPTON SO15 3JD

EPC Rating: D Council Tax
 Band: A

Service Charge:
 1659.80

Ground Rent:
 200.00

Tenure: Leasehold

view this property online connells.co.uk/Property/SSR311751

This is a Leasehold property with details as follows; Term of Lease 125 years from 01 Jan 2015. Should you require further information please contact the branch. Please Note additional fees could be incurred for items such as



1. MONEY LAUNDERING REGULATIONS Intending purchasers will be asked to produce identification documentation at a later stage and we would ask for your co-operation in order that there will be no delay in agreeing the sale. 2. These particulars do not constitute part or all of an offer or contract. 3. The measurements indicated are supplied for guidance only and as such must be considered incorrect. Potential buyers are advised to recheck measurements before committing to any expense. 4. We have not tested any apparatus, equipment, fixtures, fittings or services and it is in the buyers interest to check the working condition of any appliances.

Connells Residential is registered in England and Wales under company number 1489613, Registered Office is Cumbria House, 16-20 Hockliffe Street, Leighton Buzzard, Bedfordshire, LU7 1GN. VAT Registration Number is 500 2481 05.

See all our properties at www.connells.co.uk | www.rightmove.co.uk | www.zoopla.co.uk

Property Ref: SSR311751 - 0009