







9 Cherry Tree Grove

North Wingfield • Chesterfield • S42 5QT

£170,000

Offered to the market is this two-bedroom semi-detached house, situated in the popular area of North Wingfield. The property benefits from a variety of everyday amenities nearby, including local shops, supermarkets, cafés, and pubs, along with well-regarded schools within the area. For those who enjoy the outdoors, the Five Pits Trail is close by, while the Peak District is easily accessible by car. The property is also ideally positioned for commuters, with convenient access to Chesterfield, Clay Cross, the M1 motorway, and major road networks. This home is perfectly suited to first-time buyers, couples, and single professionals. The property is entered via a small hallway with the staircase leading to the first floor. To the left is the lounge diner, a well-proportioned front-facing reception room featuring a fireplace. To the rear of the lounge is a dedicated dining area, creating a practical and sociable living space. This room then opens into the kitchen at the rear of the property. The kitchen is fitted with modern units, offering space for freestanding appliances along with ample storage. An external door provides direct access to the rear garden. To the first floor are two bedrooms and the family bathroom. Bedroom one is a spacious front-facing double bedroom benefitting from fitted wardrobes. Bedroom two overlooks the rear garden and is a well-sized single room. The bathroom is fitted with a modern tiled three-piece suite comprising a bath, wash basin, and WC. Externally, the rear garden is private, enclosed, and designed for low maintenance, featuring a patio area and an artificial lawn. To one side is a substantial workshop/shed providing useful storage or workspace potential. To the front of the property is a pebbled driveway offering off-road parking, along with a car port.





- Two Bedroom Semi Detached House
- Close to Local Amenities & Transport Links
- Perfect First-Time Home
- Good Sized Front Facing Lounge Diner
- Modern Kitchen w/ Access onto Rear Garden

- Two Well Proportioned Bedrooms
- Modern Three Piece Suite Bathroom
- Private Low Maintenance Rear Garden w/ Workshop
- Off Street Driveway Parking
- Council Tax Band B





9 CHERRY TREE GROVE

APPROXIMATE GROSS INTERNAL AREA = 58.9 SQ M / 634.5 SQ FT

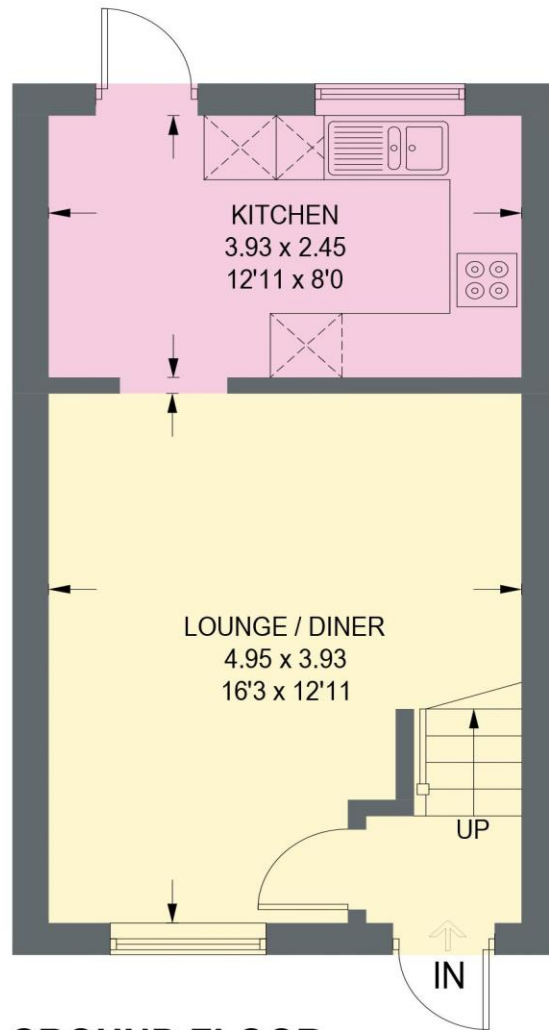

GROUND FLOOR
29.5 SQ M / 317.3 SQ FT

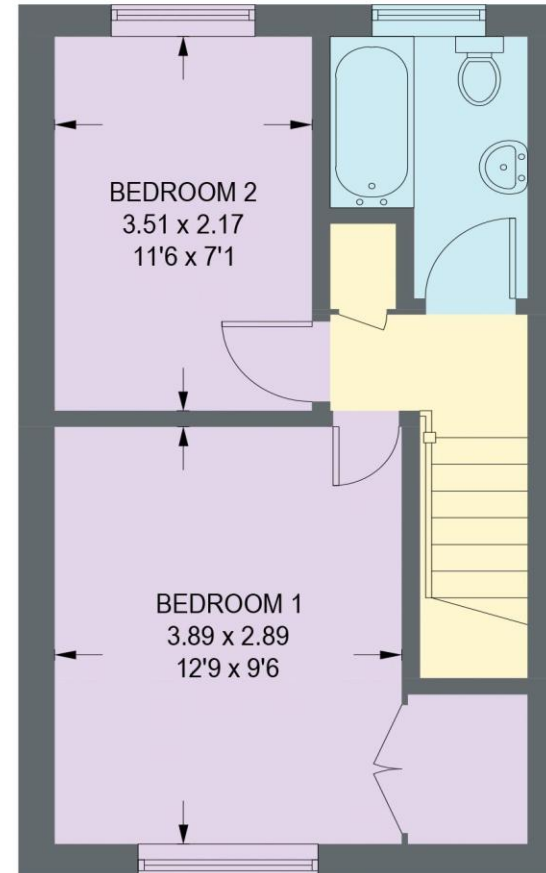

FIRST FLOOR
29.5 SQ M / 317.2 SQ FT

Illustration for identification purposes only, measurements are approximate, not to scale. (ID1309440)



haus

31 West Bars, Chesterfield, S40 1AG
chesterfield@haushomes.co.uk haushomes.co.uk

01246 380 535