



Aisgill Avenue, W14

£4,500 Per calendar month

An excellent four double bedroom house centrally located with easy access to both West Kensingtons and Fulham multiple shopping and transport facilities. The accommodation offers four generous bedrooms, fully fitted separate kitchen, a private rear garden, modern bathroom and separate shower WC.

Aisgill Avenue is located in the West Kensington estate and is best accessed off Beaumont crescent. Well placed for West Kensington and Barons Court underground station and the A4 for easy access into and out of central London.

Features

- House
- Four Bedrooms
- Garden
- Wooden Floor
- Separate Kitchen
- Close to Shops

Aisgill Avenue, London, W14

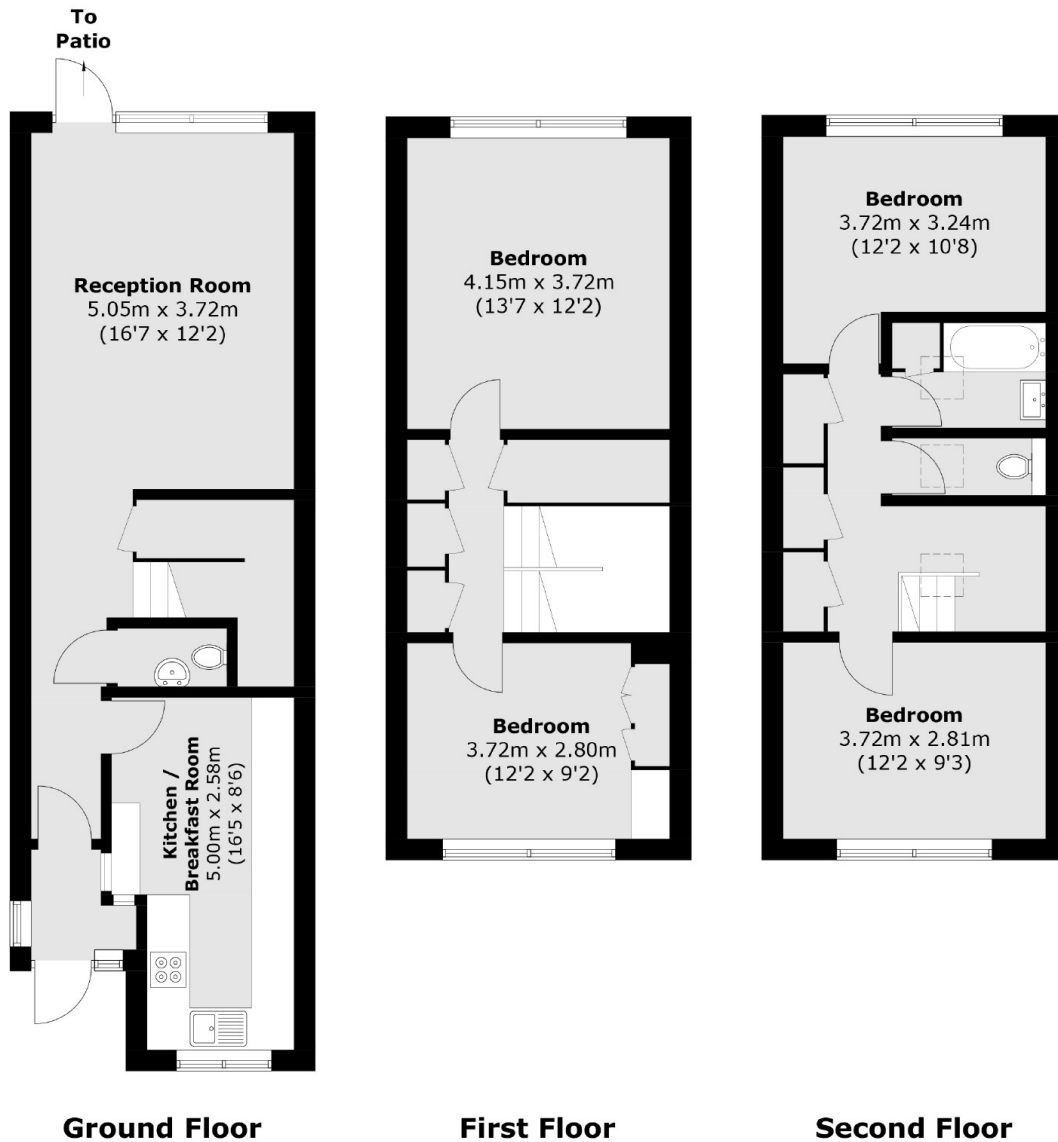

Total area (approx.): 120.3 sq. m (1,295.0 sq. ft)