



**POOLE
TOWNSEND**

14 Thames Road, Walney

£159,950

🛏️ 2 🚿 1 🚗 1



- NO UPPER CHAIN
- Popular Residential Area
- Front And Rear Gardens
- Integrated Appliances
- Gas Central Heated
- Mid Terraced Family Home
- Off-Road Parking
- Modern L Shaped Kitchen
- Two Double Bedrooms
- Partial Double Glazing



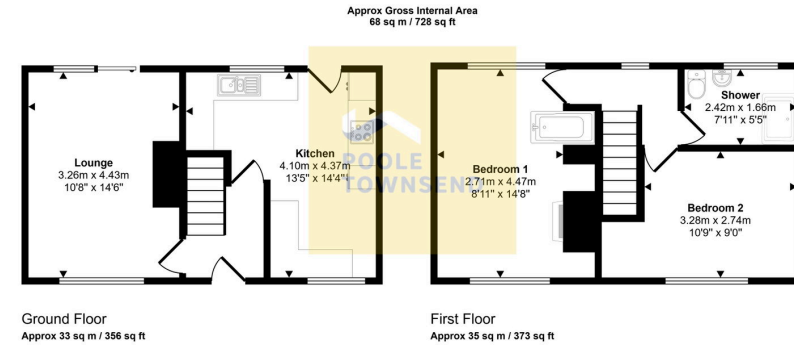

This floorplan is only for illustrative purposes and is not to scale. Measurements of rooms, doors, windows, and any items are approximate and no responsibility is taken for any error, omission or mis-statement. Icons of items such as bathroom suites are representations only and may not look like the real items. Made with Made Snappy 360.

Mid-terraced family home situated in a popular residential location close to a primary school, local bus services and convenience store. The property benefits from private off-road parking, open-plan front garden and a generous rear garden with large patio and raised lawn. Internally, the accommodation includes a welcoming hallway, bright lounge with sliding patio doors to the garden and a modern L-shaped kitchen fitted with grey gloss units, integrated oven, gas hob, fridge freezer and breakfast bar area. To the first floor are two double bedrooms, including a dual-aspect principal bedroom with feature chimney breast, electric fire and roll-top bath. The stylish shower room features a dual-head shower, concealed cistern WC and hand basin with vanity storage. Further benefits include gas-fired central heating, partial double glazing and no upper chain.

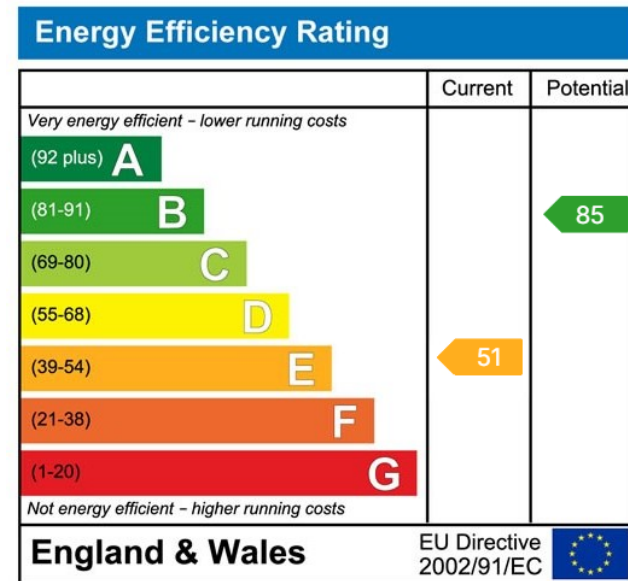

Visit us at
www.pooletownsend.co.uk
enquiries@pooletownsend.co.uk

We are open
 Monday – Friday 9.00 – 5.00
 Saturday 9.00 – 1.00

Barrow 01229 811811
 Ulverston 01229 588111
 Grange 015395 33316
 Kendal 01539 734455
 Milnthorpe 015395 62044