



## St. Albans Avenue, W4

£435,000

Offered to the market with no onward chain, this second floor, two double-bedroom purpose-built flat is situated within a popular development in a prime location. While the property is in need of refurbishment throughout, it features the additional benefits of a private garden, a private outside storage cupboard, new double glazed windows and a long lease. This flat would be an ideal choice for a first-time buyer or someone looking to downsize.

St. Albans Avenue is a sought-after road on the borders of Bedford Park. It's a short walk to Turnham Green Terrace and Chiswick High Road's shops and cafés. Turnham Green station (District line) is nearby. The area is both convenient and desirable.

### Features

Purpose Built  
Two Bedrooms  
Second Floor  
Private Garden  
Prime Location  
In Need of Refurbishment

St. Albans Avenue,  
London, W4

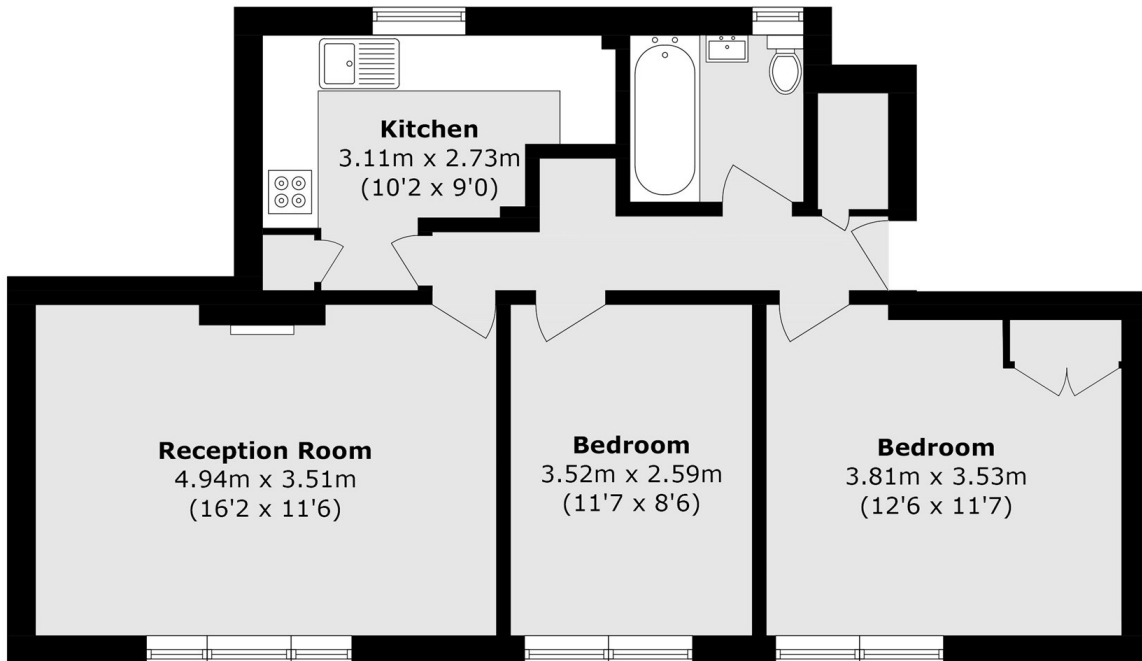

Total Area (approx.): 59.7 sq. m (642.6 sq. ft)