



Math Meadow, BIRMINGHAM B32 2NU

welcome to

Math Meadow, BIRMINGHAM

Delighted to offer this ONE BEDROOM END TERRACED HOME IN HARBORNE. This elegant property with its impressive layout over two floors briefly comprises entrance, lounge, fitted kitchen, lean to with washing machine, first floor bedroom, bathroom, garden, parking, courtyard to the fore-front.

Agent Note

This property is council tax band B.

Entrance Porch

Front doors leads into living room.

Living Room/Kitchen

18' 10" x 12' 7" (5.74m x 3.84m)

Double glazed windows to front, side & rear, stairs to first floor, electric fire on wall, double glazed door from kitchen area to garden, ceiling light connections, central heating radiator, free standing cooker with cooker hood over, sink & drainer, laminate floor, range of wall & base units with worktops over.

Landing

Double glazed window, doors to bedroom & bathroom, carpet, ceiling light connection.

Bedroom

12' 6" x 11' 3" (3.81m x 3.43m)

Double glazed windows, built in cupboard, carpet, ceiling light connection, central heating radiator.

Bathroom

7' 5" x 6' 2" (2.26m x 1.88m)

Double glazed frosted window to rear, bath with shower over, wash hand basin with mixer tap, low level flush w/c, with mirror wall behind.





view this property online shipways.co.uk/Property/HBN112365



welcome to

Math Meadow, BIRMINGHAM

- End Terrace House in quiet cul-de-sac
- Great Condition Throughout
- Open Plan Ground Floor
- Modern Fitted Kitchen
- One Double Bedroom

Tenure: Freehold EPC Rating: D
Council Tax Band: B

£160,000

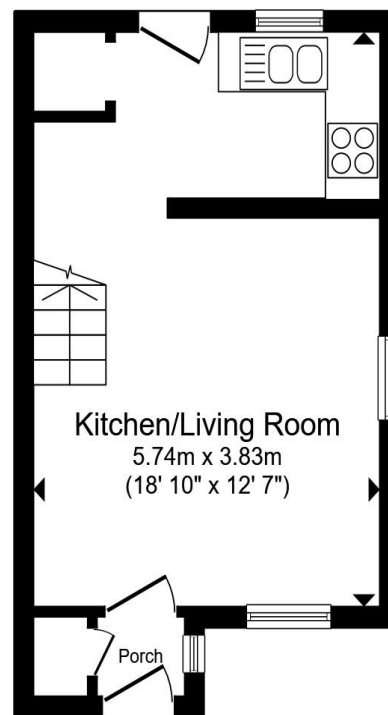

Ground Floor

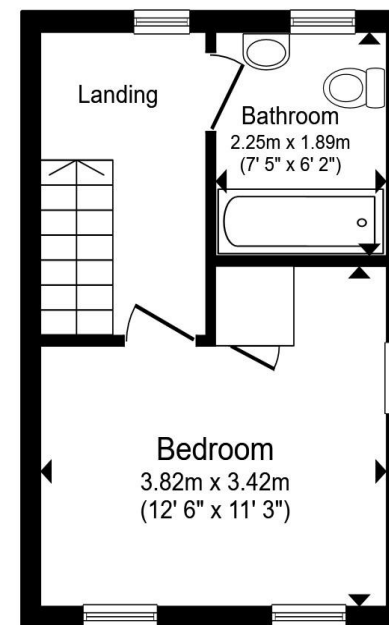

First Floor

Total floor area 45.6 m² (491 sq.ft.) approx

This floor plan is for illustrative purposes only. It is not drawn to scale. Any measurements, floor areas (including any total floor area), openings and orientation are approximate. No details are guaranteed, they cannot be relied upon for any purpose and they do not form part of any agreement. No liability is taken for any error, omission or misstatement. A party must rely upon its own inspection(s). Powered by www.propertybox.io



view this property online shipways.co.uk/Property/HBN112365



Property Ref:
HBN112365 - 0004

1. MONEY LAUNDERING REGULATIONS Intending purchasers will be asked to produce identification documentation at a later stage and we would ask for your co-operation in order that there is no delay in agreeing the sale. 2. These particulars do not constitute part or all of an offer or contract. 3. The measurements indicated are supplied for guidance only and as such must be considered incorrect. Potential buyers are advised to recheck measurements before committing to any expense. 4. We have not tested any apparatus, equipment, fixtures or services and it is in the buyers interest to check the working condition of any appliances. 5. Where an EPC, or a Home Report (Scotland only) is held for this property, it is available for inspection at the branch by appointment. If you require a printed version of a Home Report, you will need to pay a reasonable production charge reflecting printing and other costs. 6. We are not able to offer an opinion either written or verbal on the content of these reports and this must be obtained from your legal representative. 7. Whilst we take care in preparing these reports, a buyer should ensure that his/her legal representative confirms as soon as possible all matters relating to title including the extent and boundaries of the property and other important matters before exchange of contracts.

Shipways is a trading name of Sequence (UK) Limited which is registered in England and Wales under company number 4268443, Registered Office is Cumbria House, 16-20 Hockliffe Street, Leighton Buzzard, Bedfordshire, LU7 1GN. VAT Registration Number is 500 2481 05.



0121 427 3264



harborne@shipways.co.uk



172 High Street, Harborne, BIRMINGHAM,
West Midlands, B17 9PP



shipways.co.uk