



Southover, Bromley

Bromley

Guide Price £200,000 - £225,000



Southover

Bromley

Offered to the market with no onward chain, this well-presented one-bedroom ground floor apartment is an excellent choice for first-time buyers, investors, or those looking to downsize.

The property offers approximately 417 sq ft of accommodation, featuring a bright reception room, fitted kitchen, spacious double bedroom, and a modern bathroom. It also benefits from a private rear garden as well as access to well-maintained communal gardens.

Conveniently located close to local shops, parks, and excellent transport links, including Grove Park Station, this apartment offers a great balance of comfort and convenience. Early viewing is highly recommended.

Council Tax band: B

Tenure: Leasehold

Southover

Bromley

- Perfect for First-Time Buyers
- Ground Floor Maisonette
- Private Garden with Gated Access
- Large Double Bedroom
- Spacious Living Room
- 90 Year Lease Remaining
- £102.53 Service Charge Per Annum
- £10 Ground Rent Per Annum
- 15 Min Walk to Grove Park Station
- Chain-Free



Southover, BR1 4SL

Approx Gross Internal Area = 38.74 sq m / 417 sq ft

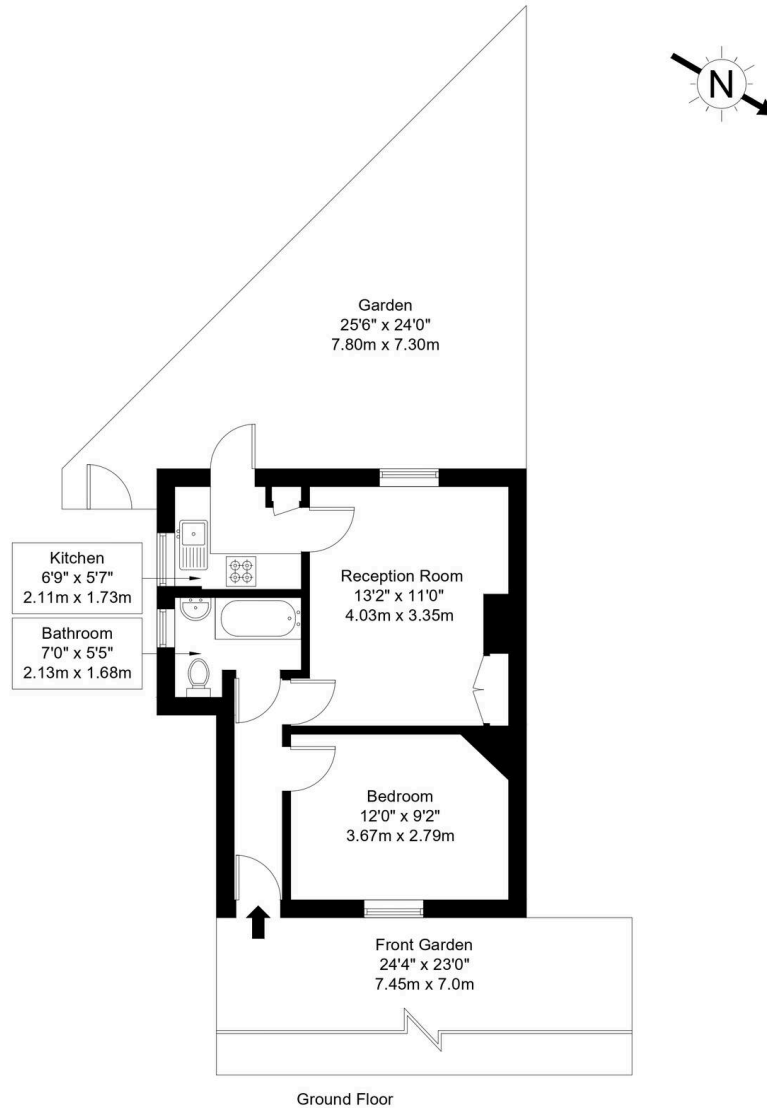

Ref :

Copyright **BLEU
PLAN**

The Floor plan is not to scale and measurements and areas shown are approximate and therefore should be used for illustrative purposes only. The plan has been prepared in accordance with the RICS code of Measuring Practice and whilst we have confidence in the information produced it must not be relied on. Maximum lengths and widths are represented on the floor plan. If there is any aspect of particular importance, you should carry out or commission your own inspection of the property.
Copyright @ BLEUPLAN



Berkleys Estate Agents

28 Mottingham Road, Mottingham - SE9 4QW

02034356660 • hello@berkleyspg.com • berkleyspg.com

B Berkleys
SALES & LETTINGS AGENCY