



St. Petersburg Place, W2

£4,800 Per calendar month

A three double bedroom apartment on the second floor (lift access) of a Portered building with a private terrace benefitting from equal doubles in the heat of Notting Hill. Please note that this property does not have an HMO licence, making it ideal for couples or families.

Ideally located less than half a mile from Hyde Park, Notting Hill and Queensway. This Residence also benefits from a porter service and secure entry.

Features

- Three Double Bedrooms
- Portered Building
- Private Balcony
- En Suite
- Guest WC
- Centrally Located



St. Petersburgh Place, W2



St. Petersburg Place, London, W2

Second Floor

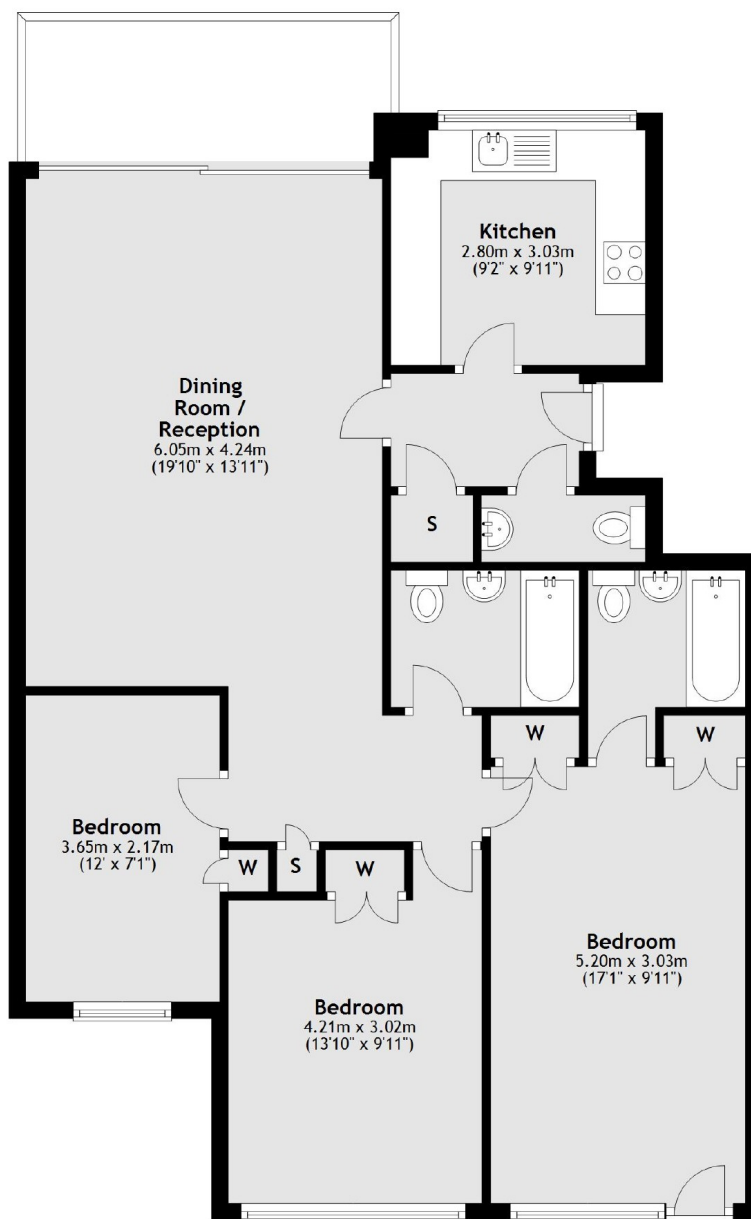

Main area: Approx. 93.7 sq. metres (1008.5 sq. feet)
Plus balconies, approx. 7.7 sq. metres (82.6 sq. feet)