

£269,995

LEOMINSTER ROAD, PAULSGROVE, PORTSMOUTH, PO6 4DD



- Three Bedrooms
- Entrance Hallway
- Lounge
- Fitted Kitchen/Diner
- First Floor Bathroom
- Gas Central Heating
- Double Glazed Windows
- Enclosed Rear Garden
- Outbuildings
- No Chain Ahead

Portchester Office

92 West Street Portchester Hampshire PO16 9UQ

Tel: 02392 327 070 | E: portchester@fenwicks-estates.co.uk

www.fenwicks-estates.co.uk

Property Reference: P2857

Council Tax Band: B

Score	Energy rating	Current	Potential
92+	A		
81-91	B		
69-80	C	70 C	78 C
55-68	D		
39-54	E		
21-38	F		
1-20	G		

Floor Plans (For illustrative purposes and not drawn exactly to scale)

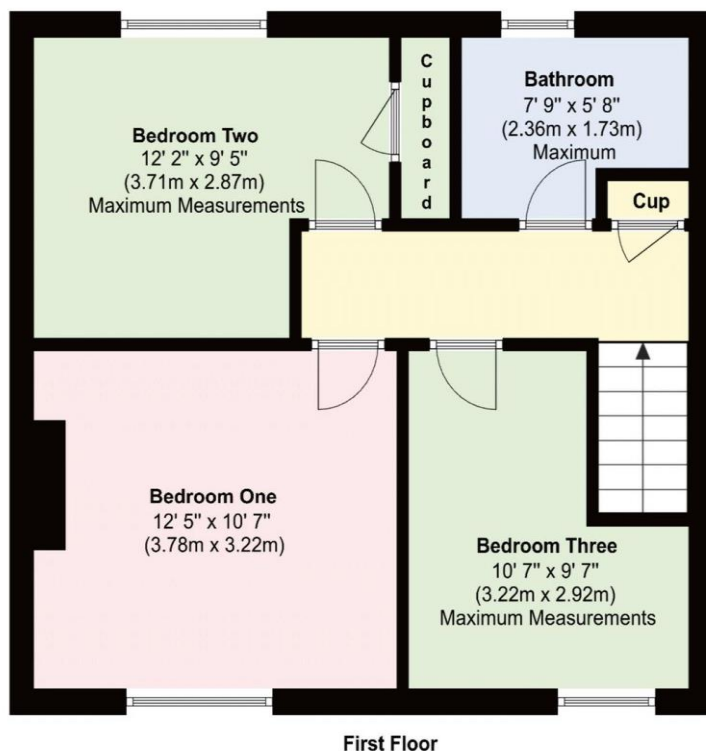
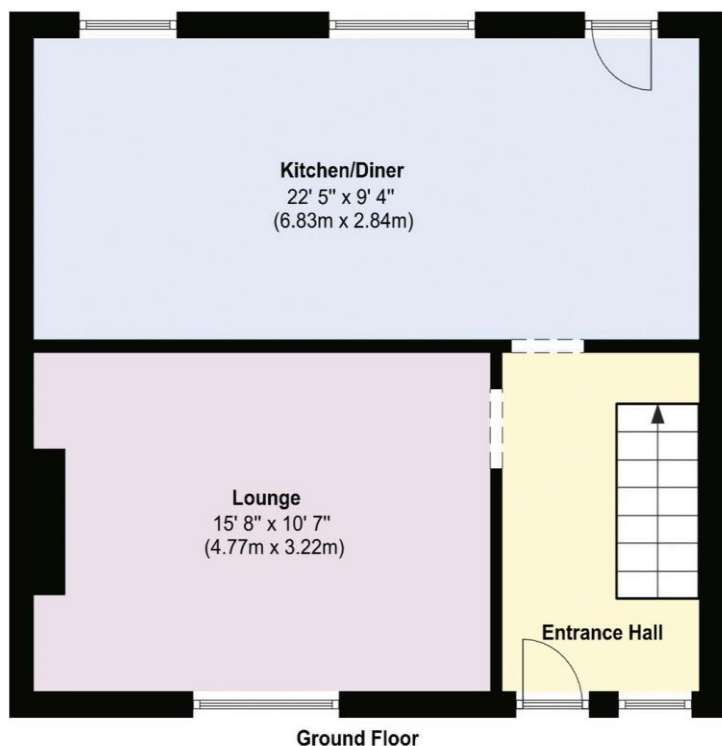

Portchester Office

92 West Street Portchester Hampshire PO16 9UQ

Tel: 02392 327 070 | E: portchester@fenwicks-estates.co.uk

www.fenwicks-estates.co.uk



The Accommodation Comprises:-

Covered entrance with part glazed wooden front door into:

Entrance Hall:-

Stairs to first floor, radiator, wood effect laminate flooring and flat ceiling with central ceiling rose. Doorways to:

Lounge:-

15' 8" x 10' 7" (4.77m x 3.22m)

UPVC double glazed window to front elevation overlooking the green, radiator, wood effect laminate flooring, feature fireplace, TV aerial point and coving to flat ceiling with spotlighting inset.



Kitchen/Diner:-

22' 5" x 9' 4" (6.83m x 2.84m)

Two UPVC double glazed windows to rear elevation overlooking the garden, fitted range of modern base, eye level and larder style soft close units, roll top worksurfaces, single bowl sink unit with mixer tap, matching cupboard housing the gas central heating boiler, built-in oven with five ring gas hob above, integrated under counter fridge, space and plumbing for washing machine, space for table and chairs, radiator, wood effect laminate flooring and flat ceiling with spotlighting inset. Stable style door to:



Portchester Office

92 West Street Portchester Hampshire PO16 9UQ

Tel: 02392 327 070 | E: portchester@fenwicks-estates.co.uk

www.fenwicks-estates.co.uk



Covered Rear Lobby:-

Built-in storage cupboard and outside WC (not tested).

First Floor Landing:-

Built-in storage cupboard, radiator, wood effect laminate flooring and coving to flat ceiling. Doors to:

Bedroom One:-

12' 5" x 10' 7" (3.78m x 3.22m)

UPVC double glazed window to front elevation overlooking the green, radiator, wood effect laminate flooring and flat ceiling with spotlighting inset.



Bedroom Two:-

12' 2" x 9' 5" (3.71m x 2.87m) Maximum Measurements

UPVC double glazed window to rear elevation overlooking the garden, radiator, built-in storage cupboard, wood effect laminate flooring and coving to flat ceiling.

Portchester Office

92 West Street Portchester Hampshire PO16 9UQ

Tel: 02392 327 070 | E: portchester@fenwicks-estates.co.uk

www.fenwicks-estates.co.uk





Bedroom Three:-

10' 7" x 9' 7" (3.22m x 2.92m) Maximum Measurements

UPVC double glazed window to front elevation overlooking the green, radiator, wood effect laminate flooring and coving to flat ceiling.



Bathroom:-

7' 9" x 5' 8" (2.36m x 1.73m) Maximum Measurements

Opaque UPVC double glazed window to rear elevation, white suite comprising: panelled bath, close coupled WC, wash hand basin, tiled walls, chrome heated towel rail, wood effect laminate flooring and coving to flat ceiling with spotlighting inset.



Outside:-

Low maintenance front garden laid to shingle and brick retaining wall. Side access and wooden gate leads to:



Rear Garden:-

West facing, enclosed, AstroTurf seating area, with remainder laid to block paving for ease of maintenance, water tap, wooden outbuildings and storage cupboard.



Portchester Office

92 West Street Portchester Hampshire PO16 9UQ

Tel: 02392 327 070 | E: portchester@fenwicks-estates.co.uk

www.fenwicks-estates.co.uk



Disclaimer: These particulars are set out as a general outline in accordance with the Consumer Protection from Unfair Trading Regulations 2008 (CPR's) and Business Protection from Misleading Marketing Regulations 2008 (BPR's) only for the guidance of intending purchasers or lessees, and do not constitute any part of an offer or contract. Details are given without any responsibility, and any intending purchasers, lessees or third parties should not rely on them as statements or representations of fact, but must satisfy themselves by inspection or otherwise as to the correctness of each of them.

We have not carried out a structural survey and the services, appliances and specific fittings have not been tested. All photographs, measurements, floor plans and distances referred to are given as a guide only and should not be relied upon for the purchase of carpets or any other fixtures or fittings. Gardens, roof terraces, balconies and communal gardens as well as tenure and lease details cannot have their accuracy guaranteed for intending purchasers. Lease details, service ground rent (where applicable) are given as a guide only and should be checked and confirmed by your solicitor prior to exchange of contracts.

No person in the employment of Fenwicks Estates Ltd has any authority to make any representation or warranty whatever in relation to this property. Purchase prices, rents or other prices quoted are correct at the date of publication and, unless otherwise stated, exclusive of VAT.

Data Protection: We retain the copyright in all advertising material used to market this Property.

Money Laundering Regulations 2017: Intending purchasers will be required to produce identification documentation once an offer is accepted

Your home is at risk if you do not keep up repayments on mortgage or other secured loans.

Portchester Office

92 West Street Portchester Hampshire PO16 9UQ

Tel: 02392 327 070 | E: portchester@fenwicks-estates.co.uk

www.fenwicks-estates.co.uk

