

11 Warwick Place, Leamington Spa
Offers Over £200,000

charlesrose.

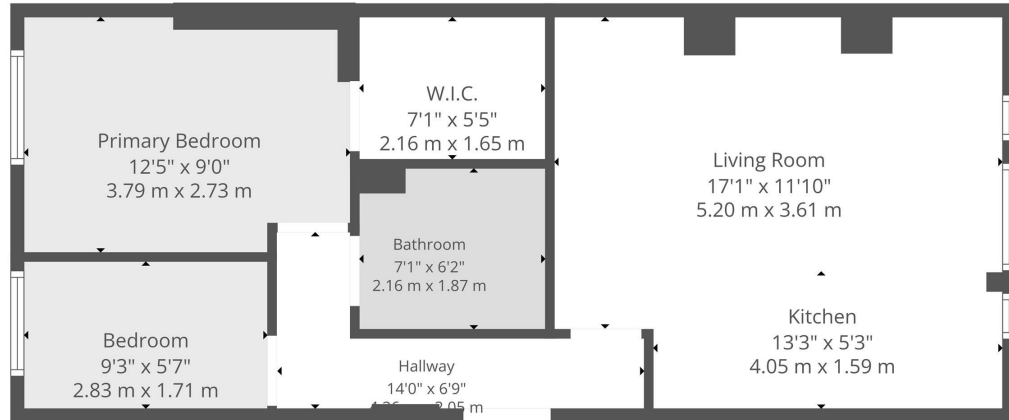

Total: 554 sq. Ft. 52 m2
1st Floor: 554 sq. Ft. 52 m2
Excluded Areas: Walls: 54 sq. Ft. 4 m2
Floor Plan Created By Cubicasa App. Measurements Deemed Highly Reliable But Not Guaranteed.



Beautifully refurbished lower ground floor apartment forming part of an attractive period conversion on sought-after Warwick Place. Featuring a spacious open-plan living/kitchen area, two bedrooms, walk-in wardrobe, contemporary bathroom, double glazed sash windows, allocated parking and no onward chain, all within walking distance of Leamington Spa town centre and railway station.

charlesrose.

- 01926 832411
- hello@charlesrose.co.uk
- charlesrose.co.uk

