



2 Bed  
Apartment - Purpose  
Built  
located in

£900 Per month



**SMART STREET**  
THE PROPERTY PEOPLE

# GROUND FLOOR

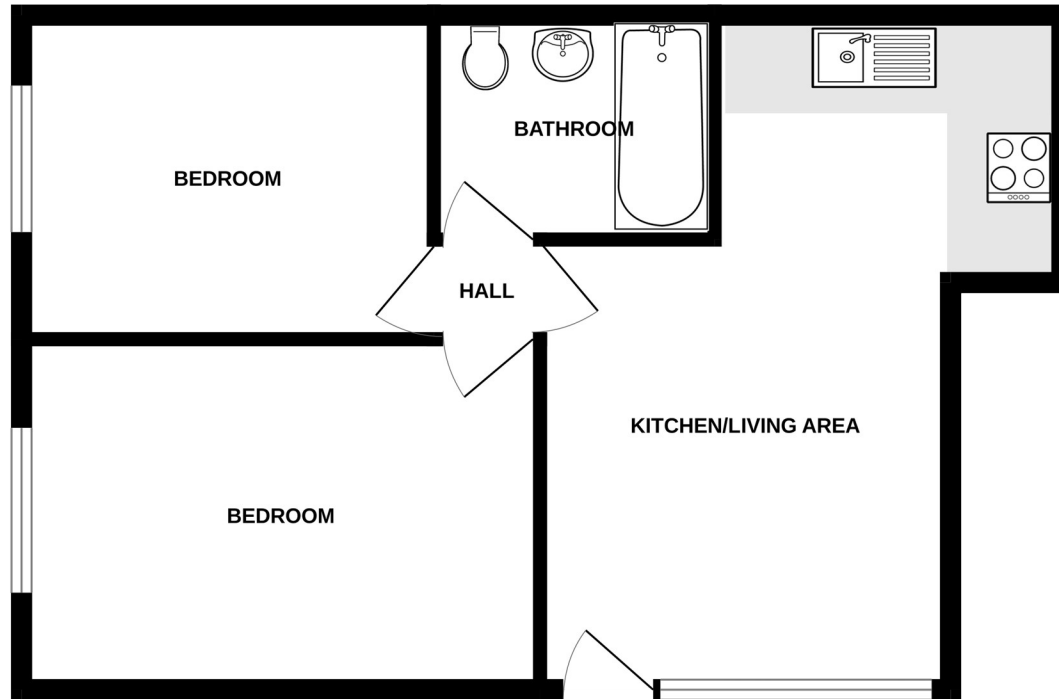

## DIRECTIONS

### CONTACT

14 Withambrook Park  
Grantham  
NG31 9ST

E: [info@smartstreetproperty.com](mailto:info@smartstreetproperty.com)  
T: 01476 247107

Energy Efficiency Rating		
	Current	Potential
<i>Very energy efficient - lower running costs</i>		
(92 plus) <b>A</b>		
(81-91) <b>B</b>		
(69-80) <b>C</b>		
(55-68) <b>D</b>		
(39-54) <b>E</b>		
(21-38) <b>F</b>		
(1-20) <b>G</b>		
<i>Not energy efficient - higher running costs</i>		
EU Directive 2002/91/EC 		
England & Wales		



**SMART STREET**  
THE PROPERTY PEOPLE