



## Judd Street, WC1H

£2,500 Per calendar month

A newly refurbished one bedroom apartment on the top floor of a red brick mansion block on Judd Street. It has a bright, modern reception room with a separate kitchen, with modern appliances, a completely renovated bathroom, and a spacious double bedroom.

Jessel House is located a short walk away from Kings Cross, Euston and Russell Square tube station making it perfect for those who want to be in the hub of Bloomsbury with transport links on their doorstep.

### Features

- One Bedroom
- Newly Refurbished
- Top Floor
- Great Transport Links
- Lift Access
- Bike Storage

Judd Street,  
London, WC1H

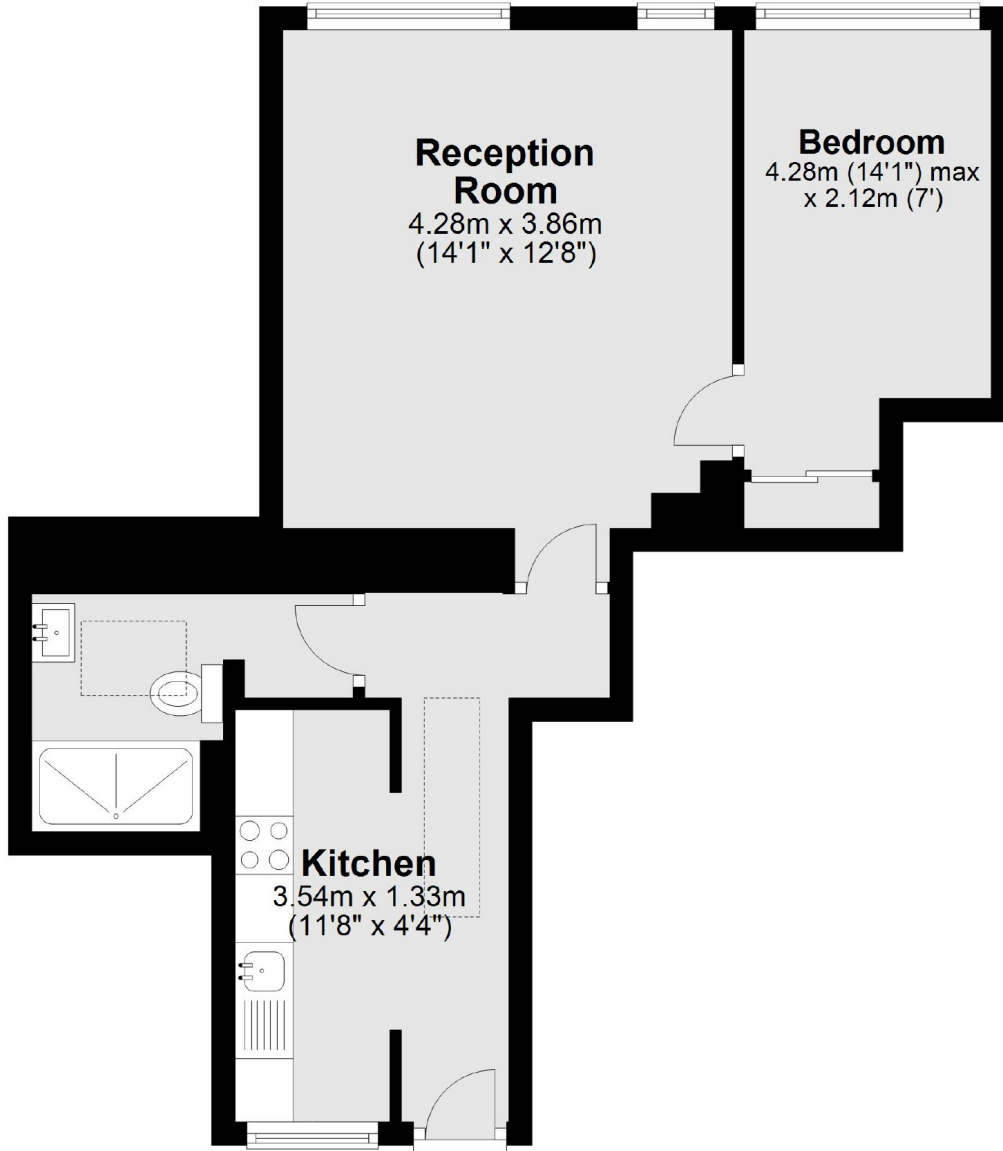

Total area: approx. 42.6 sq. metres (458.6 sq. feet)