



**Cloverdale Road, Hamilton Leicester LE5 1UL**

**welcome to**

## **Cloverdale Road, Hamilton Leicester**

A semi detached home featuring a through lounge with rear dining area, a fitted kitchen, three double bedrooms including a master with en-suite, plus a garage and driveway. With excellent potential to extend (STPP), this property offers a fantastic opportunity to create a superb family home

### **Entrance Hall**

Door to the front.

### **Lounge**

Window to the front, wooden flooring and radiator

### **Dining Room**

French doors to the rear and radiator.

### **Kitchen**

Fitted kitchen comprising of wall and base units with work surfaces over, sink drainer unit, radiator, integrated oven and hob. Window to the rear and door to the rear.

### **First Floor Landing**

Stairs rising from the ground floor.

### **Bedroom One**

Two windows to the front and radiator.

### **En-Suite**

Window to the front, shower cubicle, WC, hand wash basin and radiator.

### **Bedroom Two**

Window to the rear, wooden flooring and radiator.

### **Bedroom Three**

Window to the rear, wooden flooring and radiator.

### **Bathroom**

Bath, WC, hand wash basin and radiator

### **Garage**

### **Front & Rear Of Property**

To the front of the property is a driveway and garage access. To the rear of the property is a garden which features paving and a laid lawn.





***view this property online*** [williamhbrown.co.uk/Property/LHS120616](http://williamhbrown.co.uk/Property/LHS120616)



welcome to

## Cloverdale Road, Hamilton Leicester

- Semi Detached
- Three Bedrooms
- Fitted Kitchen
- Rear Garden
- Garage & Off Road Parking

Tenure: Freehold EPC Rating: D  
Council Tax Band: C

offers in excess of  
**£315,000**

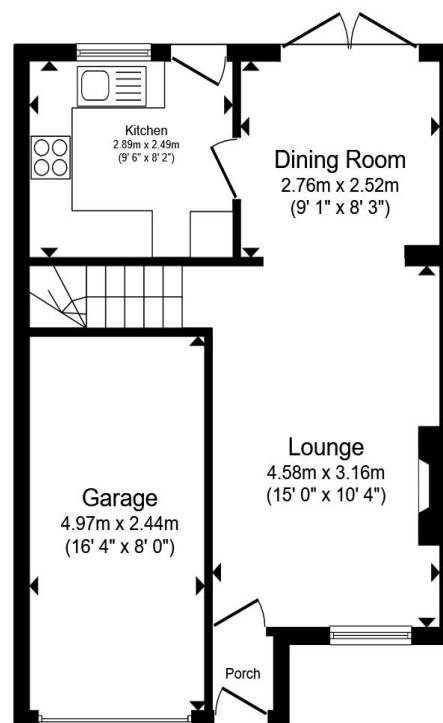

Ground Floor

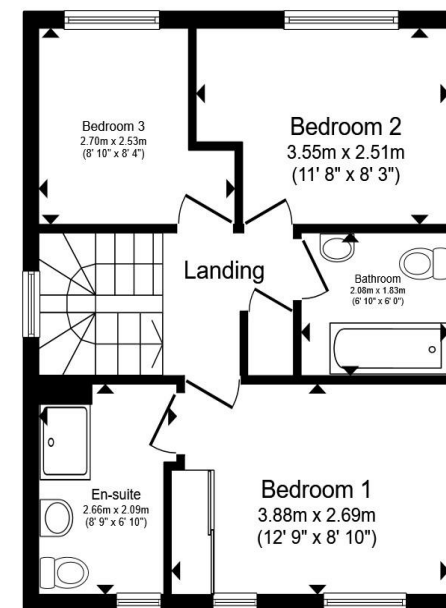

First Floor

Total floor area 86.9 m<sup>2</sup> (935 sq.ft.) approx

This floor plan is for illustrative purposes only. It is not drawn to scale. Any measurements, floor areas (including any total floor area), openings and orientation are approximate. No details are guaranteed, they cannot be relied upon for any purpose and they do not form part of any agreement. No liability is taken for any error, omission or misstatement. A party must rely upon its own inspection(s). Powered by [www.propertybox.io](http://www.propertybox.io)



view this property online [williamhbrown.co.uk/Property/LHS120616](http://williamhbrown.co.uk/Property/LHS120616)



Property Ref:  
LHS120616 - 0006

1. MONEY LAUNDERING REGULATIONS Intending purchasers will be asked to produce identification documentation at a later stage and we would ask for your co-operation in order that there is no delay in agreeing the sale. 2. These particulars do not constitute part or all of an offer or contract. 3. The measurements indicated are supplied for guidance only and as such must be considered incorrect. Potential buyers are advised to recheck measurements before committing to any expense. 4. We have not tested any apparatus, equipment, fixtures or services and it is in the buyers interest to check the working condition of any appliances. 5. Where an EPC, or a Home Report (Scotland only) is held for this property, it is available for inspection at the branch by appointment. If you require a printed version of a Home Report, you will need to pay a reasonable production charge reflecting printing and other costs. 6. We are not able to offer an opinion either written or verbal on the content of these reports and this must be obtained from your legal representative. 7. Whilst we take care in preparing these reports, a buyer should ensure that his/her legal representative confirms as soon as possible all matters relating to title including the extent and boundaries of the property and other important matters before exchange of contracts.

William H Brown is a trading name of Sequence (UK) Limited which is registered in England and Wales under company number 4268443, Registered Office is Cumbria House, 16-20 Hockliffe Street, Leighton Buzzard, Bedfordshire, LU7 1GN. VAT Registration Number is 500 2481 05.

william h brown



0116 251 4131



Leicester@williamhbrown.co.uk



16-18 Halford Street, LEICESTER, Leicestershire,  
LE1 1JB



[williamhbrown.co.uk](http://williamhbrown.co.uk)