



MANOR ROAD NORTH

Hinchley Wood, Esher, Surrey, KT10



A STUNNING PERIOD HOME

A stunning, double-fronted Victorian home in a charming location, with a wealth of character features including high ceilings, feature fireplaces, generously proportioned rooms throughout, and a carriage driveway that enhances the property's impressive frontage.



Local Authority: Elmbridge Borough Council

Council Tax band: H

Tenure: Freehold



KEY FEATURES

- 6,028 sq ft of accommodation
- Self-contained one-bedroom flat
- 0.48-acre plot
- South-east facing garden
- Within walking distance of Hinchley Wood Primary and Secondary Schools
- 0.4 miles from Hinchley Wood village and station
- 1.75 miles from Surbiton station











SURROUNDING AREA

The house is situated near Hinchley Wood, which features a variety of shops. Both Hinchley Wood, Esher and Surbiton stations are within easy reach, offering direct, fast services to London Waterloo. The A3 provides convenient access to central London, the M25, and the South.

Schooling options in the area are excellent, with both Hinchley Wood Primary and Secondary schools in the adjacent road and St Mary's infants close by. The private sector offers esteemed schools such as Surbiton High, Rowan, Shrewsbury House, Milbourne Lodge and Claremont Fan Court which are all easily accessible.

There is a superb range of recreational activities available, including Sandown Park, which offers horse racing, skiing, golf, go-karting, a gym, and squash facilities.

Additionally, the historic Hampton Court Palace and the National Trust-owned Claremont Landscape Garden are close by. Two well-regarded local sports clubs, Surbiton Hockey Club and Long Ditton Cricket Club, are also nearby. The towns of Kingston upon Thames and Guildford are a short distance away, offering a wide array of high-street retailers and department stores.





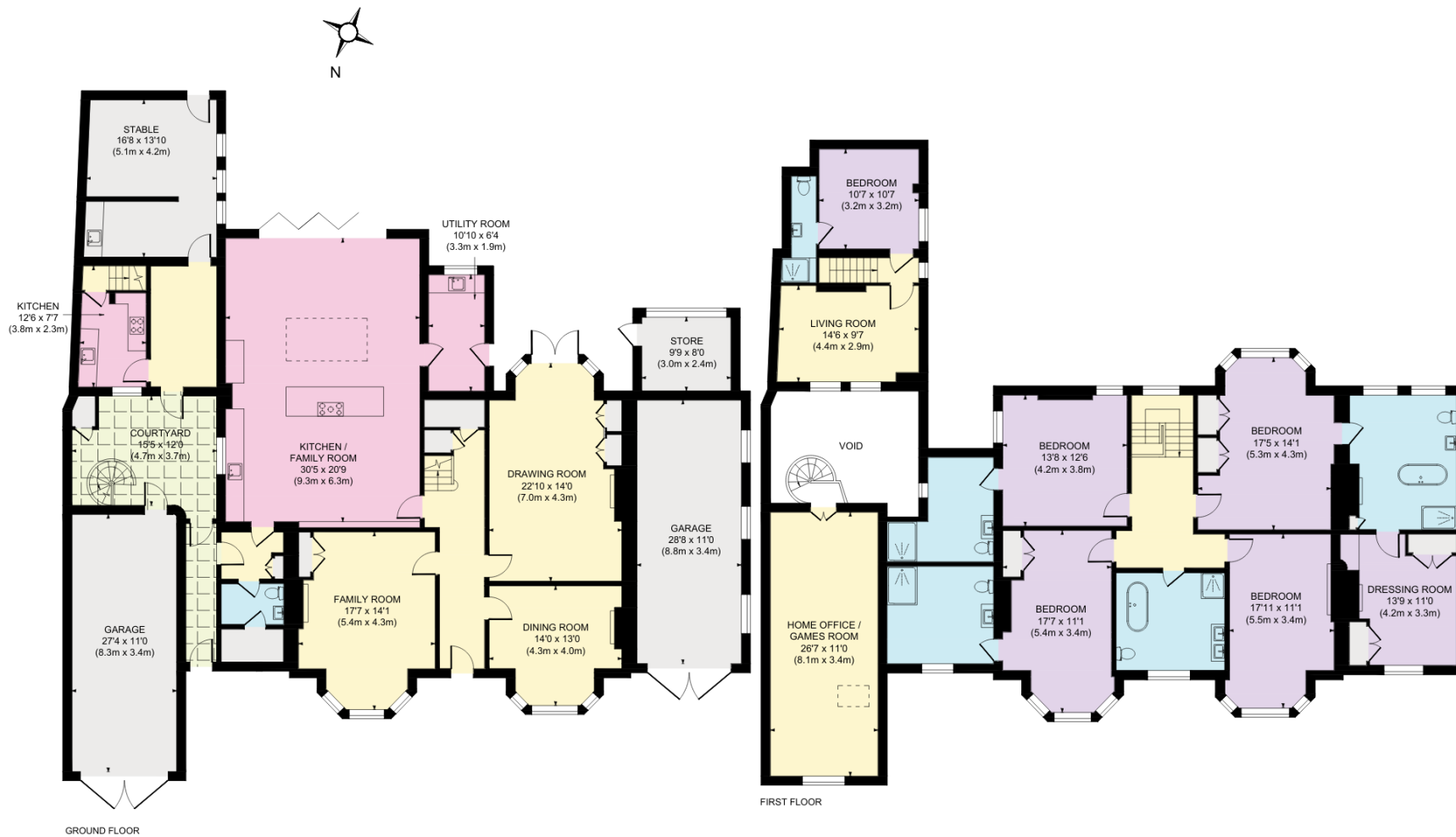

Approximate Gross Internal Area = 560.04 sq m / 6028 sq ft

This plan is for layout guidance only. Not drawn to scale unless stated. Windows and door openings are approximate. Whilst every care is taken in the preparation of this plan, please check all dimensions, shapes and compass bearings before making any decisions reliant upon them. (ID767266)



Adam Burlison

01372 239984

adam.burlison@knightfrank.com

Knight Frank Esher

47 High Street, Esher

Surrey, KT10 9RL

knightfrank.co.uk



Your partners in property

1. Particulars: These particulars are not an offer or contract, nor part of one. You should not rely on statements given by Knight Frank in the particulars, by word of mouth or in writing ("information") as being factually accurate about the property, its condition or its value. Neither Knight Frank nor any joint agent has any authority to make any representations about the property, and accordingly any information given is entirely without responsibility on the part of Knight Frank. 2. Material Information: Please note that the material information is provided to Knight Frank by third parties and is provided here as a guide only. While Knight Frank has taken steps to verify this information, we advise you to confirm the details of any such material information prior to any offer being submitted. If we are informed of changes to this information by the seller or another third party, we will use reasonable endeavours to update this as soon as practical. 3. Photos, Videos etc: The photographs, property videos and virtual viewings etc. show only certain parts of the property as they appeared at the time they were taken. Areas, measurements and distances given are approximate only. 4. Regulations etc: Any reference to alterations to, or use of, any part of the property does not mean that any necessary planning, building regulations or other consent has been obtained. A buyer must find out by inspection or in other ways that these matters have been properly dealt with and that all information is correct. 5. Fixtures and fittings: A list of the fitted carpets, curtains, light fittings and other items fixed to the property which are included in the sale (or may be available by separate negotiation) will be provided by the Seller's Solicitors. 6. VAT: The VAT position relating to the property may change without notice. 7. To find out how we process Personal Data, please refer to our Group Privacy Statement and other notices at <https://www.knightfrank.com/legals/privacy-statement>.

Particulars dated January 2026. Photographs and videos dated January 2026. All information is correct at the time of going to print. Knight Frank is the trading name of Knight Frank LLP. Knight Frank LLP is a limited liability partnership registered in England and Wales with registered number OC305934. Our registered office is at 55 Baker Street, London W1U 8AN. We use the term 'partner' to refer to a member of Knight Frank LLP, or an employee or consultant. A list of members names of Knight Frank LLP may be inspected at our registered office. If you do not want us to contact you further about our services then please contact us by either calling 020 3544 0692, email to marketing.help@knightfrank.com or post to our UK Residential Marketing Manager at our registered office (above) providing your name and address.

