



Shutters Cottage

Chaddesley Corbett, DY10 4QS

Andrew Grant

Shutters Cottage

Lodge Ford Hill, Chaddesley Corbett, DY10 4QS

2 Bedrooms 1 Bathroom 2 Reception Rooms

A rare opportunity to refurbish a characterful two bedroom country cottage with two receptions, set within a generous rural plot.

- Characterful cottage requiring full renovation with two bedrooms and two reception rooms
- Exposed beams, brick fireplaces and cottage windows evoke period charm
- Long mature garden flanked by hedges and trees, extending to around a third of an acre
- Ample scope for improvement and personalisation throughout
- Peaceful rural setting near Chaddesley Corbett with countryside on the doorstep

Shutters Cottage sits within a generous rural plot of around one third of an acre and offers enormous potential for refurbishment. Currently arranged with two reception rooms, a kitchen, cloakroom and utility on the ground floor, the home has two double bedrooms and a first floor bathroom upstairs. Character features include exposed beams, inglenook style fireplaces and cottage windows. The long mature garden runs alongside the lane and is flanked by hedges, providing a private outdoor space with views over the surrounding fields. A wonderful opportunity to create a bespoke rural retreat.

976 sq ft (90.7 sq m)





The kitchen

The kitchen functions as the cooking hub of the home, linking to the dining room. It features a range of base and wall cabinets, long timber work surfaces and a freestanding electric cooker. Exposed timber beams overhead lend character, while a stainless steel sink sits beneath a cottage window looking out to the garden. A doorway leads to the utility, and there is easy access into the dining room.



The dining room

Ideal for family meals and entertaining, the dining room occupies the heart of the ground floor. A rustic brick fireplace with a wood burning stove forms a striking focal point, complemented by tiled flooring and exposed beams across the ceiling. A wide cottage window overlooks the front, while the solid timber front door opens directly into this space. Open access leads into the kitchen.





The living room

The living room is a relaxing retreat for everyday gatherings and quiet evenings. Dominating the room is an ornate cast iron fireplace with a timber surround and tiled hearth, flanked by a built-in brick window seat. Cottage casement windows to the front and side frame views over the surrounding fields, while exposed ceiling beams add rustic character. A door leads through to the inner hall and the cloakroom.





The cloakroom

A handy cloakroom beneath the stairs provides a convenient facility for guests. It contains a WC and compact wash basin. An old window with shutters looks through to the kitchen, and timber shelving has been fitted into the stair void.



The primary bedroom

The primary bedroom is a spacious first floor double room offering a restful retreat. A sloping ceiling and exposed beams give it cottage charm, while a wide window with a deep sill overlooks the garden. A latch door opens through to the landing, and a wall mirror enhances the sense of space. Direct access leads through to the adjoining bathroom.





The second bedroom

The second bedroom is also a generous double room with a distinctive cottage feel. Exposed beams on the vaulted ceiling and a pretty cast iron fireplace create character, while dual aspect cottage windows frame views of the garden and surrounding fields. A shelf is mounted on the wall for display or storage.



The bathroom

The family bathroom caters for both bedrooms upstairs, offering bathing facilities. It comprises a panelled bath with telephone style mixer tap, a pedestal wash basin and a low level WC. A circular mirror and a window brighten the space, and the sloping ceiling features a timber beam.



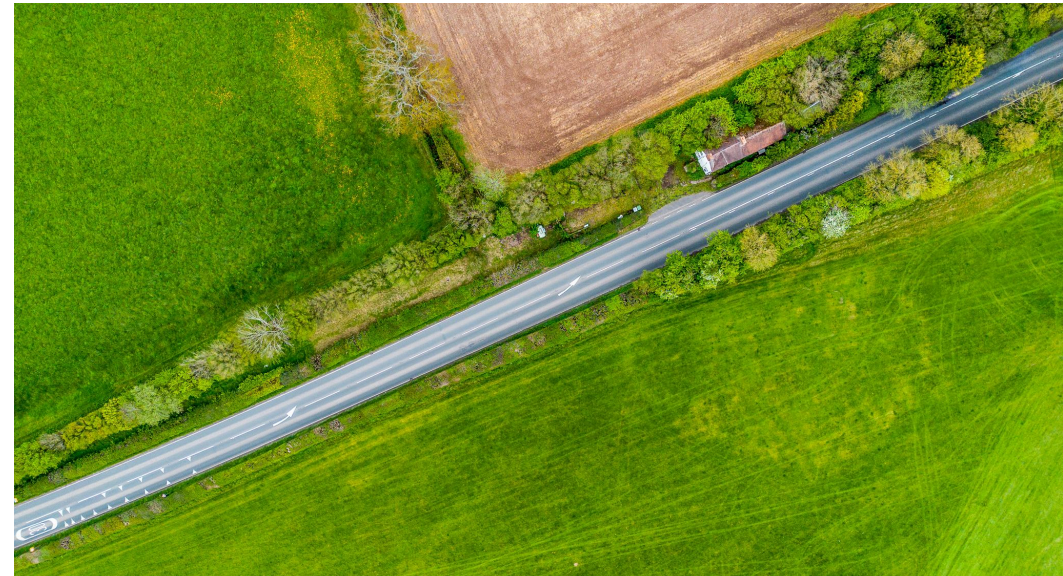

The garden

Outside, the garden offers a substantial stretch of level lawn for families and wildlife. The long plot runs alongside the lane and is enclosed by mature hedgerows and trees, creating a sense of privacy. Open views across neighbouring fields enhance the rural feel and there is ample scope for landscaping and vegetable beds.

Location

Situated on Lodge Ford Hill close to the popular village of Chaddesley Corbett, Shutters Cottage enjoys a tranquil rural setting with fields to the front and rear. Everyday amenities including a village store, pubs and a primary school can be found nearby, while the market towns of Kidderminster and Bromsgrove provide a wider range of facilities. The surrounding countryside offers superb walking, riding and cycling, and there are convenient road links towards Worcester and the West Midlands conurbation.

Services

The property benefits from mains electricity and water. Central heating is provided by Liquid Propane Gas and there is a private septic tank for drainage.

Broadband Speed: Standard broadband available. Download speeds up to 28 Mbps and upload speeds up to 3 Mbps (source: Ofcom checker).

Mobile Coverage: Likely available from EE, O2, Three and Vodafone. (source: Ofcom checker).

Flood Risk (Long-term forecast): According to the Environment Agency's long-term flood risk data, the property is currently at very low risk for river and surface water flooding.

Council Tax

The Council Tax for this property is Band D.



Lodge Ford Hill

Approximate Gross Internal Area
Ground Level = 48.6 sq m / 523 sq ft
First Level = 42.1 sq m / 453 sq ft
Total = 90.7 sq m / 976 sq ft

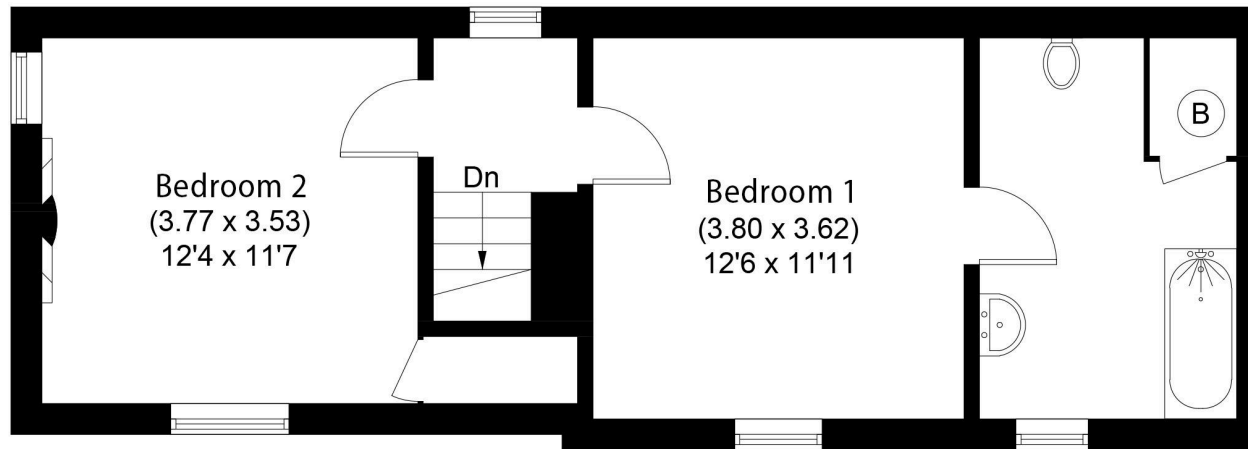

First Level

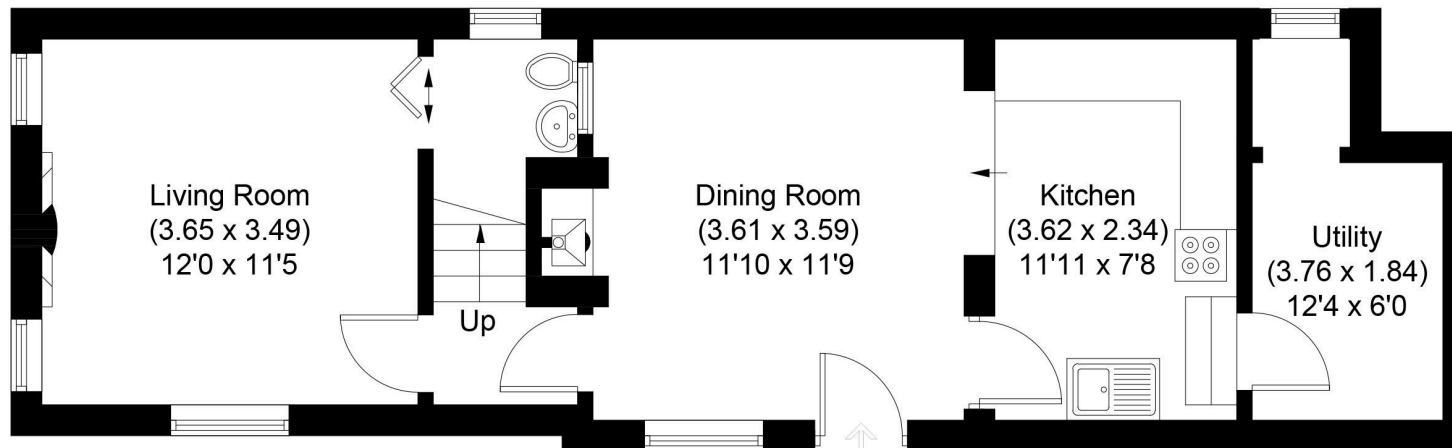

Ground Level

ENTRY

Illustration for identification purposes only, measurements are approximate, not to scale.



Andrew Grant

T. 01905 734734

E. hello@andrewgrant.com

andrewgrant.com