

HENDERSON CONNELLAN

ESTATE AGENTS

Springfield Road, Kettering, NN15

"Well Placed"

"Well Placed"

This bay fronted mid mews home is conveniently located a short walk from Wicksteed Park, the mainline railway station, and the town centre as well as schools and bus routes. The stylish interior includes an entrance hall, living room with attractive fireplace and the warmth of a woodburner, the dining room can combine as a family room and leads to the kitchen with select integrated appliances. Upstairs the landing leads to a principal bathroom with white suite and three bedrooms, two of which are generous double rooms. Mostly UPVC double glazing and electric heating complete the inside. Outside the fore garden is set behind mature hedging and the lovely rear garden is great size with outside WC, large patio partially covered for all weather outdoor living and a generous lawn with colourful plantings. A great home and location!

Living Room - 4.8m x 4.47m (15'9" x 14'8")

Kitchen/Breakfast Room - 4.47m x 2.44m (14'8" x 8'0")

Conservatory - 3.91m x 3.51m (12'10" x 11'6")

Bedroom 1 - 4.06m x 2.57m (13'4" x 8'5")

Bedroom 2 - 3.25m x 2.59m (10'8" x 8'6")

Bedroom 3 - 2.21m x 1.75m (7'3" x 5'9")

Bathroom - 1.83m x 1.83m (6'0" x 6'0")

- Mostly UPVC double glazing and electric heating
- Living room with woodburner
- Dining/Family room
- Kitchen with integrated oven, hob, dishwasher and Fridge/Freezer
- Three Bedrooms
- Principal bathroom with white suite.
- EPC RATING: PENDING
- COUNCIL TAX: A

Council Tax Band: A

Tenure: Freehold





Ground Floor

Approx. 39.4 sq. metres (424.3 sq. feet)

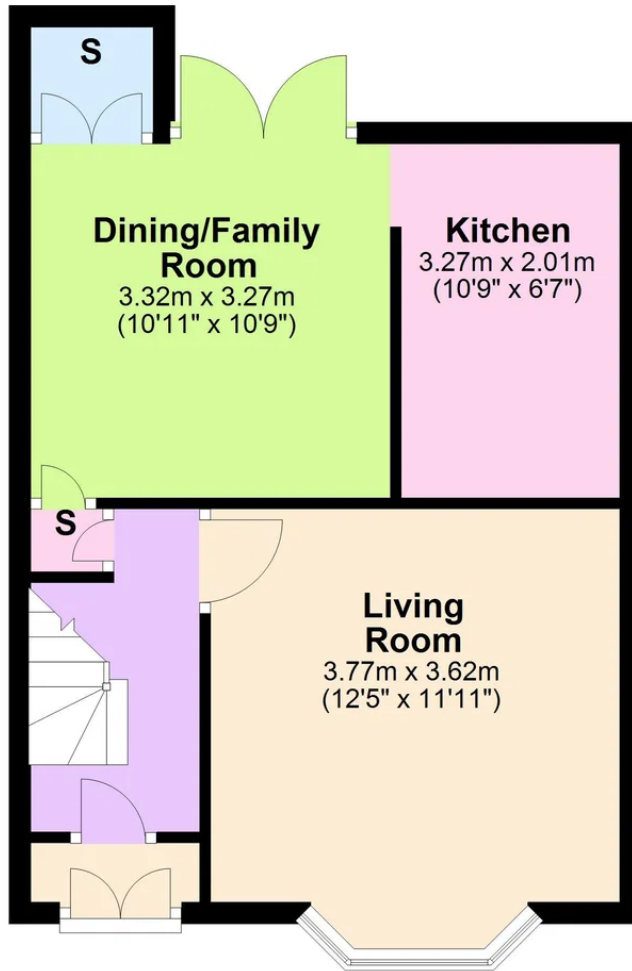

First Floor

Approx. 37.2 sq. metres (399.9 sq. feet)

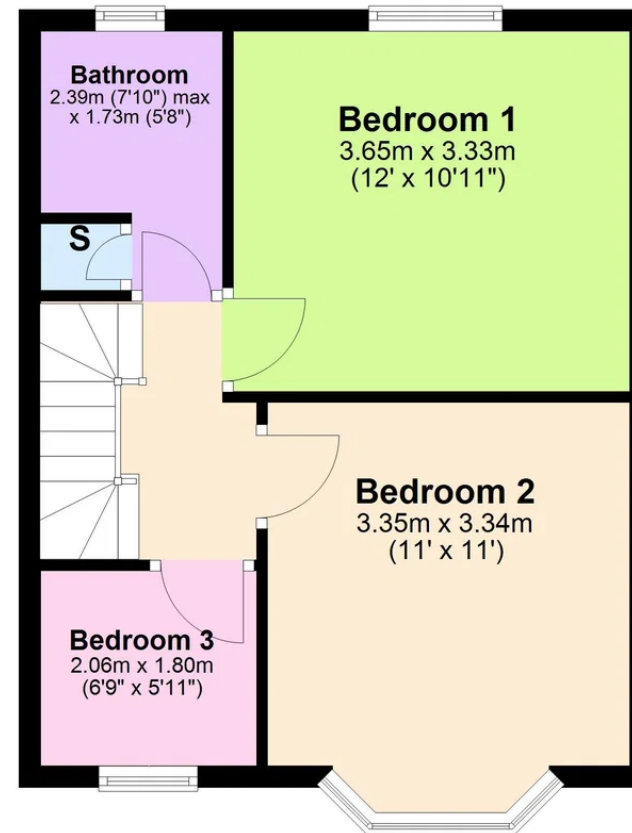

Total area: approx. 76.6 sq. metres (824.2 sq. feet)