



Poynders Gardens, SW4

£2,750 Per week

Set on the second floor of a secure purpose built block, this spacious flat in Clapham offers three bedrooms, a large reception room, separate kitchen, shower room and WC.

Located for the local amenities of Clapham South and Balham with access to various supermarkets, bars and restaurants, along with the open spaces of Clapham Common.

Features

- Three Double Bedrooms
- Second Floor Flat
- Spacious Reception Room
- Separate Kitchen
- Separate WC
- Close To Transport

Poynders Gardens,
London, SW4

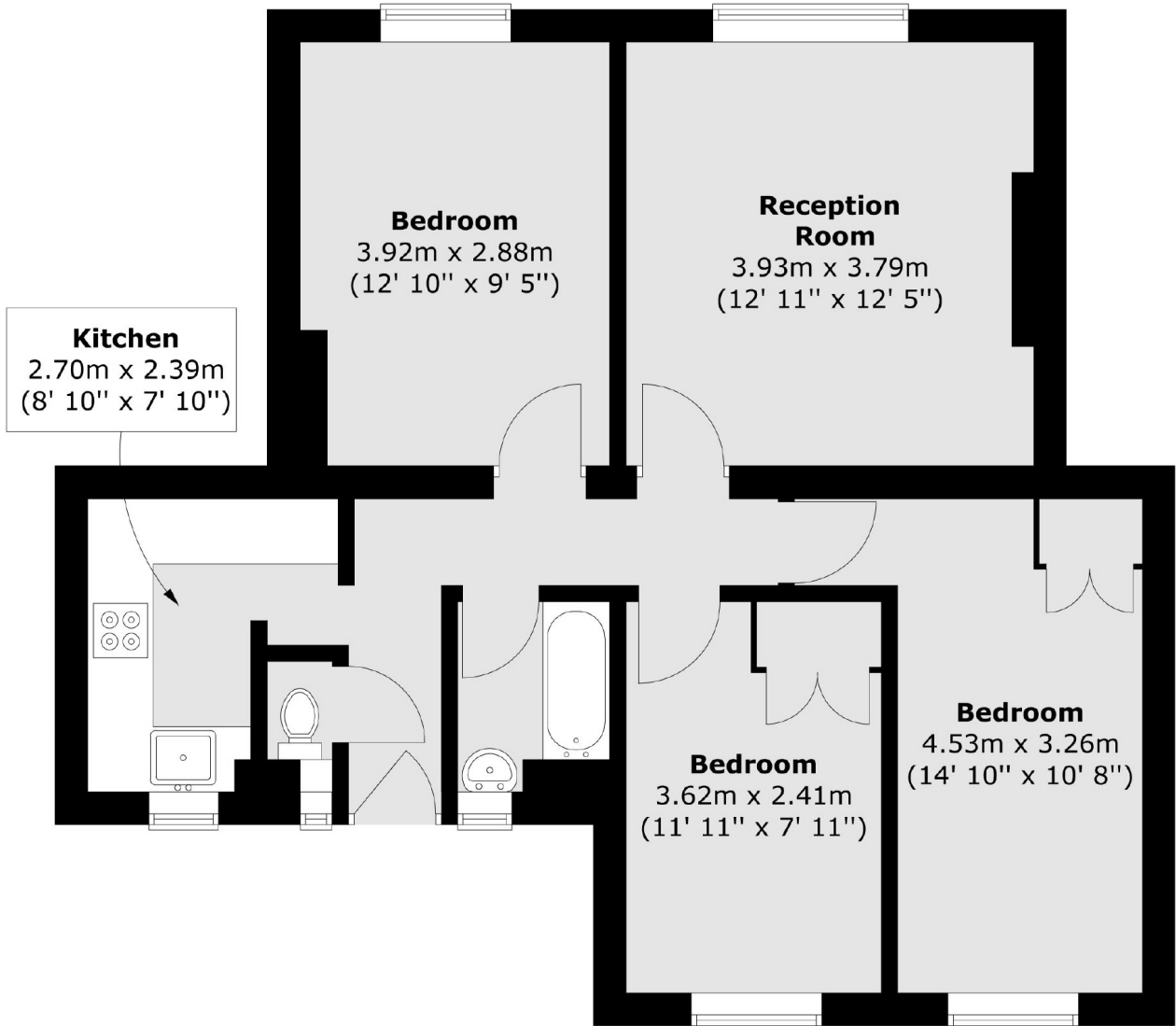

Total area (approx.) : 63.5 sq. m (683 sq. ft)