



Naylors

ESTATE AGENTS CHARTERED SURVEYORS



3 Brook Terrace

Medbourne, Market Harborough, LE16 8DN

£1,000 Per Month

An opportunity to rent this delightful, one bedroom property in the village of Medbourne.

The property comprises: Living/Dining Room, Kitchen, WC, Bedroom, Bathroom and gardens to front and rear. Off road parking is available for one vehicle.

Viewing

Please contact our Market Harborough Office on 01858 450020 if you wish to arrange a viewing appointment for this property or require further information.



1



1



1



E

Floor Plan

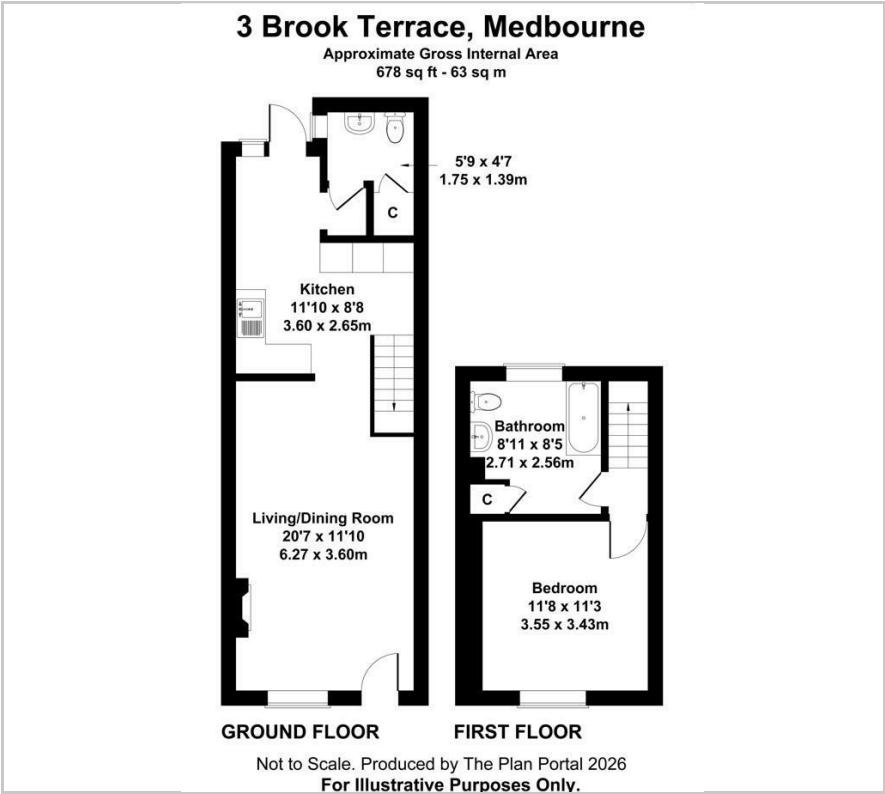

Area Map



Energy Efficiency Graph

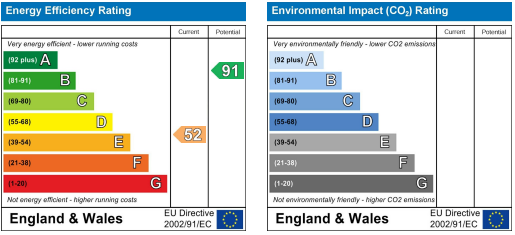

These particulars, whilst believed to be accurate are set out as a general outline only for guidance and do not constitute any part of an offer or contract. Intending purchasers should not rely on them as statements of representation of fact, but must satisfy themselves by inspection or otherwise as to their accuracy. No person in this firm's employment has the authority to make or give any representation or warranty in respect of the property.