



Connells

Cheveley Park
Grantham



Property Description

Connells are delighted to bring to the market this One Bedroom Park Home with a Driveway. The Park Home site is a retirement complex which has a bus route directly outside the site and is located on the edge of Grantham with Direct Access straight out to the A1 South Bound & is only minutes away from the towns full amenities such as Shops, Supermarkets, Schools, Restaurants/Bars, Cinema, Cafes, Butchers, Doctors, Bus & Train Station with direct links to London King's Cross in just over an hour.

Entrance Hall

6' 8" x 4' 3" (2.03m x 1.30m)

Lounge

11' 10" x 10' (3.61m x 3.05m)

Kitchen

8' 8" x 6' 8" (2.64m x 2.03m)

Bedroom One

11' 10" x 11' 3" (3.61m x 3.43m)

Bathroom

7' 4" x 5' 4" (2.24m x 1.63m)









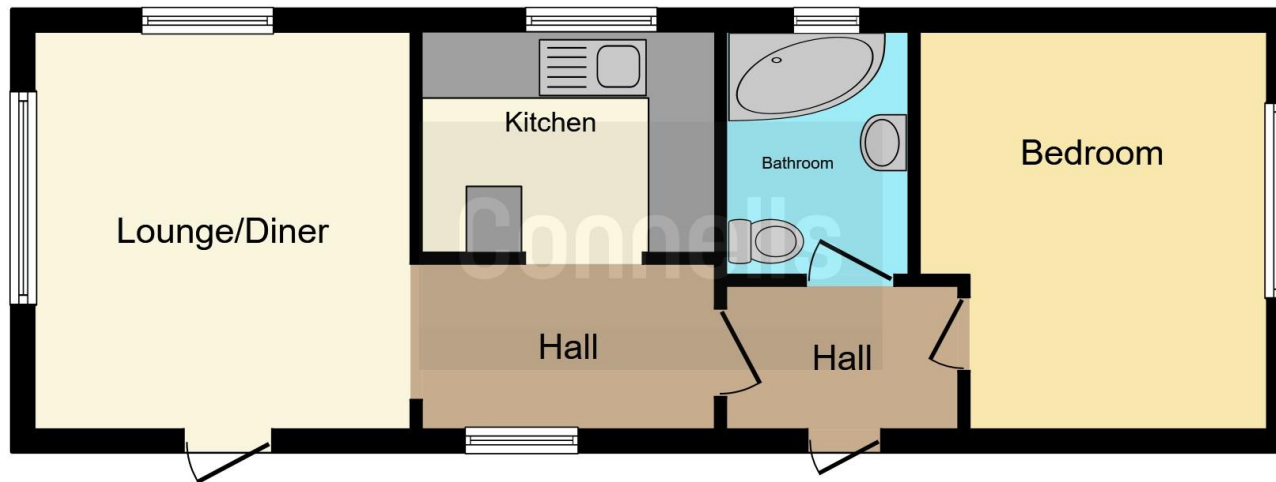

This floor plan is for illustrative purposes only. It is not drawn to scale. Any measurements, floor areas (including any total floor area), openings and orientation are approximate. No details are guaranteed, they cannot be relied upon for any purpose and they do not form part of any agreement. No liability is taken for any error, omission or misstatement. A party must rely upon its own inspection(s). Powered by www.focalagent.com

To view this property please contact Connells on

T 01476 590 050
E grantham@connells.co.uk

2 Watergate
GRANTHAM NG31 6PR

EPC Rating: Exempt
Council Tax Band: A

Tenure:

view this property online connells.co.uk/Property/GRM308686

We are currently awaiting Tenure details. For further information please contact the branch. Please note additional fees could be incurred for items such as leasehold packs.



1. MONEY LAUNDERING REGULATIONS Intending purchasers will be asked to produce identification documentation at a later stage and we would ask for your co-operation in order that there will be no delay in agreeing the sale. 2. These particulars do not constitute part or all of an offer or contract. 3. The measurements indicated are supplied for guidance only and as such must be considered incorrect. Potential buyers are advised to recheck measurements before committing to any expense. 4. We have not tested any apparatus, equipment, fixtures, fittings or services and it is in the buyers interest to check the working condition of any appliances.

Connells Residential is registered in England and Wales under company number 1489613, Registered Office is Cumbria House, 16-20 Hockliffe Street, Leighton Buzzard, Bedfordshire, LU7 1GN. VAT Registration Number is 500 2481 05.

See all our properties at www.connells.co.uk | www.rightmove.co.uk | www.zoopla.co.uk

Property Ref: GRM308686 - 0009