



# Alexander Hudson Estates

---

Sales Particulars



# Alexander Hudson Estates

West Farm Avenue, Longbenton, NE12





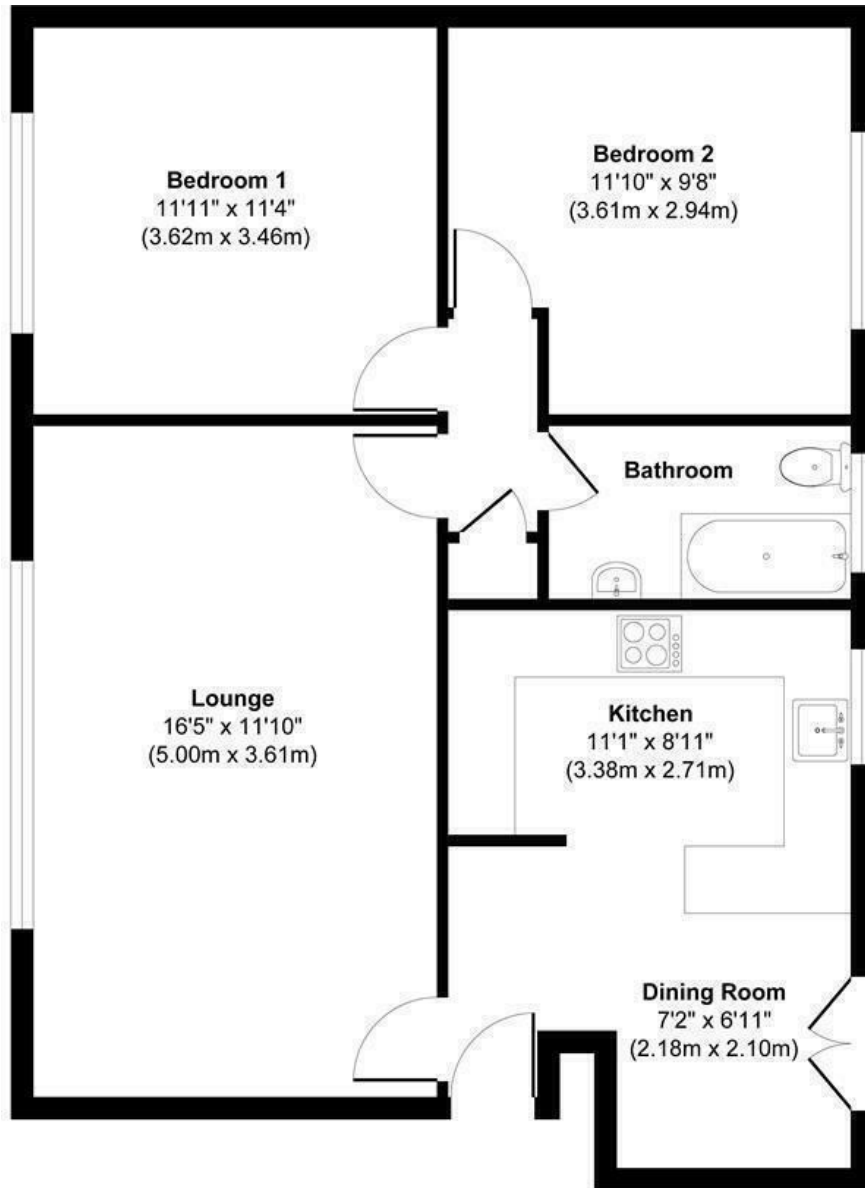

**Floor Plan**

**Approx. Gross Internal Floor Area 864 sq. ft / 70.99 sq. m**

Illustration for identification purpose only, measurements approximate and not to scale, unauthorized reproduction is prohibited. All rights reserved for Alexander Hudson Estates

**Alexander Hudson Estates**

## The Property

Alexander Hudson Estates is delighted to welcome to the market this stunning, two-bedroom first floor apartment, ideally located in the ever popular residential area of Longbenton, NE12.

Upon entering the property, you are greeted by a spacious and welcoming hallway, living room, kitchen, dining area, two bedrooms and bathroom.

Externally, residents benefit from well-maintained communal grounds and ample on-street parking. The property is ideally positioned just a short walk from Longbenton Metro Station, offering direct and reliable links to Newcastle City Centre and surrounding areas. Whether commuting for work or exploring the city, the location is exceptionally convenient.

Longbenton itself is a vibrant and well-connected community, with a range of local amenities close by including shops, supermarkets, restaurants, and traditional pubs. Well-regarded schools, healthcare facilities, and green open spaces further enhance the area's appeal, making it a popular choice for families and professionals alike.

Leasehold  
Council Tax: A  
EPC Rating: 74





---

Alexander Hudson Estates  
The Printworks  
20 Arrow Close  
NE12 6QN

0191 268 7433  
[sales@alexanderhudson.co.uk](mailto:sales@alexanderhudson.co.uk)