



Taylor's

OLDBURY, Bowness House

Offers In Region Of £99,950

🛏️ 2 🚿 1 🛋️ 1

- Two Double Bedrooms
- Spacious Living Room
- Balcony
- Bathroom with shower
- Kitchen with oven and hob
- Communal gardens
- No upward chain
- Convenient for commuting



Well proportioned first floor flat with TWO DOUBLE BEDROOMS. Offered for sale with NO UPWARD CHAIN and having gas central heating and PVC double glazing. Communal ground floor entrance with intercom and stairs to first floor - Hall, Good size Living Room with BALCONY, Kitchen with oven and hob, Bathroom with Shower.

All main services connected. Tenure Leasehold [125yrs from 1st April 1990], 89 yrs remaining. Ground Rent £10 pa. Previous Service charge £116.08 half year subject to variation. Council Tax Band A. EPC - . Broadband/ Mobile coverage: <https://checker.ofcom.org.uk/en-gb/broadband-coverage>. Construction brick, block having flat roof. Long term flood risk surface water very low, rivers very low.

Communal Ground Floor Hall With intercom entrance system and staircase to the first floor, **Hall** With built in cupboard, **Spacious Living Room** - 5.92m x 3.18m (19'5" x 10'5") With double glazed windows to the side and double glazed door and window to the BALCONY, fireplace with electric fire, **Kitchen** - 2.29m x 2.29m (7'6" x 7'6") Having floor and wall cupboards, oven, hob and cooker hood. Two useful Cupboards one housing the central heating boiler, **Bedroom One** - 3.61m x 3.53m (11'10" x 11'7"), **Bedroom Two** - 3.61m x 3m (11'10" x 9'10"), **Bathroom** - 2.24m x 1.8m (7'4" x 5'11") Having panel bath with Triton shower above, handbasin and WC, **Communal Gardens**



Ground Floor

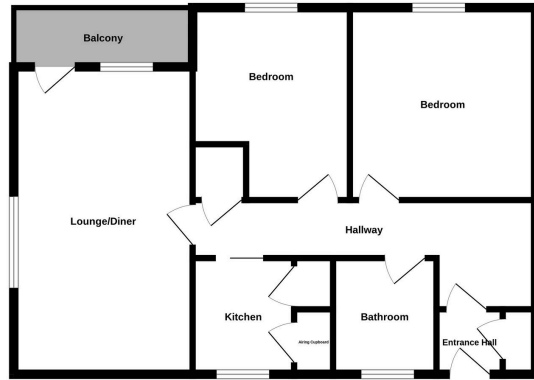

Measurements are approximate. See also EPC. All other figures only valid with Valuation CD020

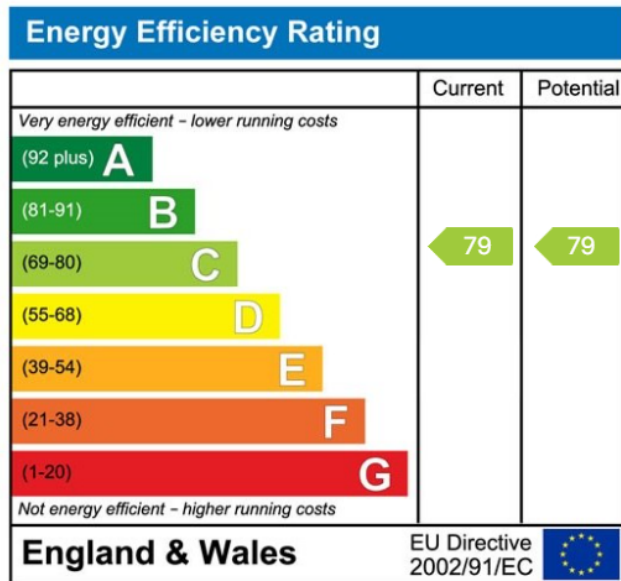

MISREPRESENTATION ACT 1967: These particulars do not constitute any part of an offer or a contract. Whilst every care is taken to ensure accuracy, no responsibility for errors or misdescription is accepted. Any intending purchaser must satisfy themselves by inspection or otherwise as to the correctness of each of the statements in these particulars. The vendor does not make nor give, and neither Taylors nor any person in their employment has any authority to make or give any representation or warranty whatsoever about this property. As the seller's estate agents, we are not surveyors or conveyancing experts, and we cannot comment on the property's condition or issues relating to the title or other legal issues that may affect this property unless we have been made aware of such matters. Interested parties should employ professionals to make such enquiries before making transactional decisions. **EPC:** can be supplied free of charge. **CONSUMER PROTECTION REGULATIONS (2008):** These particulars have been prepared with care and approved by the vendors (where possible) but are intended as a guide only, with measurements being approximate and usually the maximum size, which may include alcoves, recesses or otherwise as described, and you must NOT rely on them for any other purpose. The appearance of an item in any photograph does not mean that it forms part of the property or sale price. **FIXTURES AND FITTINGS:** Only those items specifically mentioned in these sales particulars are included in the sale price. Taylors have NOT tested any apparatus, equipment, fixture or fitting and cannot verify they are in working order or fit for their purpose. **PLANNING PERMISSION / BUILDING REGULATIONS:** Any reference to the property being extended, altered or converted in any way does not infer that planning permission or building regulations have been granted or applied for, nor do Taylors accept any responsibility for such not having been obtained. **FLOOR PLAN:** This plan is for illustrative purposes only. The services, systems and appliances shown have not been tested and no guarantee as to their operability or efficiency can be given.