



## HARROW ROAD, NW10

**£2,400 pcm**

Designed by an acclaimed developer, this bright and spacious 600 sq/ft first-floor apartment blends modern luxury with bespoke finishes. The property features an elegant Italian-designed kitchen with integrated Siemens appliances, high-end custom furniture, a private outdoor balcony and lush communal gardens.

- Modern Apartment
- Private Balcony
- Secure Bike Storage
- Lush Communal Garden



## ABOUT THE HOME

Situated in the landmark Chamberlayne development in prime Kensal Rise, the property offers a vibrant city lifestyle on your doorstep. Residents enjoy tranquil communal landscaped gardens while living just five minutes from Kensal Rise Station and a short distance from boutique cafes, bars, and restaurants.





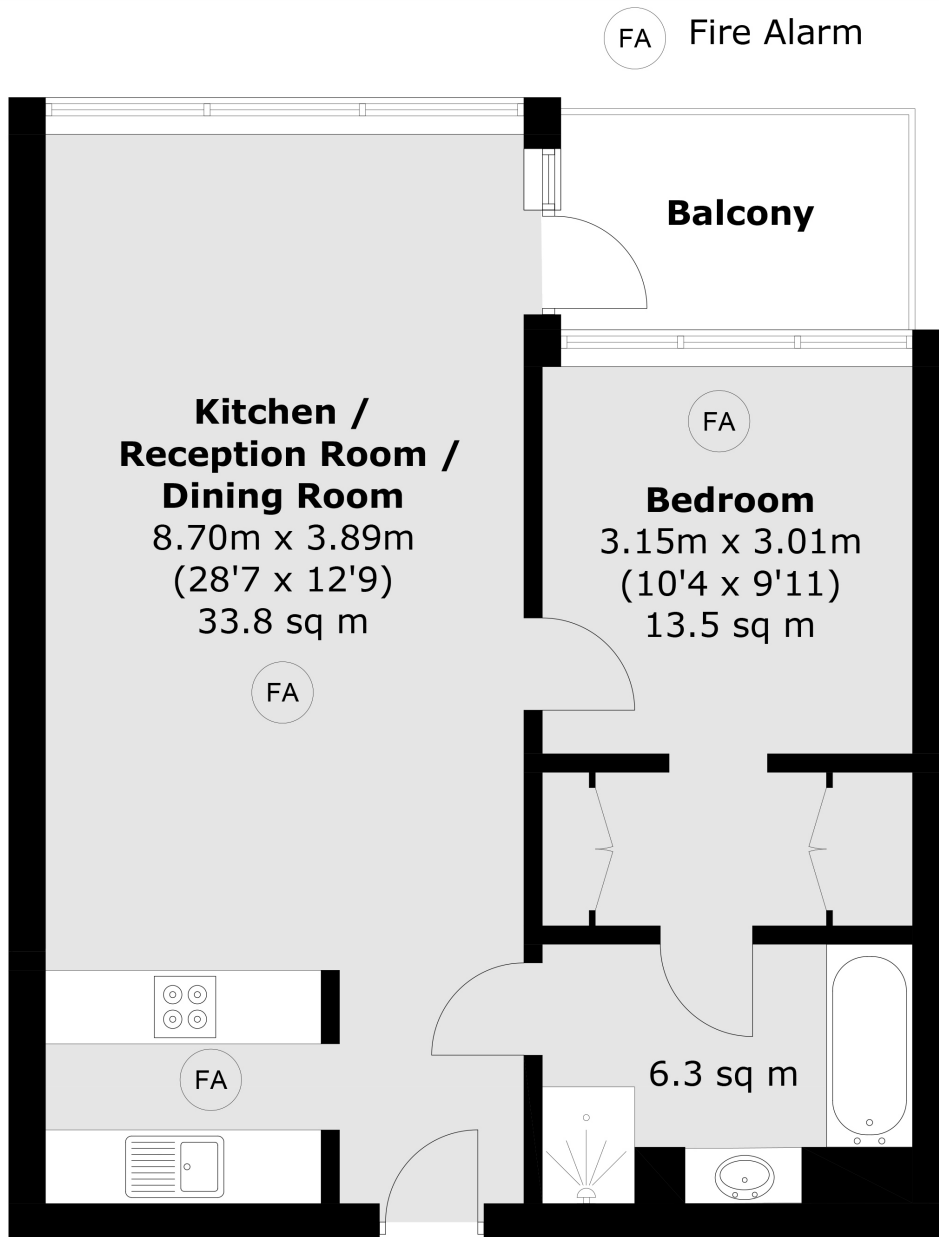

## First Floor

Total area (approx.): 55.6 sq. m (598.4 sq. ft)  
Balcony area: 4.9 sq. m (52.7 sq. ft)

### LiFE RESIDENTIAL

203 Trentham Court, Victoria  
Road, London, W3 6BT  
Sales: 020 3668 1112  
Lettings: 020 3668 1111

Energy Rating: B. We aim to make our particulars both accurate and reliable. However they are not guaranteed; nor do they form part of an offer or contract. If you require clarification on any points then please contact us, especially if you're traveling some distance to view. Please note that appliances and heating systems have not been tested and therefore no warranties can be given as to their good working order.