



**14, Rocke Street, Shrewsbury, SY3 7PY**  
£900 Per Month



14, Rocke Street, Shrewsbury, SY3 7PY

**£900 Per Month**

VIRTUAL TOUR AVAILABLE - Spacious two bedroom Victorian mid terraced house in a convenient location to the south of Shrewsbury town centre and providing excellent access to road links.

Available: 19/06/2026

## Description

Comprising: Living Room, Dining Room, Galley Kitchen with Oven & Hob and Fridge / Freezer, Two Double Bedrooms, Bathroom with Shower, Rear Garden, Shed. Gas central heating, double glazing. Street Parking. EPC D



Unfurnished

Council Tax Band: B

Available: 19th June 2026

EPC: D

## Floor Plans

### Ground Floor

Approx. 40.2 sq. metres (433.1 sq. feet)

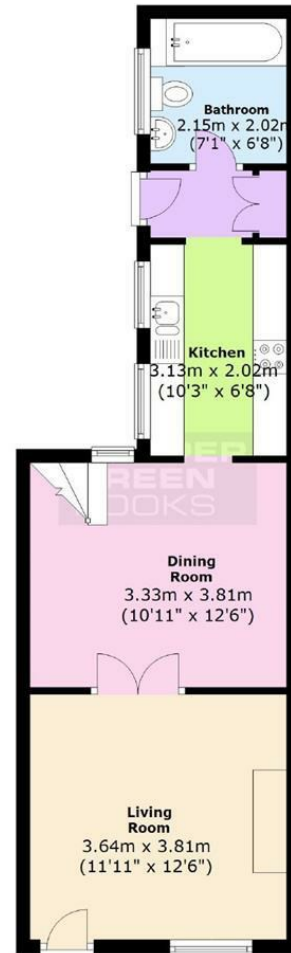

### First Floor

Approx. 26.9 sq. metres (289.9 sq. feet)

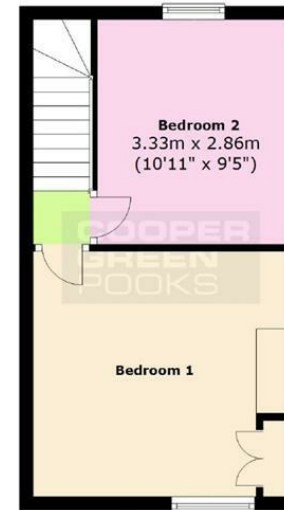

Total area: approx. 67.2 sq. metres (723.1 sq. feet)

We accept no responsibility for any mistake or inaccuracy contained within the floorplan. The floorplan is provided as a guide only and should be taken as an illustration only. The measurements, contents and positioning are approximations only and provided as a guidance tool and not an exact replication of the property.

Plan produced using PlanUp.

These particulars, whilst believed to be accurate are set out as a general outline only for guidance and do not constitute any part of an offer or contract. Intending purchasers should not rely on them as statements of representation of fact, but must satisfy themselves by inspection or otherwise as to their accuracy. No person in this firm's employment has the authority to make or give any representation or warranty in respect of the property.