



CHRIS MACSWEENEY POWERED BY exp TM UK

@ chris.macsweeney@exp.uk.com

chrismacsweeney.exp.uk.com

07468 48 88 18

Parachute Grove, Henlow, Bedfordshire

£357,500

🛏️ 2 🚿 1 🚗 1

- Semi Detached Home Within Walking Distance to Arlesey Mainline Station
- Immaculate Order Throughout
- Small and Private Cul-De-Sac Location
- Fitted Kitchen/Diner
- Two Big Double Bedrooms
- Downstairs WC
- Allocated Driveway in Front of Property For Two Cars
- Electric Car Charging
- Private and Enclosed, South-East Facing Rear Garden
- Short Walk to Schools and Shops



A fabulous semi-detached home, located in a small and private cul-de sac, in the heart of Henlow village. Quote reference CM0245.





Parachute Grove, Henlow

Approximate Gross Internal Area
842 sq ft - 78 sq m

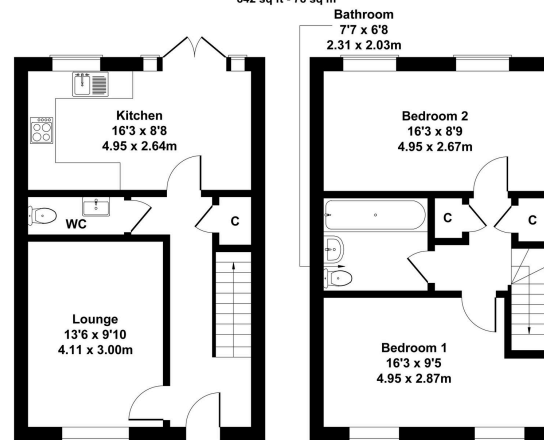

GROUND FLOOR

FIRST FLOOR

Not to Scale. Produced by The Plan Portal 2025
For Illustrative Purposes Only.



Score	Energy rating	Current	Potential
92+	A		96
81-91	B	84	
69-80	C		
55-68	D		
39-54	E		
21-38	F		
1-20	G		

eXp World UK Ltd is a registered company at Level 37, 25 Canada Square, London, E14 5LQ.

Registered company number is 12016573. VAT Registration Number is 327 4120 29