



RE/MAX

PROPERTY HUB



30 Berrys Wood, Newton Abbot, TQ12 1UP

Asking price £250,000

Situated in a quiet cul-de-sac within the sought-after Bradley Barton area, this semi-detached home enjoys a convenient location close to local schools, shops and regular bus services. The nearby market town of Newton Abbot offers an extensive range of amenities, including shopping facilities, a cinema, library, doctors' surgeries, dentists, leisure centre, gyms, pubs and restaurants. The property also benefits from excellent transport links, with the main railway line to London Paddington and easy access to Torbay, Exeter and Plymouth.

The accommodation comprises an entrance hall, spacious lounge, separate dining room, kitchen and a ground-floor cloakroom. Upstairs, there are three well-proportioned bedrooms together with a family bathroom and separate WC.

Further features include electric heating, uPVC double-glazed windows, front and rear gardens, and a garage located in a nearby block.

Floor Plan

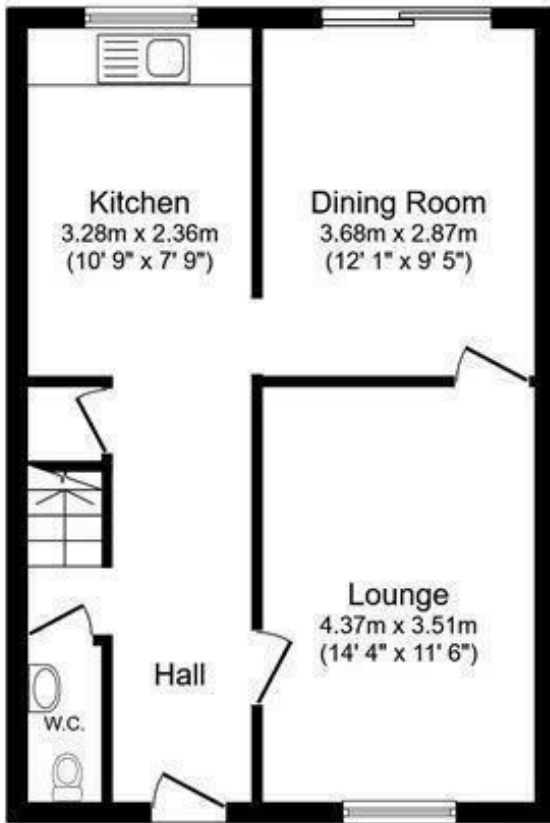

Ground Floor
 Floor area 43.3 sq.m. (466 sq.ft.)

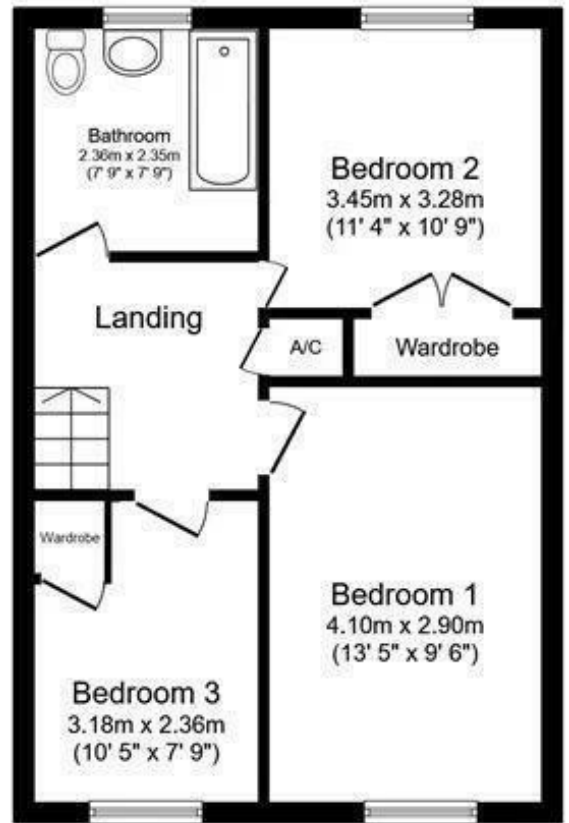

First Floor
 Floor area 43.3 sq.m. (466 sq.ft.)

Total floor area: 86.7 sq.m. (933 sq.ft.)

This floor plan is for illustrative purposes only. It is not drawn to scale. Any measurements, floor areas (including any total floor area), openings and orientations are approximate. No details are guaranteed, they cannot be relied upon for any purpose and do not form any part of any agreement. No liability is taken for any error, omission or misstatement. A party must rely upon its own inspection(s). Powered by www.Propertybox.io

Area Map

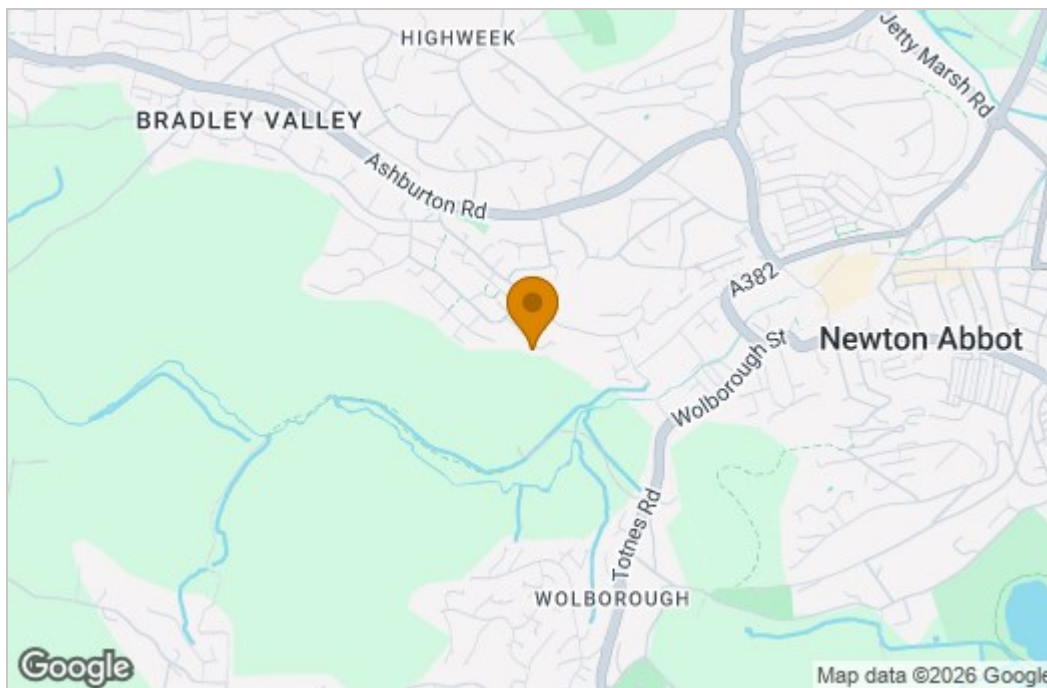

Energy Efficiency Graph

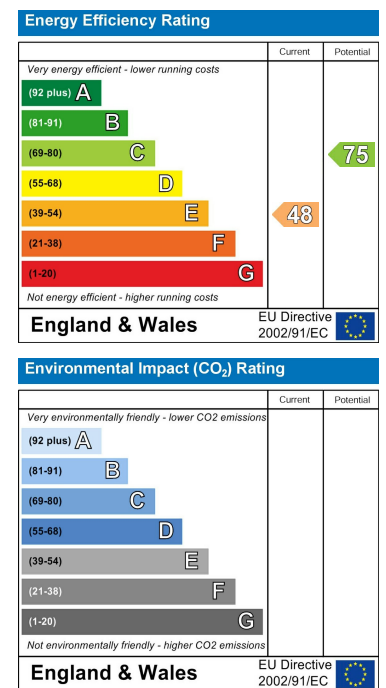

These particulars, whilst believed to be accurate are set out as a general outline only for guidance and do not constitute any part of an offer or contract. Intending purchasers should not rely on them as statements of representation of fact, but must satisfy themselves by inspection or otherwise as to their accuracy. No person in this firm's employment has the authority to make or give any representation or warranty in respect of the property.