



29 Juniper Close
Bridgwater, Somerset, TA6 4ER

Brightest move

Brightest move

£250,000



Brightestmove are delighted to offer for sale this semi-detached house which is situated just off Eastern Avenue on the eastern outskirts of Bridgwater. This three bedroom home has recently been refurbished throughout including a new kitchen and bathroom . In addition new flooring has been laid throughout .

The double glazed accommodation is warmed by modern high retention electric heaters and briefly comprises entrance hallway, living room ,kitchen diner and large conservatory to the ground floor with three bedrooms and bathroom upstairs.

In addition there are gardens to front ,side and rear and off street parking for one vehicle.

Juniper Close is situated within 750 metres of the local primary school and convenience store with a wider range of amenities in the town centre of Bridgwater which is less than a mile away



Bridgwater is an emerging town situated in the heart of the borough of Sedgemoor and within 11 miles of Taunton and 38 miles of Bristol. The town which is famed for its annual carnival is a thriving place with many new jobs being created in recent years.

For more information or an appointment to view please contact the vendors sole agents.

SERVICES: Mains, electricity, water and drainage

HEATING: Electric high retention storage radiators

TENURE: Freehold

COUNCIL TAX BAND: B

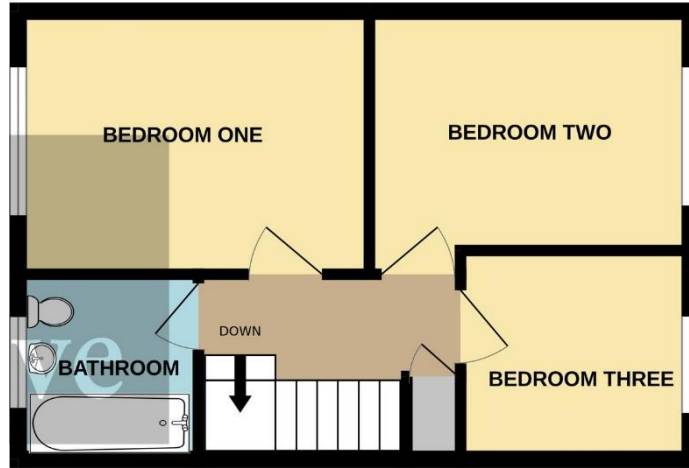

- Living Room** 14' 0" x 12' 06" (4.27m x 3.81m)
- Kitchen/Diner** 15' 09" x 9' 0" (4.8m x 2.74m)
- Conservatory** 14' 01" x 13' 05" (4.29m x 4.09m)
- Bedroom One** 12' 09" x 9' 0" (3.89m x 2.74m)
- Bedroom Two** 10' 05" x 8' 03" (3.18m x 2.51m)
- Bedroom Three** 7' 04" x 7' 02" (2.24m x 2.18m)

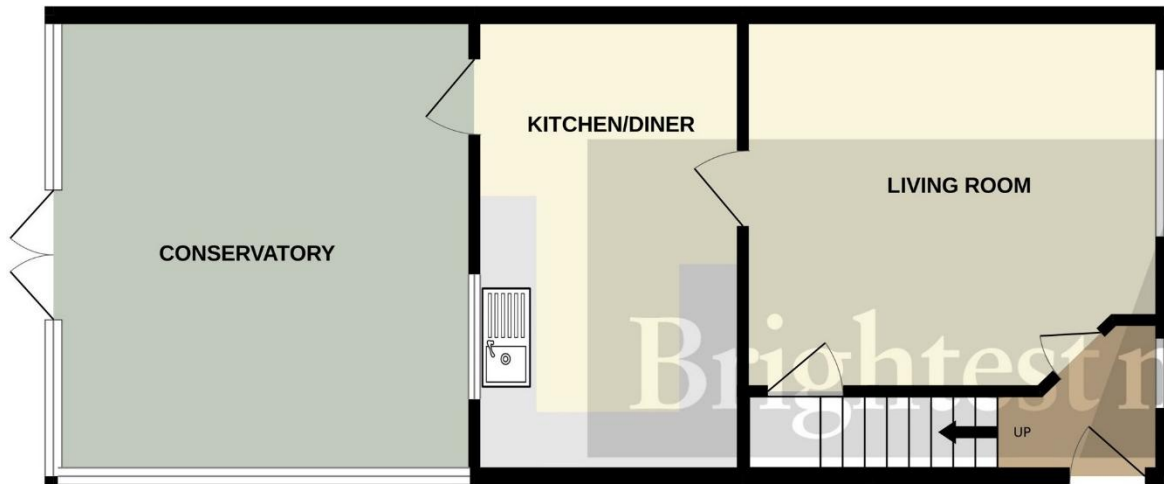

Score	Energy rating	Current	Potential
92+	A		
81-91	B		86 B
69-80	C	69 C	
55-68	D		
39-54	E		
21-38	F		
1-20	G		

No statement in these details is to be relied upon as representation of fact, and purchasers should satisfy themselves by inspection or otherwise as to the accuracy of the statements contained within. These details do not constitute any part of any offer or contract. CMH Southwest limited trading as Brightest Move and their employees and agents do not have any authority to give warranty or representation whatsoever in respect of this property. These details and all statements herein are provided without any responsibility on the part of CMH Southwest limited trading as Brightest Move or the vendors. CMH Southwest limited trading as Brightest Move has not tested the equipment or central heating system mentioned in these particulars and the purchasers are advised to satisfy themselves as to the working order and condition. Measurements: Great care is taken when measuring, but measurements should not be relied upon for ordering carpets, equipment, etc. This property sheet forms part of our database, and is protected by the database right and copyright laws. No unauthorised copying or distribution without permission.