



160 Highfield Road
Rushden, NN10 9QL



Simpson & Weekley

Notice Of Offer

Property Address: 160 Highfield Road, Rushden, NN10 9QL.

We advise that an offer has been made for the above property in the sum of £145,000. Any persons wishing to increase on this offer should notify the agents of their best offer prior to exchange of contracts.

Agents Address: Simpson and Weekley, 30 High Street, Rushden, NN10 0PW.

Agents Telephone Number: 01933 418917



£150,000

3 1 1



GROUND FLOOR
364 sq.ft. (33.8 sq.m.) approx.



1ST FLOOR
364 sq.ft. (33.8 sq.m.) approx.

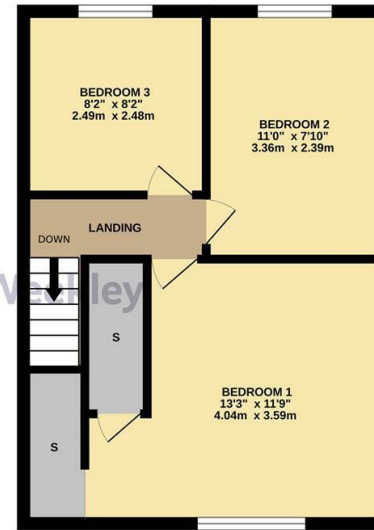

TOTAL FLOOR AREA : 728 sq.ft. (67.6 sq.m.) approx.
 Whilst every attempt has been made to ensure the accuracy of the floorplan contained here, measurements of doors, windows, rooms and any other items are approximate and no responsibility is taken for any error, omission or mis-statement. This plan is for illustrative purposes only and should be used as such by any prospective purchaser. The services, systems and appliances shown have not been tested and no guarantee as to their operability or efficiency can be given.
 Made with Metropix C2025

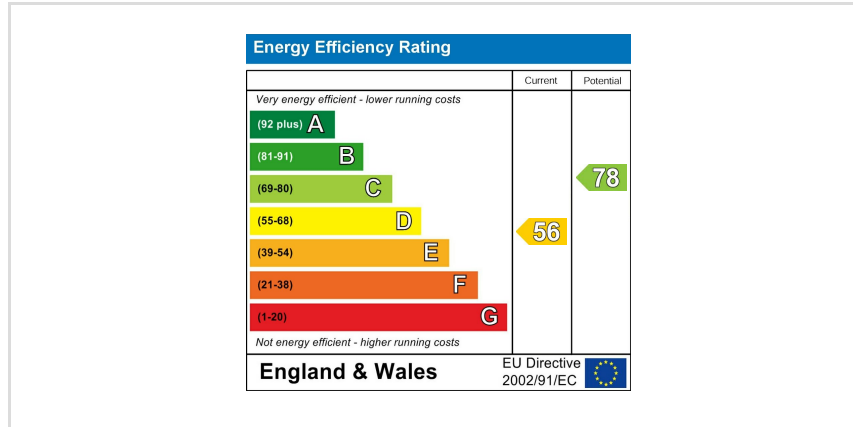

When you buy with Simpson and Weekley, you know **you'll be in safe hands**. From the moment you walk through our doors, we'll make you **feel truly welcome**. Our sales consultants and financial advisors will take you through **every step of the process**, offering **free expert advice** along the way, from help choosing the right mortgage and insurance through to finding your conveyancer. And if you need help selling your home too, **with over 20 years of local experience, you can trust us to get you moving**.



**Simpson
&Weekley**

Making Every
Journey Personal



01933 418917

rushden@simpsonandweekley.co.uk

<https://www.simpsonandweekley.co.uk/>

30 High Street, Rushden, Northants, NN10 0PW