



jordan fishwick

DIDSBURY
Lidgate Grove



Lidgate Grove, Didsbury, M20 6TS

Guide Price £495,000



The Property

A delightful Victorian terrace cottage enjoying a secluded and yet most convenient location which is just a short stroll from the centre of Didsbury Village, with numerous noteworthy features including extended living space and a superb south westerly facing patio & garden extending to approximately 100ft.

In outline:- Canopy porch, through lounge/dining room extending over 25ft with square bay window, extended breakfast kitchen with a comprehensive range of units and central island, two generous double bedrooms and the bathroom which extends over 14ft with a four-piece suite.

In addition, there is gas central heating (new boiler in 2024), double glazed windows and an enclosed flagged courtyard to the rear.

Directions

M20 6TS



- Delightful Victorian terrace
- Extended living space
- Superb garden around 100ft
- Ideal village location
- Lounge/dining room over 25ft
- Comprehensively fitted breakfast kitchen
- Two double bedrooms
- Bathroom over 14ft
- Double glazed windows
- Gas central heating (new boiler in 2024)

Postcode - M20 6TS

EPC Rating - D

Floor Area - 934.00 sq ft

Local Authority - Manchester City Council

Council Tax - D



GROUND FLOOR
525 sq.ft. (48.7 sq.m.) approx.

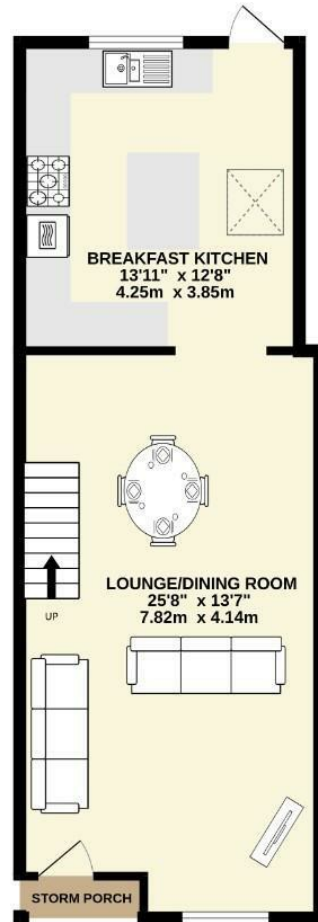

1ST FLOOR
409 sq.ft. (38.0 sq.m.) approx.

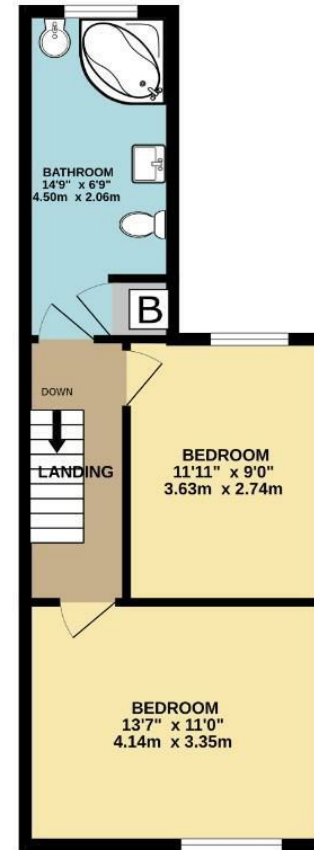

TOTAL FLOOR AREA: 934 sq.ft. (86.8 sq.m.) approx.
Measurements are approximate. Not to scale. Illustrative purposes only.
Made with Metropix ©2025



These particulars are believed to be accurate but they are not guaranteed and do not form a contract. Neither Jordan Fishwick nor the vendor or lessor accept any responsibility in respect of these particulars, which are not intended to be statements or representations of fact and any intending purchaser or lessee must satisfy himself by inspection or otherwise as to the correctness of each of the statements contained in these particulars. Any floorplans on this brochure are for illustrative purposes only and are not necessarily to scale.

Offices also at: Wilmslow, Macclesfield, Hale, Sale, Chorlton, Glossop, Manchester & Salford

757-759 Wilmslow Road, Didsbury Village, Manchester

0161 445 4480

didsbury@jordandfishwick.co.uk
www.jordandfishwick.co.uk