

7 Rutherford House,

Marple Lane, Chalfont St. Peter, Bucks., SL9 9FU

PRICE REDUCED

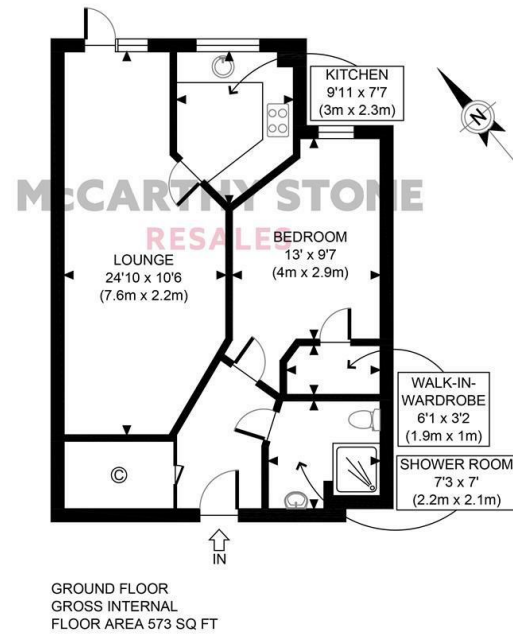

APPROX. GROSS INTERNAL FLOOR AREA 573 SQ FT / 53 SQM	Rutherford House
Disclaimer: Floor plan measurements are approximate and are for illustrative purposes only. While we do not doubt the floor plan accuracy and completeness, you or your advisors should conduct a careful, independent investigation of the property in respect of monetary valuation	date: 01/03/21
	photoplan



Council Tax Band: D

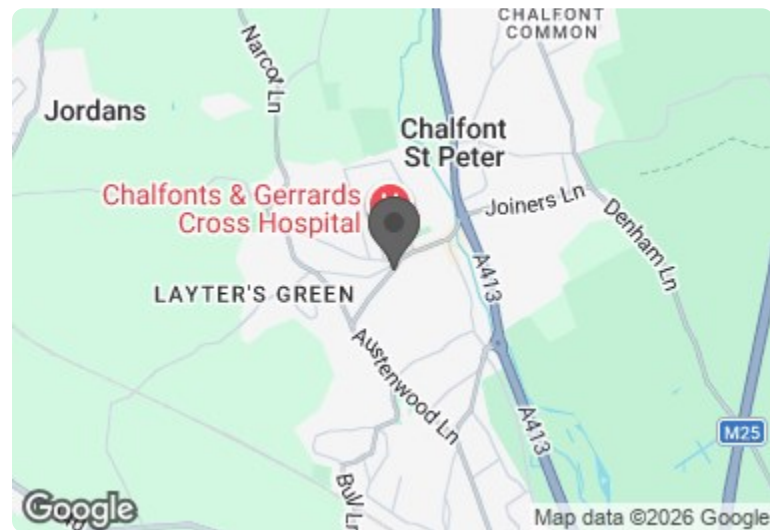

Energy Efficiency Rating		
	Current	Potential
Very energy efficient - lower running costs		
(92 plus) A		
(81-91) B	85	85
(69-80) C		
(55-68) D		
(39-54) E		
(21-38) F		
(1-20) G		
Not energy efficient - higher running costs		
England & Wales	EU Directive 2002/91/EC	



PRICE REDUCTION

Asking price £450,000 Leasehold

Come along to our Open Day - Tuesday 2nd June 2026 - from 11am to 3pm - BOOK YOUR PLACE TODAY!

Superb! This one bedroom ground floor apartment within Rutherford House benefits from having direct access from the living room onto a paved and covered spacious patio with plenty of room for garden furniture.

This apartment has its own allocated car parking space.

Entitlements Advice and Part Exchange available - speak to your Property Consultant for more information

Call us on 0345 556 4104 to find out more.

resales@mccarthyandstone.co.uk | mccarthyandstoneresales.co.uk

This floor plan is not drawn to scale and is for illustrative purposes only. Any measurements, floor areas (including any total floor area), openings and orientation are approximate and for guidance only. McCarthy Stone Resales do not take liability for any error, omission or misstatement. All parties must rely on their own inspections. It should not be assumed that any furniture or fittings contained in the photographs are included in any sale. All details referring to time and distances to localities are approximate. Details regarding any common charges and other applicable fees are provided by the seller and should not be relied on without verification and further checks made through a solicitor/conveyancer. Please contact the Property Consultant for further information that Appliances (including central heating) have not been tested, therefore it cannot be assumed that they are in good working order. All interested parties are advised to check availability and make an appointment before travelling to view the property to avoid disappointment or wasted time or travel expenses. The details contained within this brochure are for information purposes only and do not form part of any agreement. All purchases will be subject to contract terms. © All artwork (photos and floorplans) and written content are the sole property and copyright of McCarthy & Stone Resales Limited and are legally protected by UK & International copyright laws. Under no circumstance may you download, reproduce, publish or distribute any content for commercial purposes, without prior written permission from McCarthy Stone Resales.

McCarthy & Stone Resales Limited, Trading as McCarthy Stone Resales
Registered Office: 100 Holdenhurst Road, Bournemouth, Dorset, BH8 8AQ.
Registered in England and Wales No. 10716544



Marple Lane, Chalfont St. Peter, Gerrards

1 Bed | £450,000

PRICE
REDUCED

The Development

Rutherford House is a Retirement Living PLUS development, designed and constructed by McCarthy & Stone – the only housebuilder to win the Home Builders Federation 5-star award for 13 years running. Designed exclusively for the over 70s, this development comprises one and two bedroom apartments with numerous communal facilities such as a Club Lounge, a Well-being Suite and a bistro-style restaurant which serves freshly prepared meals daily. With flexible support packages that can be tailored to suit your needs and management on site 24 hours a day, Rutherford House has everything you need to relax and enjoy your retirement.

Location

Chalfont St Peter is a picturesque village with plenty to offer retirees both within the village and the surrounding area. Moreover, Rutherford House is conveniently located on Gold Hill East, close to the village centre, placing a variety of local amenities within easy walking distance. Goldhill Common, a stunning area of open green space and trees of some 33 acres, is literally opposite the entrance to the development – ideal for an early evening stroll or a summer picnic with the grandchildren. Market Place which leads onto Gold Hill East, less than 200 metres from Rutherford House, forms the village's main 'High Street'.

Entrance Hallway

Front door with letter box and spy hole opens into a spacious hallway. The security door entry system and 24-hour emergency response pull cord system is wall mounted in the hall. Smoke detector. Doors lead to the living room, double bedroom, shower room and to a large walk-in storage/airing cupboard.

Living Room with Covered Patio

A beautiful living room of excellent proportions, this delightful living room benefits from a glazed patio door with adjacent windows providing plenty of natural light and opens onto a covered and paved patio area with ample room for garden furniture. Raised electrical sockets, two ceiling light points. TV point with Sky+ connectivity. Telephone point. Part glazed door leads to the kitchen.

Kitchen

Modern fully fitted kitchen with a range of white high gloss wall and base units with Earth Stone style work surfaces. Double window with outlook over gardens. Integrated Neff appliances throughout including oven and microwave above. Four ringed ceramic hob with splashback and stainless steel extractor hood above. Integrated fridge/freezer. Stainless steel sink unit with separate drainer and mixer tap. Integrated dishwasher. Tiled floor.

Double Bedroom with walk-in wardrobe

A large double bedroom with a walk-in wardrobe offering plenty of storage space. Double glazed window. Central ceiling light. TV point. Telephone point. Raised electrical sockets.

Shower Room

An immaculate modern shower room featuring a level access walk in shower unit with fitted curtain and grab rails. Close coupled WC. Vanity unit storage cupboard with wash basin and illuminated mirror above. Emergency response pull cord. Heated towel rail.

Service Charge (Breakdown)

- Cleaning of communal windows
- Water rates for communal areas and apartments
- Electricity, heating, lighting and power to communal areas
- 24-hour emergency call system
- Upkeep of gardens and grounds
- Repairs and maintenance to the interior and exterior communal areas
- Contingency fund including internal and external redecoration of communal areas
- Buildings insurance

The service charge does not cover external costs such as your Council Tax, electricity or TV. To find out more about service charges please contact your Property Consultant or Estates Manager.

Annual Service charge: £13,972.74 for the financial year ending 31/03/2027.

Leasehold

Lease 999 years from January 2018
Ground rent: £435 per annum
Ground rent review date: January 2033

Car Parking

This apartment has its own allocated car parking space.

Moving Made Easy & Additional Information & Service

Moving is a huge step, but don't let that hold you back. We have a range of services to help your move go smoothly, including:

- FREE Entitlements Advice to help you find out what benefits you may be entitled to .
 - Part Exchange service to help you move without the hassle of having to sell your own home.
 - Removal Services that can help you declutter and move you in to your new home.
 - Conveyancing specialists who are experienced with sales and purchases of McCarthy Stone retirement properties.
- FOR MORE INFORMATION CHECK OUR WEBPAGE
ADDITIONAL SERVICES OR SPEAK WITH OUR PROPERTY CONSULTANT
- Full Fibre Broadband available
 - Mains water and electricity
 - Electric room heating
 - Mains drainage

This apartment features modern zone controlled underfloor heating and the Vent-Axia air circulation and heat extraction system.

