



Apartment (EPC Rating: D)

**11 KING STREET, WATFORD,
HERTFORDSHIRE, WD18 0BW**
PCM

£1,275 PCM



1 Bedroom Apartment located in Hertfordshire

ONE BEDROOM APARTMENT IN WATFORD TOWN CENTRE WITH ONE PARKING SPACE - AVAILABLE MAY 2026.

A spacious one bedroom apartment, ideally located in Watford town centre, within close proximity to excellent transport links and a wide range of local amenities.

The property offers a welcoming entrance hallway leading to a bright living room, a fitted kitchen, a generous double bedroom, and a bathroom. The apartment benefits from plenty of natural light throughout, creating a comfortable and inviting living space.

Perfectly positioned, the property is just 0.2 miles from Watford High Street Station and 0.6 miles from Watford Junction, making it ideal for commuters. You'll also find a great selection of shops, bars, restaurants, and leisure facilities just moments away. Vicarage Road Stadium and Watford General Hospital are both approximately 0.6-0.7 miles away, with the Metropolitan Line station located around 1.2 miles from the property.

Additional benefits include permit parking for one car.



WATFORD LETTINGS | 12 MARKET STREET, WATFORD, HERTFORDSHIRE, WD18 0PD

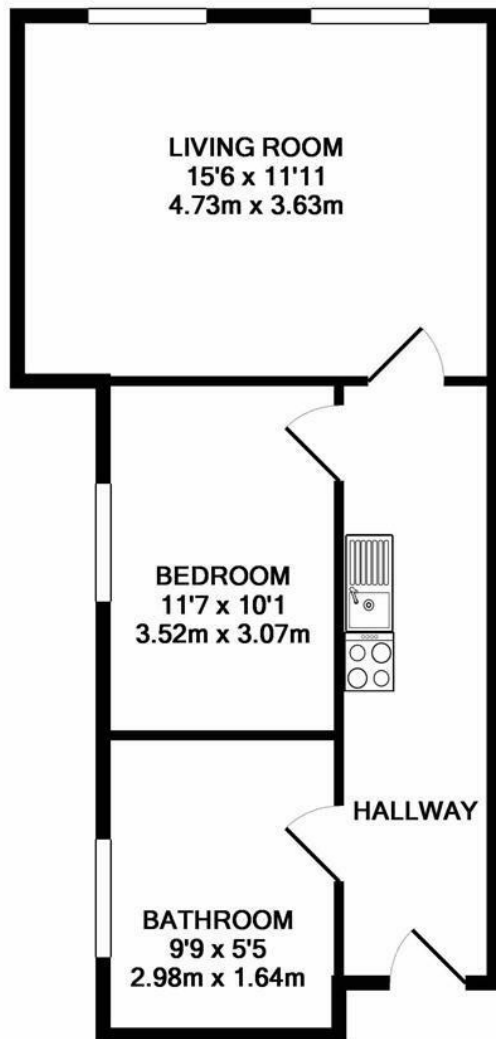

TOTAL APPROX. FLOOR AREA 448 SQ.FT. (41.6 SQ.M.)

Whilst every attempt has been made to ensure the accuracy of the floor plan contained here, measurements of doors, windows, rooms and any other items are approximate and no responsibility is taken for any error, omission, or mis-statement. This plan is for illustrative purposes only and should be used as such by any prospective purchaser. The services, systems and appliances shown have not been tested and no guarantee as to their operability or efficiency can be given

Made with Metropix ©2017

Council Tax Band

D

Energy Performance Graph

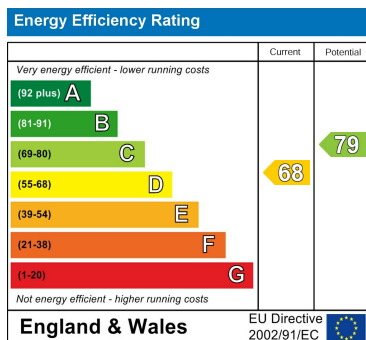

Call us on

01923 220 012

enquiries@warrenanthony.co.uk

www.warrenanthony.co.uk

Agents Note: Whilst every care has been taken to prepare these particulars, they are for guidance purposes only. All measurements are approximate and are for general guidance purposes only and whilst every care has been taken to ensure their accuracy, they should not be relied upon and potential buyers are advised to recheck the