



23 Matcham Grange, 42 Wetherby Road
Harrogate

Guide Price **£235,000**



MYRINGS



23 Matcham Grange

Harrogate

This beautifully presented first-floor one-bedroom retirement apartment offers comfortable and independent living within a highly regarded McCarthy Stone development for the over 70s. Situated in the sought-after town of Harrogate, the property forms part of a welcoming and well-maintained community, with on-site care and support services available if required.

Council Tax band: C

Tenure: Leasehold

- BRIGHT, SPACIOUS FIRST FLOOR RETIREMENT APARTMENT
- HOMEOWNERS LOUNGE, BISTRO AND COMMUNAL LANDSCAPED GARDENS
- 24-HOUR EMERGENCY CALL SYSTEM
- ON SITE CQC REGISTERED CARE TEAM AND BESPOKE CARE PACKAGES AVAILABLE



MYRINGS



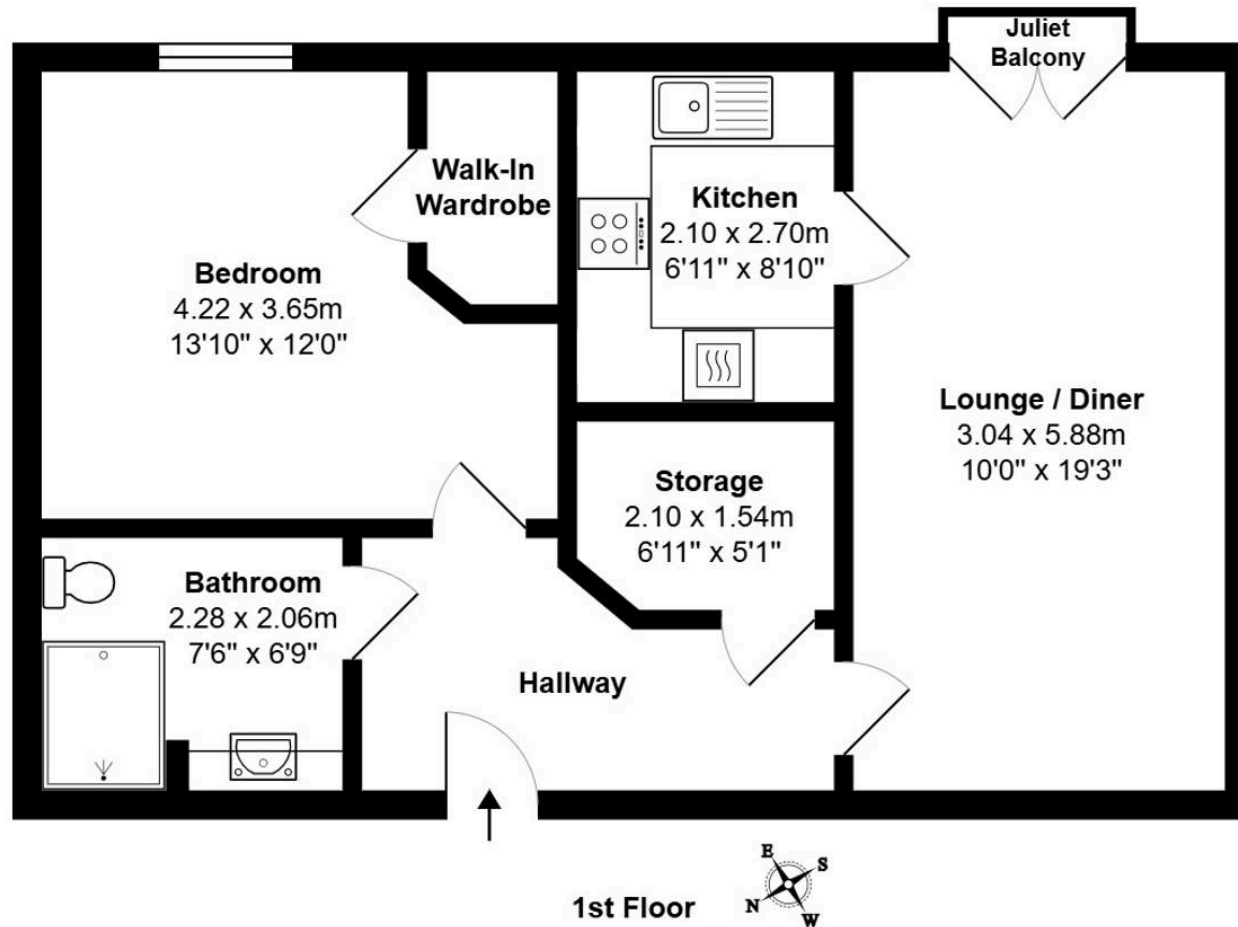

1st Floor

Total Area: 56.9 m² ... 613 ft² (excluding juliet balcony)

All measurements are approximate and for display purposes only.

