



**Sproughton Road, Ipswich, IP1 5AB**

**welcome to**

## **Sproughton Road, Ipswich**

This beautifully presented, mid-terraced home benefits from two bedrooms, a stylish ground floor bathroom, an open plan lounge/dining area and a COMPLETE ONWARD CHAIN!! This property would make an ideal First Time buy.

### **Lounge**

Open plan room with wood effect flooring, double glazed window to the front with fitted blind, fitted shelving, two storage cupboards, a gas fire, spotlights and TV point.

### **Dining Area**

Open plan to the lounge with wood effect flooring, an understairs storage, double glazed window to the rear with fitted blind and spotlights.

### **Kitchen**

Wood effect flooring, double glazed window to the side, a door to the side, eye and base level units in grey with grey marble effect worktop surfaces, a one and a half bowl sink plus drainer and chrome mixer tap, an integrated washing machine, dishwasher, fridge. freezer, bin store, electric oven and induction hob.

### **Ground Floor Bathroom**

Stylish bathroom with marble tiled effect flooring and walls, double glazed window to the side, chrome heated towel rail, enclosed WC, a vanity sink, a P bath with glass screen and overhead shower.

### **First Floor Landing**

Carpet flooring.

### **Master Bedroom**

Wood effect flooring, one radiator, double glazed window to the front and a built in, sliding, mirrored wardrobe.

### **Bedroom Two**

Carpet flooring, loft hatch, double glazed window to the rear and one radiator.

### **Outside:**

#### **Front Garden**

Steps up with a pathway to the front door, a brick wall border and a shingle area.

#### **Rear Garden**

A shared side access, a gate onto a patio seating area, a grassed area, a shed and a fully enclosed border.

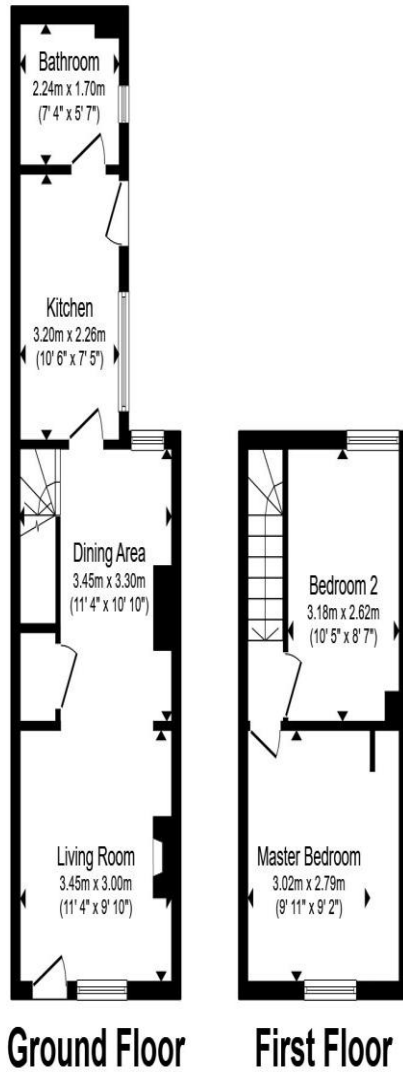

Total floor area 55.7 m<sup>2</sup> (600 sq.ft.) approx

This floor plan is for illustrative purposes only. It is not drawn to scale. Any measurements, floor areas (including any total floor area), openings and orientation are approximate. No details are guaranteed, they cannot be relied upon for any purpose and they do not form part of any agreement. No liability is taken for any error, omission or misstatement. A party must rely upon its own inspection(s). Powered by [www.propertybox.io](http://www.propertybox.io)



**welcome to**  
**Sproughton Road,**  
**Ipswich**

- Complete onward chain
- Two bedrooms
- Open plan lounge-dining area
- Ground floor bathroom
- Ideal First Time buy

Tenure: Freehold EPC Rating: D  
Council Tax Band: A

offers in excess of  
**£160,000**



**view this property online** [williamhbrown.co.uk/Property/IPS121538](http://williamhbrown.co.uk/Property/IPS121538)



Property Ref:  
IPS121538 - 0002

1. MONEY LAUNDERING REGULATIONS Intending purchasers will be asked to produce identification documentation at a later stage and we would ask for your co-operation in order that there is no delay in agreeing the sale. 2. These particulars do not constitute part or all of an offer or contract. 3. The measurements indicated are supplied for guidance only and as such must be considered incorrect. Potential buyers are advised to recheck measurements before committing to any expense. 4. We have not tested any apparatus, equipment, fixtures or services and it is in the buyers interest to check the working condition of any appliances. 5. Where an EPC, or a Home Report (Scotland only) is held for this property, it is available for inspection at the branch by appointment. If you require a printed version of a Home Report, you will need to pay a reasonable production charge reflecting printing and other costs. 6. We are not able to offer an opinion either written or verbal on the content of these reports and this must be obtained from your legal representative. 7. Whilst we take care in preparing these reports, a buyer should ensure that his/her legal representative confirms as soon as possible all matters relating to title including the extent and boundaries of the property and other important matters before exchange of contracts.

William H Brown is a trading name of Sequence (UK) Limited which is registered in England and Wales under company number 4268443, Registered Office is Cumbria House, 16-20 Hockliffe Street, Leighton Buzzard, Bedfordshire, LU7 1GN. VAT Registration Number is 500 2481 05.



**william h brown**



**01473 226101**



[ipswich@williamhbrown.co.uk](mailto:ipswich@williamhbrown.co.uk)



16-18 Wolsey House, Princes Street, IPSWICH,  
Suffolk, IP1 1QT



**[williamhbrown.co.uk](http://williamhbrown.co.uk)**