



**GASCOIGNE
HALMAN**

Somerton Avenue, Sale
£485,000

THE AREA'S LEADING ESTATE AGENCY



A beautifully presented three bedroom semi-detached property, ideal for the growing family looking to be within convenient reach of renowned local schools such as Sale Grammar, and other useful amenities. With driveway parking, two useful garages and a spacious South facing rear garden, this property is situated in a highly sought after location close to Sale Moor Village.

Property details

- Three Bedrooms
- Close to Sale Moor Village and Sale Grammar School
- Beautifully Presented Throughout
- Spacious South Facing Rear Garden plus Two Garages
- Living/Dining Room and Separate Kitchen
- Cul-De-Sac Location



About this property

On entry through the porch, there is a good-sized hallway giving access to the ground floor. Leading off from the hallway is the through lounge/diner, separated by sliding doors. The lounge area features an original fireplace and French double doors leading out into the rear garden. The hallway leads through into the kitchen, which benefits from integrated appliances and understairs storage. It also gives access into the garden.

To the first floor you will find two large double bedrooms and a third well-proportioned single bedroom. The master bedroom boasts large fitted wardrobes, while the third bedroom has the added benefit of fitted storage space. Completing the first floor is the spacious, modern family bathroom which includes a four-piece suite and quality tiling.

Externally the property boasts a good sized driveway and garage to provide off-road parking to multiple vehicles plus a side gate providing access to the rear garden. To the rear of the property, there is a beautiful garden, mainly laid to lawn with fenced and hedged borders, plus a patio area ideal for outdoor dining. There is also a second detached garage in the garden.



GASCOIGNE HALMAN

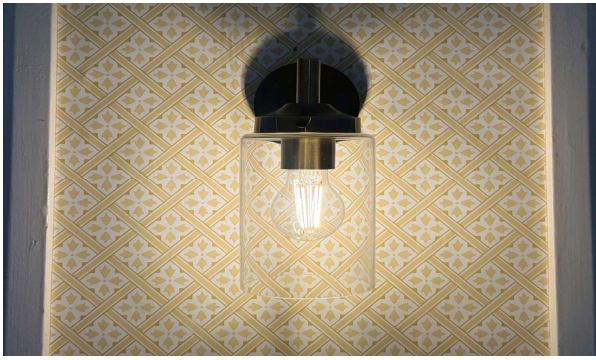

GASCOIGNE HALMAN



GASCOIGNE HALMAN



GASCOIGNE HALMAN



GASCOIGNE HALMAN





GASCOIGNE HALMAN

DIRECTIONS

M33 3FL

COUNCIL TAX BAND

C

TENURE

Freehold

SERVICES (NOT TESTED)

Services have not been tested and you are advised to make your own enquiries and/or inspections.

LOCAL AUTHORITY

Trafford B C

VIEWING

Viewing strictly by appointment.

EFFICIENCY RATING

Score	Energy rating	Current	Potential
92+	A		
81-91	B		83 B
69-80	C		
55-68	D	68 D	
39-54	E		
21-38	F		
1-20	G		

PRIMARY SOURCE OF HEATING

Gas fired hot water radiators

PRIMARY ARRANGEMENT FOR SEWERAGE

Mains Supply

PRIMARY SOURCE OF ELECTRICITY

Mains Supply

PRIMARY SOURCE OF WATER

Mains Supply

BROADBAND CONNECTION

Fibre to the premises

ANY EASEMENTS, SERVITUDES OR WAYLEAVES?

No

ARE THERE ANY RESTRICTIONS ASSOCIATED WITH THE PROPERTY

No

THE EXISTENCE OF ANY PUBLIC OR PRIVATE RIGHT OF WAY?

No

SOURCES OF FLOODING

None

HAS PROPERTY BEEN FLOODED IN 5 YEARS

No

NOTICE Gascoigne Halman for themselves and for the vendors or lessors of this property whose agents they are give notice that: (i) the particulars are set out as a general outline only for the guidance of intending purchasers or lessees, and do not constitute, nor constitute part of, an offer or contract; (ii) all descriptions, dimensions, references to condition and necessary permissions for use and occupation, and other details are given in good faith and are believed to be correct but any intending purchasers or tenants should not rely on them as statements or representations of fact but must satisfy themselves by inspection or otherwise as to the correctness of each of them; (iii) no person in the employment of Gascoigne Halman has any authority to make or give any representation or warranty whatever in relation to this property.

GARAGE
141 sq.ft. (13.1 sq.m.) approx.

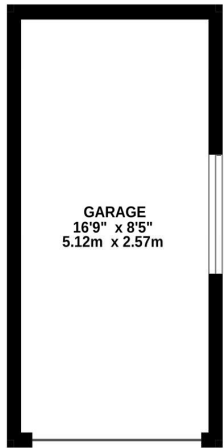

GROUND FLOOR
593 sq.ft. (55.1 sq.m.) approx.

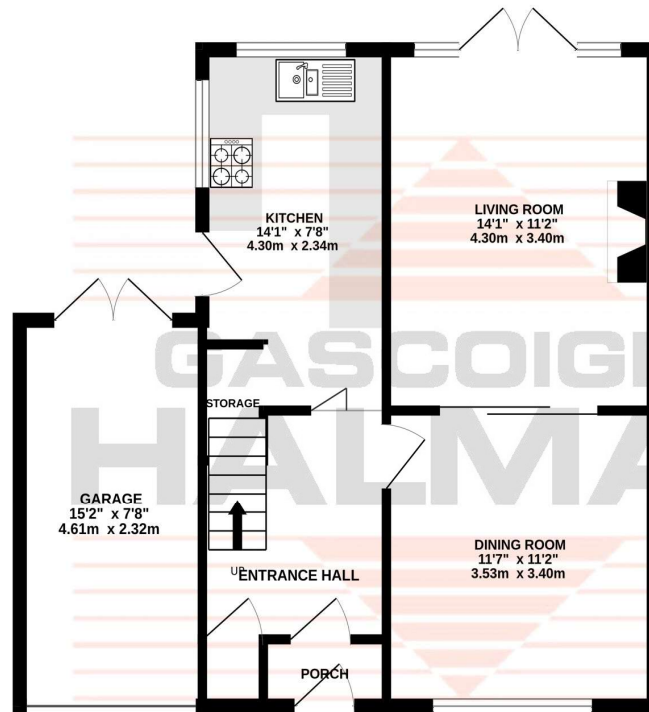

1ST FLOOR
485 sq.ft. (45.0 sq.m.) approx.

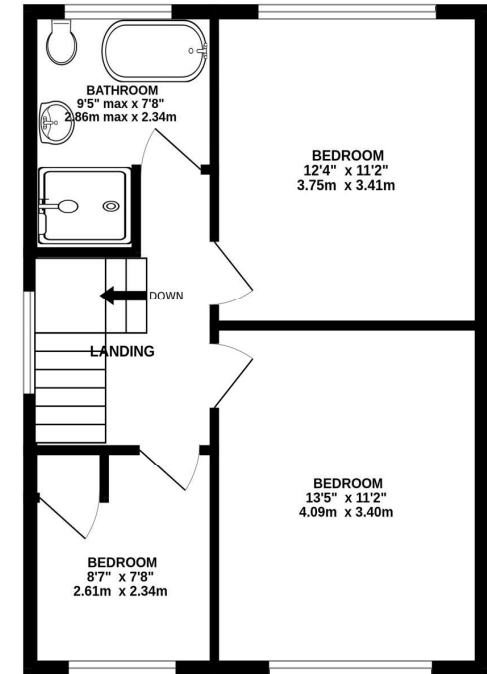

TOTAL FLOOR AREA : 1229sq.ft. (114.2 sq.m.) approx.

Whilst every attempt has been made to ensure the accuracy of the floorplan contained here, measurements of doors, windows, rooms and any other items are approximate and no responsibility is taken for any error, omission or mis-statement. This plan is for illustrative purposes only and should be used as such by any prospective purchaser. The services, systems and appliances shown have not been tested and no guarantee as to their operability or efficiency can be given.

Made with Metropix ©2025



THE AREA'S LEADING ESTATE AGENCY

0161 962 8700 sale@gascoignehalman.co.uk
96 School Road, Sale, Cheshire, M33 7XB