



**POOLE
TOWNSEND**

Birchwood Drive, Ulverston

£220,000

3 1 1



- Semi Detached Bungalow
- Walk In Ready Home
- Close To Local Amenities And Transport Links
- Freehold
- Drive And Separate Single Garage
- 3 Double Bedrooms
- Sought After Location
- No Upper Chain
- Private Rear Garden
- Council Tax Band C



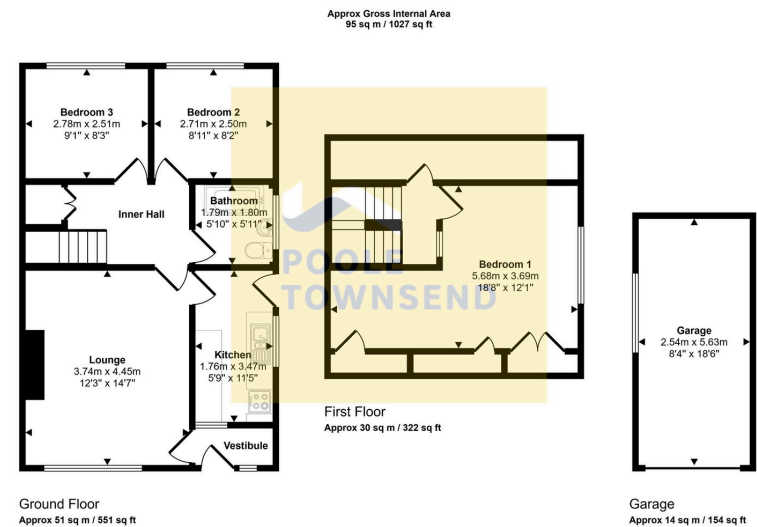

This floorplan is only for illustrative purposes and is not to scale. Measurements of rooms, doors, windows, and any items are approximate and no responsibility is taken for any error, omission or mis-statement. Icons of items such as bathroom suites are representations only and may not look like the real items. Made with Made Snazzy 360.

A charming semi-detached home in the ever-popular Croftlands area, conveniently located near bus routes, schools, shops, a community centre, and a children's play area. Set behind an enclosed front garden with lawn and mature shrubs, the property features a bright lounge, a kitchen with wood-effect cabinets, and two ground-floor bedrooms with a family bathroom. Upstairs, the principal bedroom offers built-in cupboards and access to loft/eaves storage. Outside, a driveway leads to a large detached garage and additional garden with lawn and colourful planting. With generous outdoor space, practical living areas, and being sold with no upper chain, this property is ideal for families or first-time buyers seeking a move-in-ready home in a sought-after location.

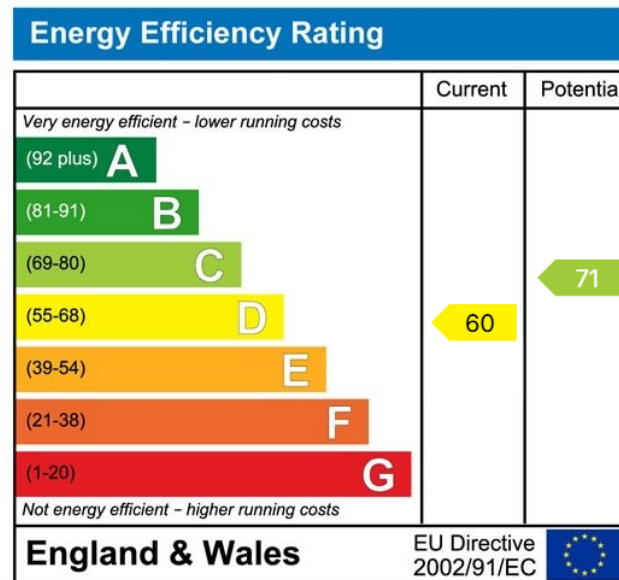

Visit us at
www.pooletownsend.co.uk
enquiries@pooletownsend.co.uk

We are open
 Monday – Friday 9.00 – 5.00
 Saturday 9.00 – 1.00

Barrow 01229 811811
 Ulverston 01229 588111
 Grange 015395 33316
 Kendal 01539 734455
 Milnthorpe 015395 62044