



Staplehurst Road, SE13

£240,000

A beautifully finished one double bedroom conversion flat, positioned just moments from Hither Green Station, offering turn-key living in a highly sought-after location. This stylish home has been thoughtfully refurbished to a high standard throughout and offers a bright, well-proportioned reception room, a modern fitted kitchen, a spacious double bedroom, and a contemporary bathroom. The finish is immaculate, making it ideal for buyers looking for a home they can move straight into without any work required. This property would make an ideal first-time purchase or long-term investment.

Staplehurst Road is perfectly located just one minute from Hither Green Station, providing fast and frequent services into London Bridge, Cannon Street, and Charing Cross. The independent cafés, restaurants, and everyday amenities of Hither Green Lane are all within easy reach, along with the green open spaces of Manor House Gardens and Mountsfield Park.

Features

- Refurbished
- Great Location
- Long Lease
- Close To Local Amenities
- Double Bedroom
- Bright Reception Room

Staplehurst Road,
LONDON, SE13

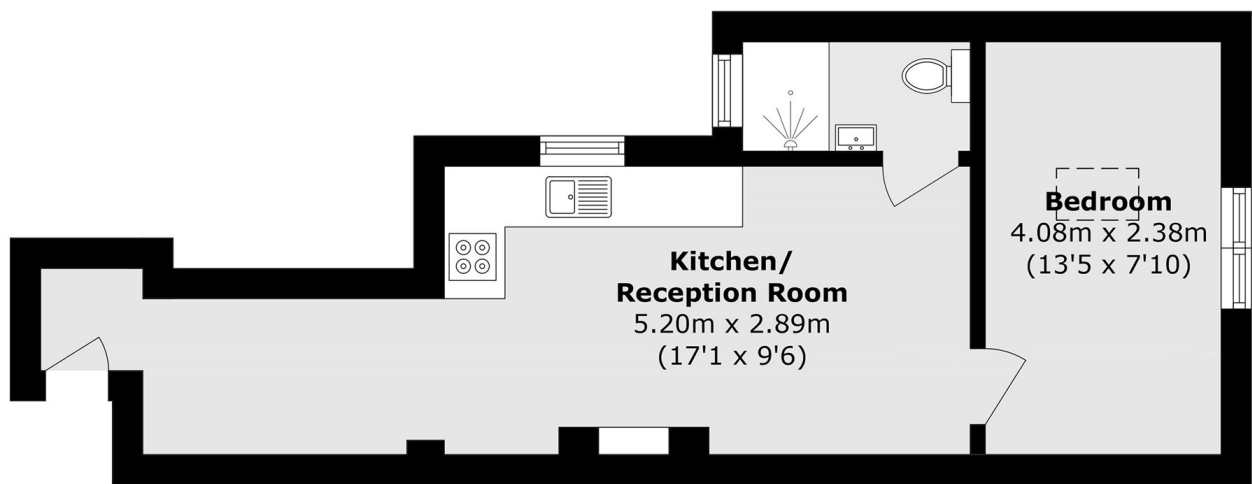

Total area (approx.): 33.4 sq. m (359.5 sq. ft)

Dexters

Lee
430-432 Lee High Road
Lee
London
Sales
020 8815 2210

Energy Rating: C. We aim to make our particulars both accurate and reliable. However they are not guaranteed; nor do they form part of an offer or contract. If you require clarification on any points then please contact us, especially if you're traveling some distance to view. Please note that appliances and heating systems have not been tested and therefore no warranties can be given as to their good working order.

 **RICS** | Regulated
Estate Agent
and Letting Agent

dexters.co.uk