



TRINITY GARDENS, SW9

£525,000

- Bright living room
- Two double bedrooms
- Modern kitchen
- Popular location
- Good transport links
- Energy rating: C





## ABOUT THE HOME

A spacious two double bedroom flat moments from Brixton which offers excellent proximity to the green open spaces of Brockwell Park and Clapham Common. In good decorative order throughout, this would make an ideal first time purchase

Trinity Gardens is a sought after location within walking distance of Brixton's high street shops, cafés, bars and leisure amenities, its vibrant market and independent retailers. Transport links include Brixton (Victoria line) Underground and Mainline stations (0.3 mile), along with numerous bus routes serving the City and West End.





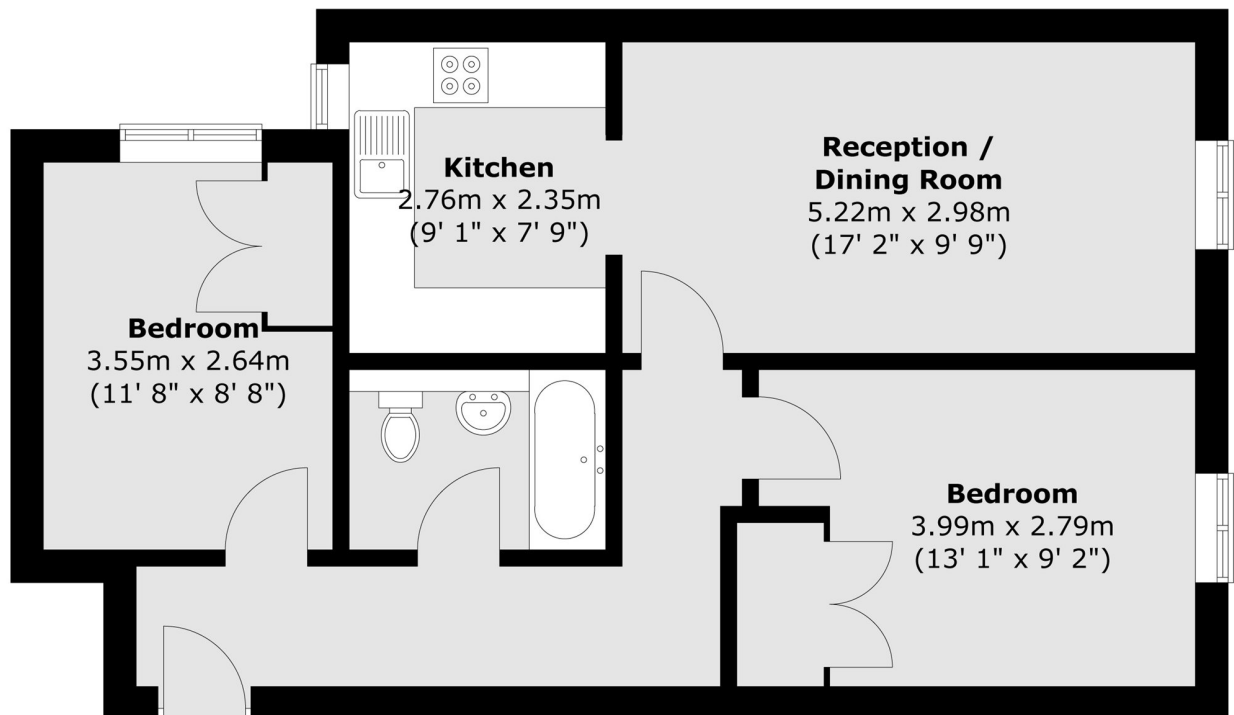

Total area (approx.) : 58.3 sq. m (627 sq. ft)

#### JACKSONS CLAPHAM

73 Abbeville Road, London,  
SW4 9JN  
Sales: 020 8487 3177  
Lettings: 020 8487 3178

Energy Rating: C We aim to make our particulars both accurate and reliable. However they are not guaranteed; nor do they form part of an offer or contract. If you require clarification on any points then please contact us, especially if you're traveling some distance to view. Please note that appliances and heating systems have not been tested and therefore no warranties can be given as to their good working order.