

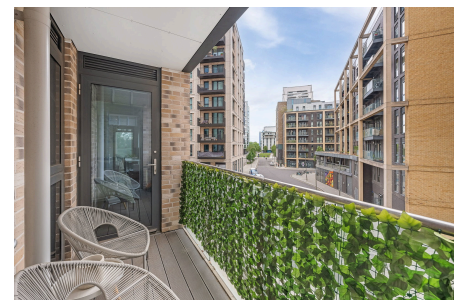

Osiers Road, Wandsworth, SW18

Guide Price £500,000 - £595,000

2 2 1



PLEASE SELECT 1 FOR GEORGE WHEN CALLING - GUIDE PRICE £500K - £595K – Stunning two double bedroom second floor apartment (751 Sq.Ft) with two private balconies, off street parking, and access to landscaped communal gardens, superbly located in the Riverside Quarter between Putney and Wandsworth Town. With the River Thames and Wandsworth Park literally on the doorstep, this fabulous property offers bright, well planned accommodation with stylish interiors and contemporary finish throughout. Features include a generous open plan dual aspect reception/kitchen, modern bathroom, gas central heating, double glazing, high ceilings and wood effect flooring.

Jonathan Woods
jonathanwoods.exp.uk.com
jw@jonathanwoodsrealestate.com
07498 214 463



Key Features

- PLEASE SELECT ONE FOR GEORGE
- POPULAR MODERN DEVELOPMENT
- CONTEMPORARY FINISH
- 2 BALCONIES
- MOMENTS FROM WANDSWORTH TOWN AND EAST PUTNEY STATIONS
- STUNNING 2 BED, 2 BATH, 2ND FLOOR APARTMENT
- SOUGHT AFTER RIVERSIDE QUARTER LOCATION
- LIGHT AND SPACIOUS OPEN PLAN RECEPTION/KITCHEN
- OFF STREET PARKING AND LANDSCAPED COMMUNAL GARDENS
- CLOSE TO SHOPS, BARS AND RESTAURANTS

Osiers Road

Approximate Gross Internal Area = 69.8 sq m / 751 sq ft
Including Limited Use Area (0.9 sq m / 10 sq ft)

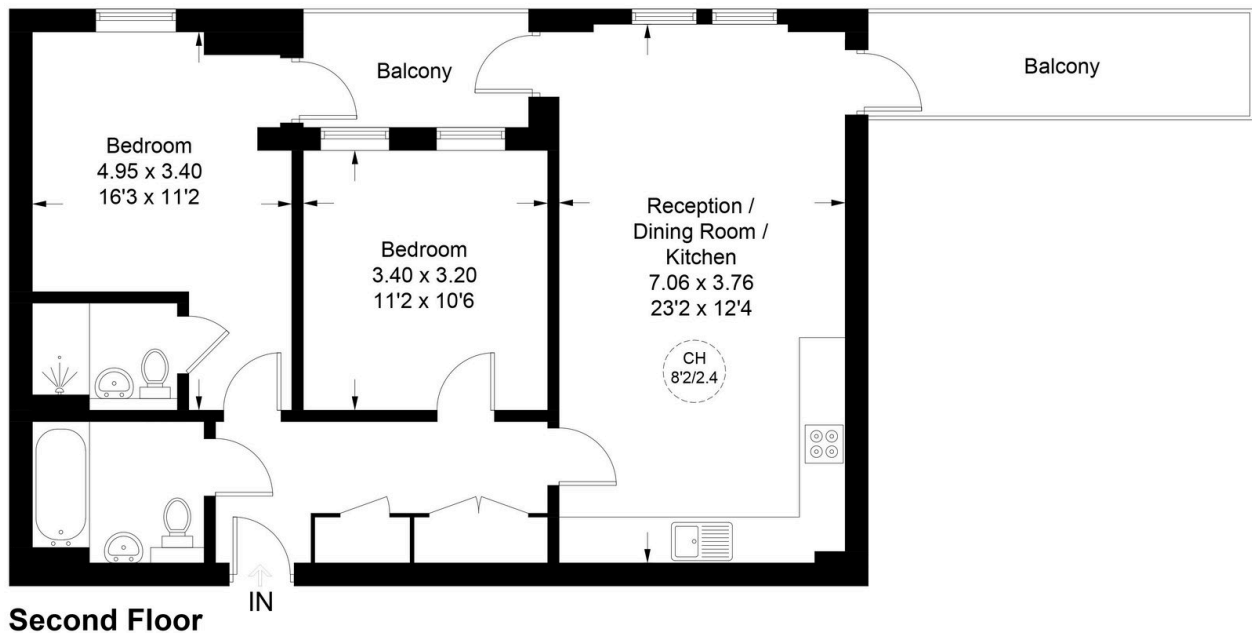

Illustration for identification purposes only, not for valuation purposes, measurements are approximate, not to scale. IPMS2

Jonathan Woods

jonathanwoods.exp.uk.com

jw@jonathanwoodsrealestate.com

07498 214 463