



## Oaken Wood Drive, Maidstone, ME16 9FE

- Double fronted, 3 Bedroom End of Terrace Family Home
- Generous principal bedroom with en-suite shower room
- Low maintenance rear garden with out-building
- Neutral in décor throughout - Ready to move into
- Located in the Barming area of Maidstone

- Spacious open plan living, ideal for growing family
- Allocated parking with charging port for EV Vehicle
- Modern family bathroom servicing bedroom three
- EPC Rating: B (88) - Council Tax Band: E
- Walking distance to Maidstone Hospital

**Asking Price £415,000**

# Oaken Wood Drive, Maidstone, ME16 9FE



## Modern 3-Bed End Terrace with EV Charger, Parking & Garden - Barming Maidstone

This stylish 3- bedroom end terrace offers a modern open-plan kitchen/dining area, spacious living room, two bathrooms, private parking and a landscaped garden. Perfect for families or hospital staff commuting to Maidstone Hospital. This energy-efficient home features an EPC rating of a B and an EV charging point, combining contemporary comfort with practical living.

As you enter, you are greeted by a spacious reception room that provides a warm and inviting atmosphere. The open-plan kitchen and dining area is a standout feature, designed for both functionality and style. This space is perfect for entertaining guests or enjoying family meals, with ample room for dining furniture.



The property boasts three well-proportioned bedrooms, including a master suite complete with an en-suite bathroom for added privacy and convenience. The additional two bedrooms are versatile and can be used as guest rooms, children's rooms, or even a home office. A downstairs WC adds to the practicality of the home, ensuring that guests and family members have easy access to facilities.

Outside, the property benefits from allocated parking, which includes a charging port for electric vehicles, catering to modern needs and sustainability. The surrounding area is peaceful and family-friendly, with local amenities and green spaces nearby, making it a wonderful place to call home.



In summary, this delightful end-terrace house on Oaken Wood Drive offers modern living in a convenient location, with spacious interiors and practical features that cater to today's lifestyle. Don't miss the opportunity to make this lovely property your own.

Flood Risk: Very low Each year, there is a chance of flooding of less than 1 in 1000 (0.1%)

Services: Gas fired central heating, mains drainage and mains electricity.

Average Broadband Speed: Superfast 76mb Ultrafast 1000mb



# Oaken Wood Drive, Maidstone, ME16 9FE



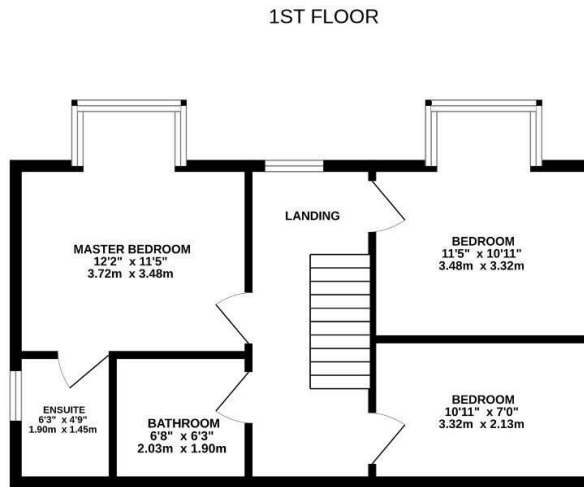
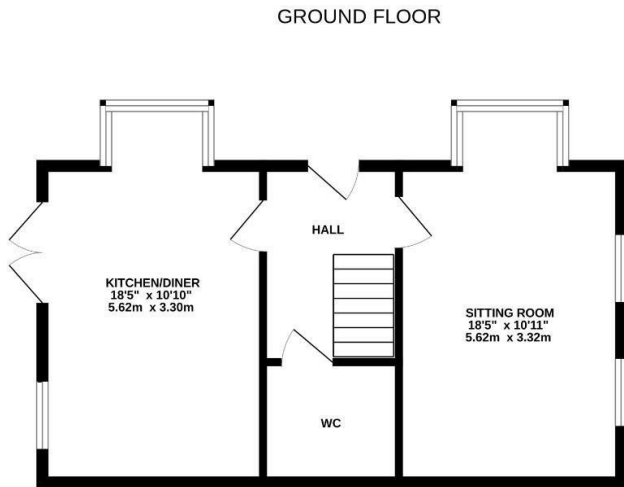

Whilst every attempt has been made to ensure the accuracy of the floorplan contained here, measurements of doors, windows, rooms and any other items are approximate and no responsibility is taken for any error, omission or mis-statement. This plan is for illustrative purposes only and should be used as such by any prospective purchaser. The services, systems and appliances shown have not been tested and no guarantee as to their operability or efficiency can be given.  
Made with Metropix ©2026

### Viewings

Please contact [Maidstone@hunters.com](mailto:Maidstone@hunters.com), if you wish to arrange a viewing appointment for this property or require further information.

### Valuations

For a valuation of your property, please email the team with your property details, contact information and the times you are available.

## ENERGY PERFORMANCE CERTIFICATE

The energy efficiency rating is a measure of the overall efficacy of a home. The higher the rating the more energy efficient the home is and the lower the fuel bills will be.

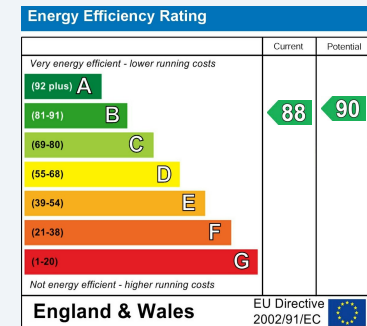

These particulars are intended to give a fair and reliable description of the property but no responsibility for any inaccuracy or error can be accepted and do not constitute an offer or contract. We have not tested any services or appliances (including central heating if fitted) referred to in these particulars and the purchasers are advised to satisfy themselves as to the working order and condition. If a property is unoccupied at any time there may be reconnection charges for any switched off/disconnected or drained services or appliances - All measurements are approximate.

**THINKING OF SELLING?** If you are thinking of selling your home or just curious to discover the value of your property, Hunters would be pleased to provide free, no obligation sales and marketing advice. Even if your home is outside the area covered by our local offices we can arrange a Market Appraisal through our national network of Hunters estate agents.



65 High Street, Maidstone, ME14 1SR  
Tel: 01622 278003 Email: [Maidstone@hunters.com](mailto:Maidstone@hunters.com) <https://www.hunters.com>

