

Agents Note: Whilst every care has been taken to prepare these sales particulars, they are for guidance purposes only. All measurements are approximate and whilst every care has been taken to ensure their accuracy, they should not be relied upon and potential buyers are advised to check the measurements

The floor plan is provided in good faith and believed to be accurate, but location and sizes of rooms, doors and windows are provided for guidance only and such should not be relied upon. Any aspect of the plan is important to you, please contact our office. Made with Metropix

Ground Floor

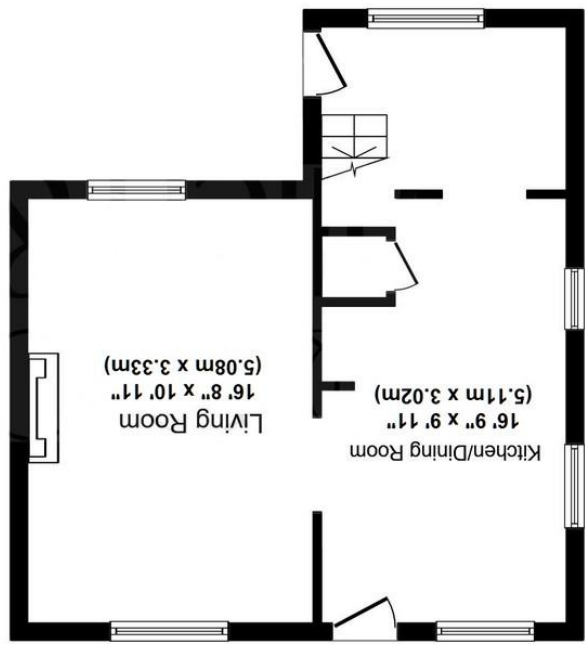

First Floor

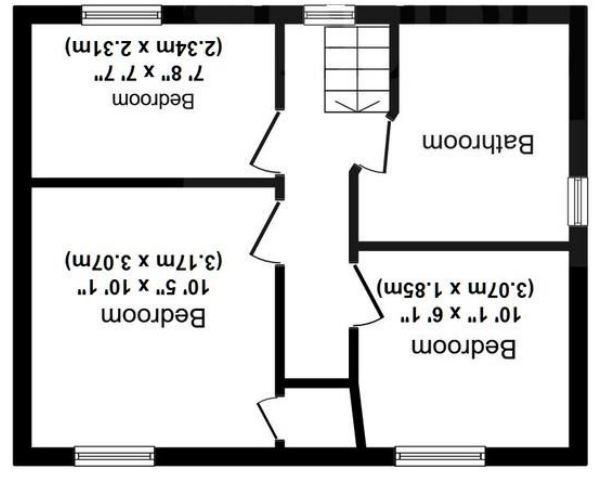

46 Potley Lane, Corsham, SN13 9RX

David Ingram  
RESIDENTIAL

# 46 Potley Lane, Corsham, SN13 9RX

£190,000

NO ONWARD CHAIN - Situated on the outskirts of Corsham this house is offered unfurnished with accommodation comprising of a large entrance area, spacious kitchen/diner, living room, bathroom with shower over the bath, master bedroom, a further double bedroom and a single bedroom. Outside there is a small front garden, enclosed rear garden and some external storage.

The property is within walking distance of Corsham's picturesque and historic high street, which offers an eclectic range of independent shops, restaurants, and public houses. A supermarket and doctors surgery are also close by, and the Pound Arts Centre provides Corsham's cultural hub, whilst the Springfield Campus offers a library, café and a wide range of sporting activities with gym facilities and swimming pool. Corsham has a number of highly regarded schools, with higher education offered by Bath College, Wiltshire College, and universities in Bath and Bristol.

More comprehensive facilities can be found at Chippenham c.5 miles and the World Heritage City of Bath c.8 miles. Both offer a high speed rail service to London, Paddington and the M4 motorway junctions 17 & 18 for London and Bristol are within easy access.

